

# STRIX Sound Card Series

Strix Raid DLX  
 Strix Raid PRO  
 Strix Soar

## Quick Start Guide

## Safety Information

- Read these instructions.
- Keep these instructions.
- Heed all warnings.
- Follow all instructions.
- Do not use this apparatus near water.
- Clean machine surface with a cloth (Do not apply any detergent or cleaning fluid).
- Do not block any ventilation openings. Install in accordance with the manufacturer's instructions.
- Do not install near any heat sources such as radiators, heat registers, stoves or other apparatus (including amplifiers) that produce heat.
- The polarized or grounding type plug is for user safety. A polarized plug has two blades with one wider than the other. A grounding -type plug has two blades and a third grounding prong. The wide blade or the third prong is provided for your safety. If the provided plug does not fit into your outlet, consult your electrician for installation of the appropriate type of power socket.
- Protect the power cord from being stepped on or compressed, particularly at the point where the cable is connected to the device.
- Only use attachments/accessories specified by the manufacturer.
- Use with only the cart, stand, tripod, bracket or table recommended by the manufacturer, or sold with the product. When a cart is used, use caution when moving the cart or trolley to avoid injury.
- Unplug the device during lightning storms or when left unused for long periods of time.
- Refer all repairs to qualified service personnel. Servicing is required when the product has been damaged in any way such as when the power cord or plug is damaged, liquid has been spilled or an object have fallen into the product, the product has been exposed to rain or moisture or does not operate normally or has been dropped.



### Additional Safety Information

For your own safety please read the following important instructions carefully before attempting to connect this unit to the main power supply. The instructions provided will help you get the best performance from this device and prolong the life of this product.

### Repairs

Do not attempt to repair or disassemble this product. Consult a qualified technician or professional for service or repairs.

## Package Contents

This package should contain the following:

- STRIX sound card series 7.1-Channel sound card
- S/PDIF TOSLINK optical adapter x 1
- Quick Start Guide
- Box link cable (Strix Raid DLX/Strix Raid Pro only)
- Strix control box (Strix Raid DLX/Strix Raid Pro only)

## System Requirements

To ensure a successful installation of the ASUS Strix sound card series, your computer must meet the following requirements:

- One PCI Express 1.0 (or higher) compatible slot for the audio card
- One available 6-pin peripheral power cable connector from PC's power supply unit
- Microsoft® Windows® 10/8.1/7 (32/64bit)
- Intel® Pentium® 4 1.4GHz or AMD Athlon 1400 CPU or faster CPU
- > 256 MB DRAM system memory
- > 60 MB available HDD space for driver installation package
- High-quality headphones, powered analog speakers, to enjoy the ultra-high fidelity sounds.

## Hardware Features

### Audio card

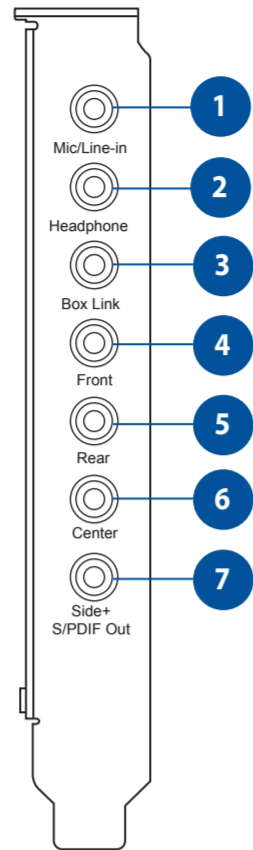

### Control Box

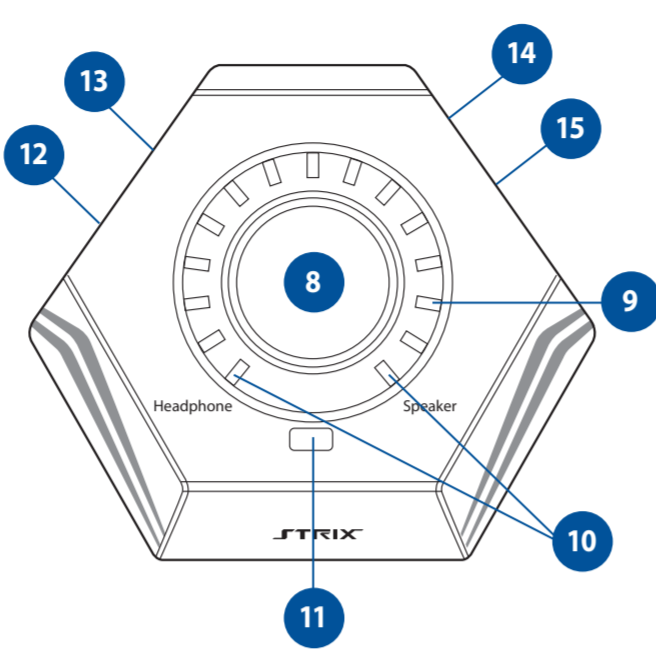

- Microphone In port**  
Connect your external PC microphone to this 3.5mm port for voice input. Built-in high-quality Microphone pre-amplifier.

#### Line In port

Connect analog devices like MP3 players, CD players, music synthesizers, and other line-level sound sources to this 3.5mm port for audio recording or processing.

- Headphone Out port**

Connect your headphone to this port.

- Box link**

Connect Strix control box directly to this port

- Front Out port**

For 2 channel speaker systems, connects to the input on the powered speakers.

- Rear Out port**

Connect to the rear surround input on 4 powered analog speakers.

- Center Out port**

Connects to the center/subwoofer input on 4/5.1 powered analog speakers.

- Side Out port**

Connects to the side surround input on 7.1 powered analog speakers.

#### S/PDIF Out port

Optical digital output jack. Connects to external digital decoder or digital speaker systems, Home Theater systems, AV receivers for outputting digital audio including PCM, Dolby Digital, DTS, WMA-Pro, etc. Connect to the surround channel input on 4/5.1/7.1 powered analog speakers

- Output Select / Volume Control**

Output Select / Volume Control	Description
Tab	Tab to select output source between headphone and speaker.
Long Press	Long press to set selected output source to mute.
Turn	Turn knob clockwise or anti-clockwise to adjust volume level.
[Custom Mode]: Tab	<b>CUSTOM MODE (In conjunction with STRIX RAID MODE)</b> Tab knob to turn on/off a selected effect.
	<b>Note:</b> This control knob is used in conjunction with the Strix RAID key. When Strix RAID Mode is selected, this goes into a custom mode.
[Custom Mode]: Turn	<b>CUSTOM MODE (In conjunction with STRIX RAID MODE)</b>
	Turn knob clockwise or anti-clockwise to adjust intensity level of a selected effect.

- LED Indicators**

LED indicator that displays intensity level of volume or effects.

- Output Source LED Indicator**

LED indicator that displays selected output device.

Note: When the device is under mute, the LED turns red..

- STRIX RAID Mode**

	This is a programmable key that can customize and lock a special effect from the Sonic Studio so that you can control and adjust effects spontaneously in game.
	Press on/off to enter/exit Custom Mode. The LED turns Orange to indicate the Custom Mode.
STRIX RAID Mode	To set up this key, please go to the Sonic Studio and select desired effect to lock to the Strix RAID Mode.
	Now you can use the turn knob to turn on/off effects, as well as adjust the intensity level of the effect.

- Headphone Output Port**

Connect your headphones to this port.

- Microphone Input Port**

Connect your external PC microphone to this 3.5mm jack for voice input.

- Kensington® Security Slot**

Insert Kensington lock to lock the device.

- Box link**

Connect Strix control box directly to this port

### 繁體中文

- 麥克風輸入連接埠  
Line In 連接埠
- 耳機輸出連接埠
- Box link
- 前置喇叭輸出連接埠
- 後置喇叭輸出連接埠
- 中央喇叭輸出連接埠
- 側邊喇叭輸出連接埠  
S/PDIF 輸出連接埠
- 輸出選擇 / 音量調節
- LED 指示燈
- 輸出源 LED 指示燈
- STRIX RAID Mode
- 耳機輸出連接埠
- 麥克風輸入連接埠
- Kensington® 安全插槽
- Box link

### Italiano

- Porta ingresso microfono  
Porta line in
- Porta uscita cuffie
- Collegamento Box
- Uscita altoparlanti anteriori
- Uscita altoparlanti posteriori
- Uscita altoparlante centrale
- Uscita altoparlanti laterali  
Porta uscita S/PDIF
- Selezione uscita/Controllo volume
- Indicatori LED
- Indicatore LED sorgente uscita
- Modalità STRIX RAID
- Porta uscita cuffie
- Porta ingresso microfono
- Foro di sicurezza Kensington®
- Collegamento Box

### العربية

- منفذ دخل الميكروفون  
منفذ دخل الخط
- منفذ خرج سماعة الرأس  
رابط العلية
- منفذ الجراج الأمامي
- منفذ الجراج الخلفي
- منفذ الجراج الأوسط
- منفذ الجراج الجانبي  
منفذ خرج S/PDIF
- اختيار الجراج/التحكم في مستوى الصوت  
مؤشرات بيان LED
- مؤشر بيان LED مصدر الجراج
- وضع STRIX RAID
- منفذ خرج سماعات الرأس
- منفذ دخل الميكروفون
- فتحة تأمين Kensington®
- رابط العلية

### Български

- Вход за микрофон  
Line In порт
- Изход за слушалки
- Свързване с контролен блок
- Преден изход
- Заден изход
- Централен изход
- Страничен изход  
S/PDIF изход
- Избор на изходен сигнал/управление на силата на звука
- LED индикатори
- LED индикатор на източник на изходен сигнал
- Режим STRIX RAID
- Изход за слушалки
- Вход за микрофон
- Kensington® заключване
- Свързване с контролен блок

### Dansk

- Mikrofonstik  
linje-indgang
- Hovedtelefonstik
- Boks-link
- Forreste udgangsport
- Bageste udgangsport
- Midterste udgangsport
- Side-udgangsport  
S/PDIF-udgangsport
- Vælg udgangsport / Lydstyrkejustering
- LED-indikatorer
- LED-indikator til udgangskilde
- STRIX RAID
- Hovedtelefonstik
- Mikrofonstik
- Stik til Kensington® lås
- Boks-link

### Magyar

- Mikrofonbemeneti port  
vonalbemeneti port
- Fejhallgató-kimeneti port
- Box link
- Elülső kimeneti port
- Hátsó kimeneti port
- Középső kimeneti port
- Oldalsó kimeneti port  
S/PDIF-kimeneti port
- Kimenetválasztás/Hangerő-szabályozó
- LED jelzőfények
- Kimeneti forrás LED jelzőfénye
- STRIX RAID mód
- Fejhallgató kimeneti port
- Mikrofon bemeneti port
- Kensington® biztonsági nyílás
- Box link

### 简体中文

- 麦克风输入接口  
Line In 接口
- 耳机输出接口
- Box link
- 前置扬声器输出接口
- 后置扬声器输出接口
- 中央声道扬声器输出接口
- 侧边扬声器输出接口  
S/PDIF 输出接口
- 输出选择/音量调节
- LED 指示灯
- 输出源 LED 指示灯
- STRIX RAID Mode
- 耳机输出接口
- 麦克风输入接口
- Kensington® 安全插槽
- Box link

### 日本語

- マイク入力ポート  
ライン入力ポート
- ヘッドホン出力ポート
- Box link
- フロント出力ポート
- リア出力ポート
- センター出力ポート
- サイド出力ポート  
S/PDIF 出力ポート
- 出力切替/音量調整
- 音量/エフェクトレベルインジケータ
- 出力インジケータ
- STRIX RAID モードボタン
- ヘッドホン出力ポート
- マイク入力ポート
- Kensington® セキュリティーロット
- Box link

## Hardware Features

### Français

- Prise microphone  
Line In-Port
- Prise casque
- Prise de connexion au boîtier de contrôle
- Prise de sortie haut-parleur avant
- Prise de sortie haut-parleur arrière
- Prise de sortie haut-parleur central
- Prise de sortie haut-parleur latéral  
Prise de sortie S/PDIF
- Sélection de sortie / Contrôle du volume
- Témoins lumineux
- Témoin lumineux de la source de sortie
- Mode STRIX RAID
- Prise casque
- Prise microphone
- Fente de sécurité Kensington®
- Prise de connexion au boîtier de contrôle

### 한국어

- 마이크 입력 포트  
Line 입력 포트
- 헤드폰 출력 포트
- 박스 링크
- 전방 출력 포트
- 후면 출력 포트
- 중앙 출력 포트
- 측면 출력 포트  
S/PDIF 출력/측면 출력 포트
- 출력 선택 / 볼륨 조절
- LED 표시 등
- 출력 소스 LED 표시 등
- STRIX RAID 모드
- 헤드폰 출력 포트
- 마이크 입력 포트
- Kensington® 보안 슬롯
- 박스 링크

### Hrvatski

- Ulazni priključak za mikrofon  
Linijski ulazni
- Izlazni priključak slušalica
- Veza za kutiju
- Priključak prednjeg izlaza
- Stražnji izlazni priključak
- Priključak izlaza za srednji zvučnik
- Priključak bočnog izlaza  
S/PDIF izlazni/bočni priključak
- Odabir izlaza/regulator glasnoće
- LED Indikatori
- LED indikator izvora izlaza
- STRIX RAID način rada
- Izlazni priključak za slušalice
- Ulazni priključak za mikrofon
- Sigurnosni utor Kensington®
- Veza za kutiju

### Suomi

- Mikrofonin tuloportti  
Linja sisään -portti
- Kuulokemikrofonin lähtöportti
- Rasialinkki
- Etu-lähtöportti
- Tasavirtälähtöportti
- Keskilähtöportti
- Sivulähtöportti  
S/PDIF-lähtöportti
- Lähtövalinta / Äänenvoimakkuuden säätö
- LED-merkkivalot
- Lähtövalheen LED-merkkivalo
- STRIX RAID -tila
- Kuulokelähtöportti
- Mikrofonituloportti
- Kensington®-turv lukkopaikka
- Rasialinkki

### Norski

- Mikrofon Inn port  
Linje Inn-port
- Hodetelefon Ut-port
- Boks-kobling
- Port keluar depan
- Bakre Ut-port
- Port Output Tengah
- Port Output Samping  
S/PDIF Ut-port
- Utgangsvalg/Volumkontroll
- Indikator LED
- Indikator LED Sumber Output
- Mode STRIX RAID
- Port Output Headphone
- Mikrofon-inngang
- Spor for Kensington®-lås
- Boks-kobling

### Deutsch

- Mikrofoneingang  
Line In-Port
- Kopfhöerausgang
- Boxverbindung
- Frontausgang
- Rück-Surround-Ausgang
- Center-Ausgang
- Seitlicher Ausgang  
S/PDIF-/Seiten-Ausgang
- Ausgangsauswahl-/Lautstärkereglung
- LED-Anzeige
- LED-Anzeige für die Ausgangsquelle
- STRIX-RAID-Modus
- Kopfhöerausgang
- Mikrofoneingang
- Kensington® Schlossanschluss
- Boxverbindung

### Русский

- Разъем для микрофона  
Аудиовход
- Разъем для наушников
- Кабель для пульта
- Выход фронтального канала
- Выход тылового канала
- Выход центрального канала
- Выход бокового канала  
S/PDIF-выход
- Выбор выхода / Регулировка громкости
- Индикаторы
- Индикатор выбранного выхода
- Режим STRIX RAID
- Разъем для наушников
- Разъем для подключения микрофона
- Порт для замка Kensington
- Кабель для пульта

### Čeština

- Vstupní port mikrofonu  
liniový vstup
- Výstupní port pro připojení sluchátek
- Připojení ovladače
- Přední výstupní port
- Zadní výstupní port
- Port středového výstupu
- Port postranního výstupu  
Výstupní port S/PDIF
- Výběr výstupu /ovládání hlasitosti
- Indikátory LED
- Indikátor LED výstupního zařízení
- Režim STRIX RAID
- Port výstupu sluchátek
- Port vstupu mikrofonu
- Bezpečnostní slot Kensington®
- Připojení ovladače

### Ελληνικά

- Θύρα εισόδου μικροφώνου  
Θύρα εισόδου
- Θύρα εξόδου ακουστικών
- Σύνδεση Βox
- Μπροστινή θύρα εξόδου
- Πίσω θύρα εξόδου
- Θύρα κεντρικής εξόδου
- Θύρα πλευρικής εξόδου  
Θύρα εξόδου S/PDIF
- Επιλογή εξόδου/Ρύθμιση έντασης
- Ενδεικτικές λυχνίες LED
- Λυχνία ένδειξης LED πηγής εξόδου
- Λειτουργία STRIX RAID
- Θύρα εξόδου ακουστικών
- Θύρα εισόδου μικροφώνου
- Υποδοχή κλειδαριάς ασφαλείας Kensington®
- Σύνδεση Βox

### Polski

- Wejściowy port mikrofonu  
wejściowy port liniowy
- Wyjściowy port słuchawkowy
- Łączce Box
- Port wyjściowy głośnika przedniego
- Port wyjściowy głośnika tylnego
- Centralne gniazdo wyjścia
- Boczne gniazdo wyjścia  
Port wyjściowy S/PDIF
- Wybór wyjścia/Regulacja głośności
- Wskaźniki LED
- Wskaźnik LED źródła wyjścia
- Tryb STRIX RAID
- Gniazdo wyjścia słuchawek
- Gniazdo wejścia mikrofonu
- Gniazdo zabezpieczenia Kensington®
- Łączce Box

# Hardware Features

## Português

1. Porta de entrada de microfones
2. Porta de entrada de linha
3. Ligaçao da caixa
4. Porta de saída frontal
5. Porta de saída traseira
6. Porta de saída central
7. Porta de saída lateral
8. Seleção de saída/controlo de volume
9. Indicadores LED
10. Indicador LED de fonte de saída
11. Modo STRIX RAID
12. Porta de saída para auscultadores
13. Porta de entrada de microfones
14. Ranhura de segurança Kensington®
15. Ligaçao da caixa

## Español

1. Puerto Entrada de micrófono
2. Puerto para Auriculares
3. Conexión con la caja
4. Puerto para Salida Frontal
5. Puerto Salida posterior
6. Puerto de salida central
7. Puerto de salida lateral
8. Selección de salida/Control de volumen
9. Indicadores LED
10. Indicador LED de fuente de salida
11. Modo RAID STRIX
12. Puerto de salida de auriculares
13. Puerto de entrada de micrófono
14. Ranura de seguridad Kensington®
15. Conexión con la caja

## Türkçe

1. Mikrofon Giriş portu
2. Kulaklık Çıkış portu
3. Kutu bağlantısı
4. Ön Çıkış portu
5. Arka Çıkış bağlantı noktası
6. Merkezi Çıkış bağlantı noktası
7. Yan Çıkış bağlantı noktası
8. Çıkış Seç/Ses Düzeyi Kontrolü
9. LED Göstergeler
10. Çıkış Kaynağı LED Göstergesi
11. STRIX RAID Modu
12. Kulaklık Çıkış Bağlantı Noktası
13. Mikrofon Girişi Bağlantı Noktası
14. Kensington® Güvenlik Yuvası
15. Kutu bağlantısı

## Slovenščina

1. Vhodna vrata za mikrofoni
2. Izhodna vrata za slušalke
3. Povezovanje enote
4. Sprednja izhodna vrata
5. Zadnja izhodna vrata
6. Osrednja izhodna vrata
7. Stranska izhodna vrata
8. Izbira izhoda/nadzor glasnosti
9. LED-indikatorji
10. LED-indikator izhodnega vira
11. Način STRIX RAID
12. Izhodna vrata za slušalke
13. Vhodna vrata za mikrofoni
14. Varnostna reža Kensington®
15. Povezovanje enote

## Svenska

1. Mikrofoningång
2. Hörlursutgång
3. Boxlänk
4. Frontutgång
5. Bakre utgång
6. Central utgångsport
7. Sida utgångsport
8. Uteffektssval/Volymkontroll
9. LED-indikatorer
10. Utkälla LED-indikator
11. STRIX Raid-läge
12. Hörlurar utgångsport
13. Mikrofon ingångsport
14. Kensington® Säkerhetslucka
15. Boxlänk

## Українська

1. Порт входу мікрофону
2. Порт виходу гарнітури
3. Текстове поле
4. Передній порт виходу
5. Задній порт виходу
6. Вихід центрального порту
7. Вихід бічного порту
8. Вибір виходу/Контроль гучності
9. Світлодіодні індикатори
10. Світлодіодний індикатор джерела виходу
11. Режим STRIX RAID
12. Порт виходу навушників
13. Порт входу мікрофону
14. Отвір пристроїв безпеки Kensington®
15. Текстове поле

# Connectivity Options

## Connecting Strix Control Box (Strix Raid DLX/PRO only)

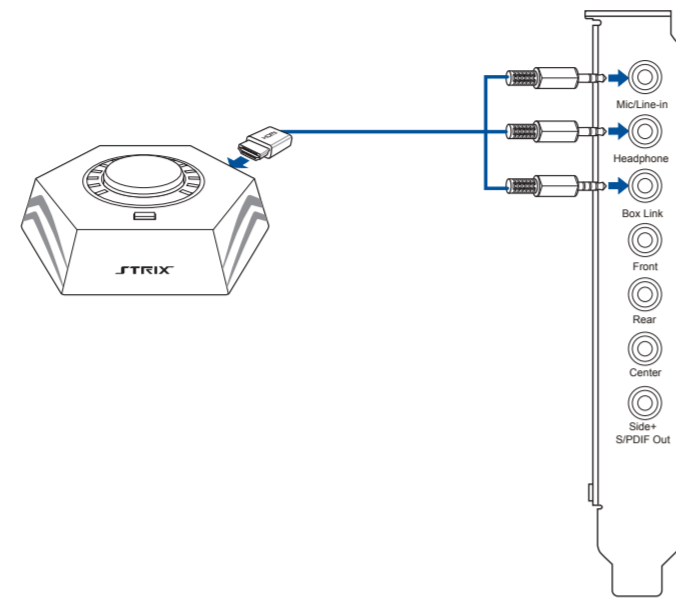

## Connecting Microphone/ Line In

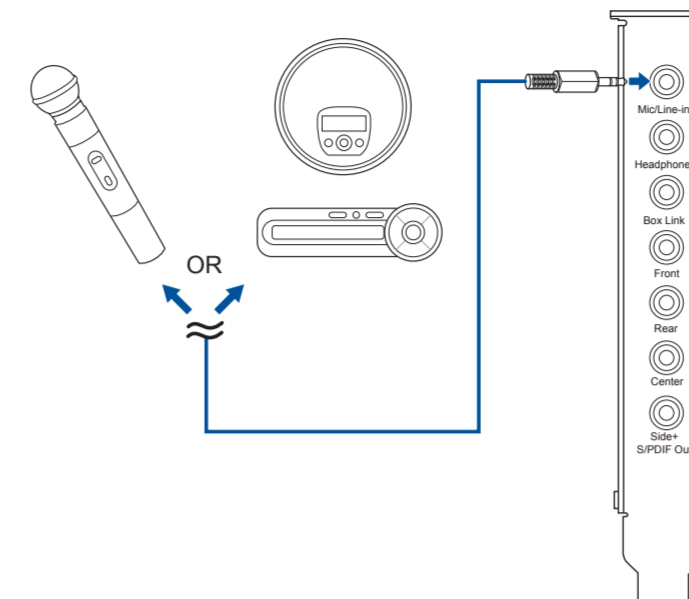

## Connecting 4 Channel Speakers / Power Amplifier

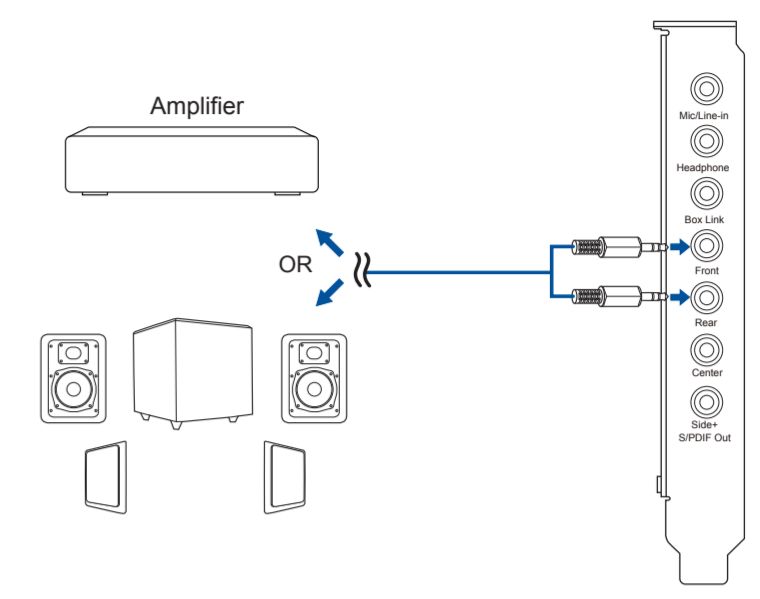

## Connecting Strix Control Box with external microphone and headphone(Strix Raid DLX/PRO only)

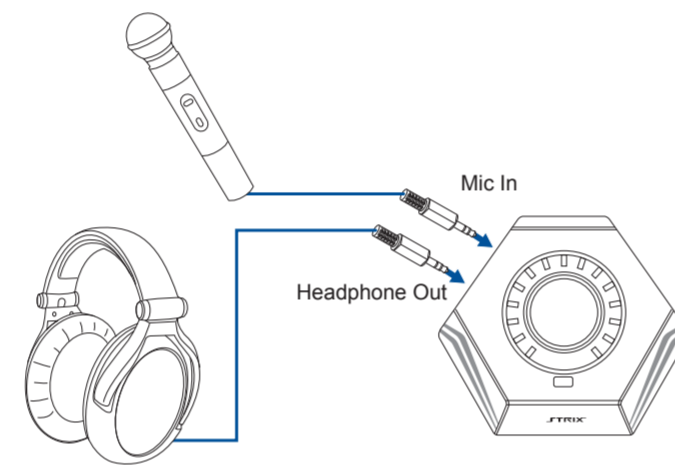

## Connecting Stereo Headphones

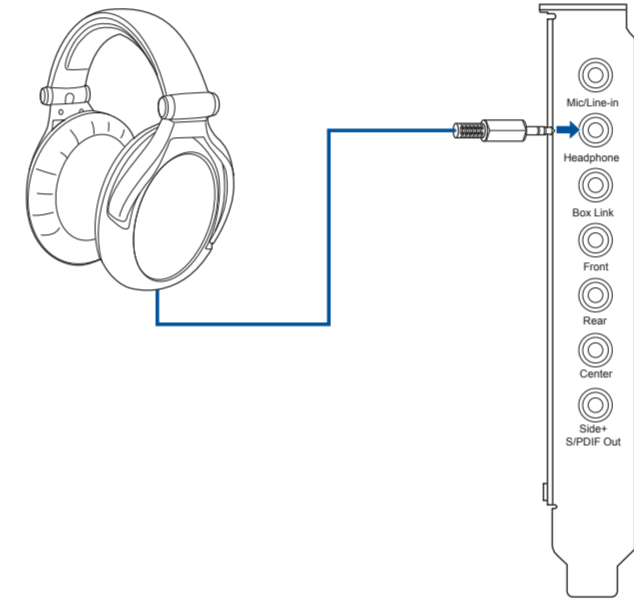

## Connecting 5.1 Channel Speakers/ 5.1 Channel Headphone

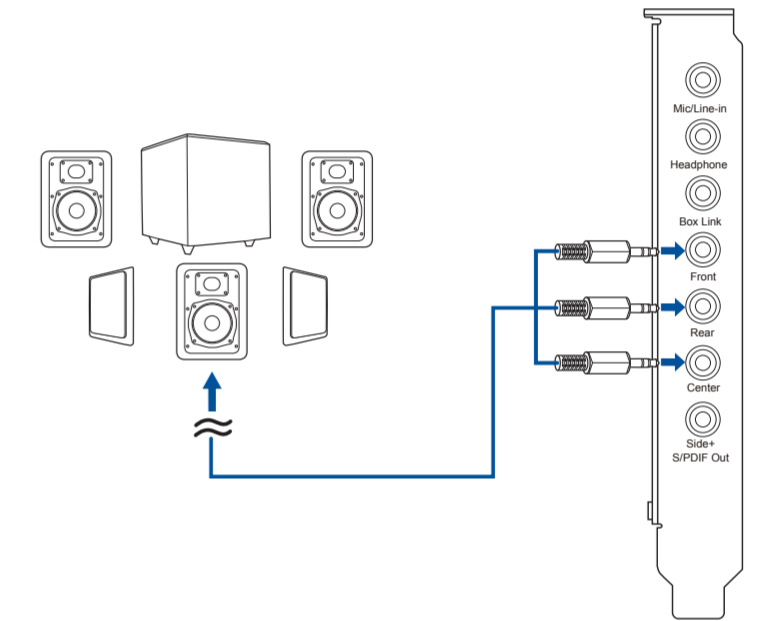

## Connecting to TOSLINK and COAXIAL SPDIF input connection

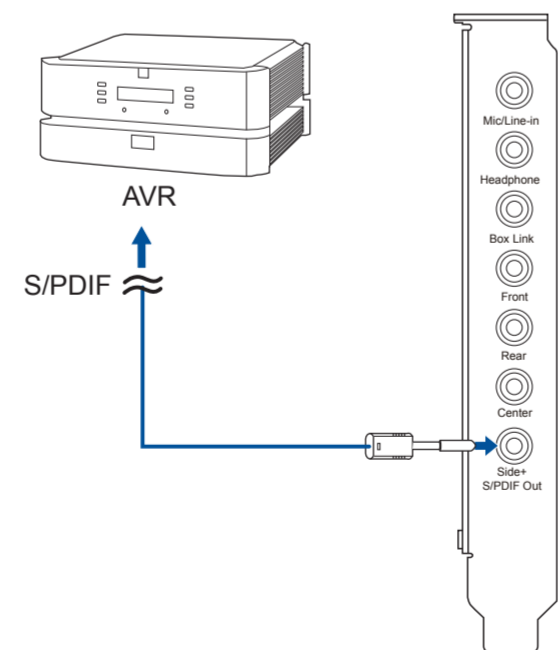

## Connecting 2 channel speakers

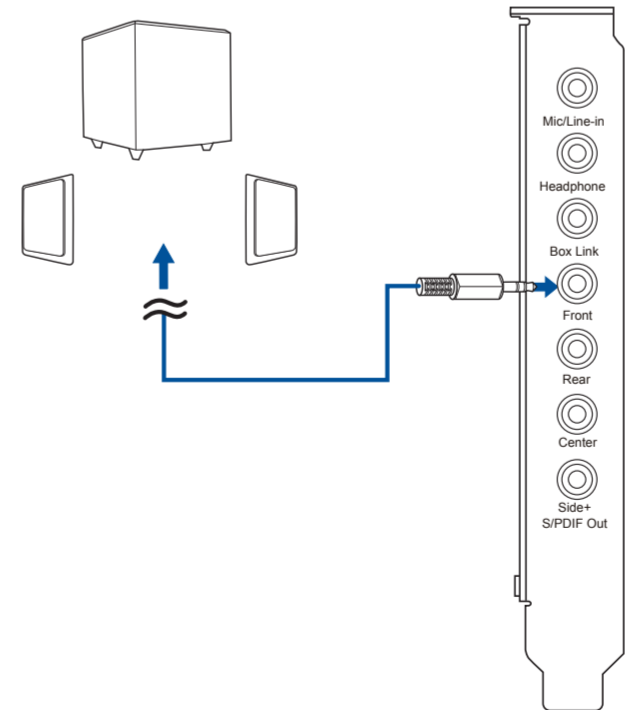

## Connecting 7.1 Channel Speakers

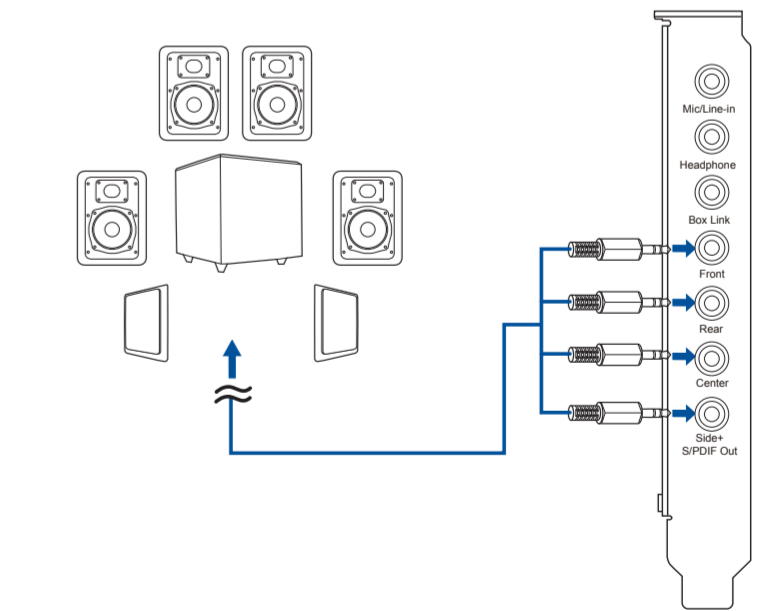

## UKCA statement

### Simplified UKCA Declaration of Conformity

ASUSTek Computer Inc. hereby declares that this device is in compliance with the essential requirements and other relevant provisions of related Regulations. Full text of UKCA declaration of conformity is available at <https://www.asus.com/support/>.



Manufacturer	ASUSTek Computer Inc. Tel: +886-2-2894-3447 Address: 1F, No. 15, Lide Rd., Beitou Dist., Taipei City 112, Taiwan
Authorised representative in United Kingdom	ASUSTEK (UK) LIMITED Tel./FAX No.: +44-01442-202-700 / +44-01442-245-882 Address: 1 <sup>st</sup> Floor, Sackville House, 143-149 Fenchurch Street, London, EC3M 6BL, England, United Kingdom
Authorised representative in Europe	ASUS Computer GmbH Address: HARKORT STR. 21-23, 40880 RATINGEN, GERMANY

## AEEE Yönetmeliğine Uygundur



## ASUS WARRANTY UPDATE

From 1 January 2012 updated warranties apply to all ASUS products, consistent with the Australian Consumer Law. For the latest product warranty details please visit: <https://www.asus.com/support>

Our goods come with guarantees that cannot be excluded under the Australian Consumer Law. You are entitled to a replacement or refund for a major failure and compensation for any other reasonably foreseeable loss or damage. You are also entitled to have the goods repaired or replaced if the goods fail to be of acceptable quality and the failure does not amount to a major failure.



CAN ICES-003 (B)/NMB-003 (B)

If you require assistance please call ASUS Customer Service 1300 2787 88 | <https://www.asus.com/support>