

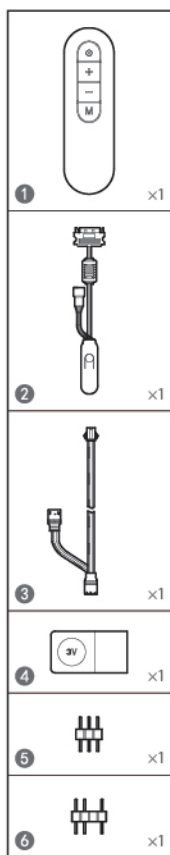

# A-RGB控制器

- EN** For further information, please consult [www.deepcool.com](http://www.deepcool.com)
- DE** Für weitere Informationen, besuchen Sie bitte unsere Webseite: [www.deepcool.com](http://www.deepcool.com)
- IT** Per ulteriori informazioni, si prega di consultare: [www.deepcool.com](http://www.deepcool.com)
- FR** Pour plus d'informations, s'il vous plaît consulter le site: [www.deepcool.com](http://www.deepcool.com)
- ES** Para más información, por favor consulte nuestra página web: [www.deepcool.com](http://www.deepcool.com)
- PT** Para mais informações, por favor consulte: [www.deepcool.com](http://www.deepcool.com)
- PL** W celu uzyskania dalszych informacji, proszę kliknąć: [www.deepcool.com](http://www.deepcool.com)
- CS** Pro další informace se prosím obraťte: [www.deepcool.com](http://www.deepcool.com)
- RU** Для дополнительной информации, пожалуйста, посетите [www.deepcool.com](http://www.deepcool.com)
- KK** Көсымша ақпарат үшін [www.deepcool.com](http://www.deepcool.com) жүгініңіз
- TR** Daha fazla bilgi için, lütfen: [www.deepcool.com](http://www.deepcool.com)
- JP** 製品に関する最新の情報を右記サイトで公開しております [www.deepcool.com](http://www.deepcool.com)
- KR** 보다 자세한 내용은 아래의 홈페이지를 참조하세요 [www.deepcool.com](http://www.deepcool.com)
- CH** 如欲取得更多資料, 請瀏覽網站 [www.deepcool.com](http://www.deepcool.com)
- CH** 如需要更多信息, 請瀏覽網站 [www.deepcool.com](http://www.deepcool.com)



### 注意

❗错误的连接方式将会损坏设备, 务必小心连接!

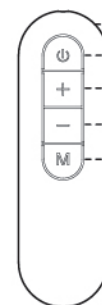
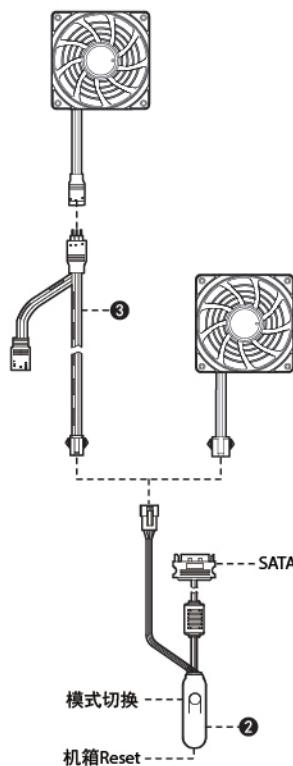

- ① 灯光开关键: 长按3秒以上, 开启/关闭灯效
- + 5档速度调节 (呼吸、渐变模式)
- 5档亮度调节 (常亮模式)
- M 模式切换: 流动幻彩、渐变、常亮、流星4种灯效模式
- 流动幻彩: 红橙黄绿青蓝紫依次流动;
- 呼吸模式: 红、橙、黄、绿、青、蓝、紫、白;
- 渐变模式: 红橙黄绿青蓝紫依次渐变;
- 流星模式



- 长按3秒以上, 开启/关闭灯效;
- 短按, 实现灯光模式切换
- 接收器可接机箱Reset按键, 实现灯光模式的切换。
- (机箱Reset按键与接收器按键功能相同)

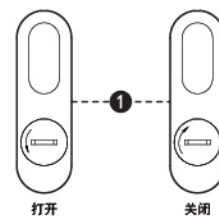

打开 关闭



# A-RGB Controller

- EN** For further information, please consult [www.deepcool.com](http://www.deepcool.com)
- DE** Für weitere Informationen, besuchen Sie bitte unsere Webseite: [www.deepcool.com](http://www.deepcool.com)
- IT** Per ulteriori informazioni, si prega di consultare: [www.deepcool.com](http://www.deepcool.com)
- FR** Pour plus d'informations, s'il vous plaît consulter le site: [www.deepcool.com](http://www.deepcool.com)
- ES** Para más información, por favor consulte nuestra página web: [www.deepcool.com](http://www.deepcool.com)
- PT** Para mais informações, por favor consulte: [www.deepcool.com](http://www.deepcool.com)
- PL** W celu uzyskania dalszych informacji, proszę kliknąć: [www.deepcool.com](http://www.deepcool.com)
- CS** Pro další informace se prosím obraťte: [www.deepcool.com](http://www.deepcool.com)
- RU** Для дополнительной информации, пожалуйста, посетите [www.deepcool.com](http://www.deepcool.com)
- KK** Көсымша ақпарат үшін [www.deepcool.com](http://www.deepcool.com) жүгініңіз
- TR** Daha fazla bilgi için, lütfen: [www.deepcool.com](http://www.deepcool.com)
- JP** 製品に関する最新の情報を右記サイトで公開しております [www.deepcool.com](http://www.deepcool.com)
- KR** 보다 자세한 내용은 아래의 홈페이지를 참조하세요 [www.deepcool.com](http://www.deepcool.com)
- CH** 如欲取得更多資料, 請瀏覽網站 [www.deepcool.com](http://www.deepcool.com)
- CH** 如需要更多信息, 請瀏覽網站 [www.deepcool.com](http://www.deepcool.com)

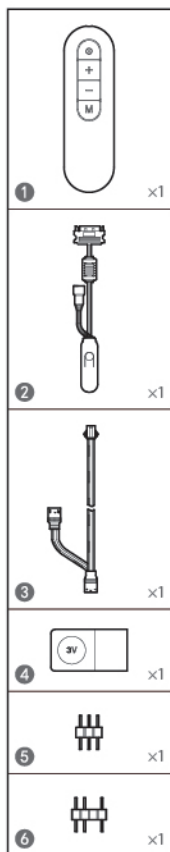

### CAUTION

❗ Wrong connection will damage the device and cause mal-function!

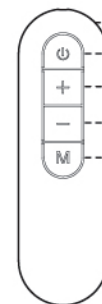
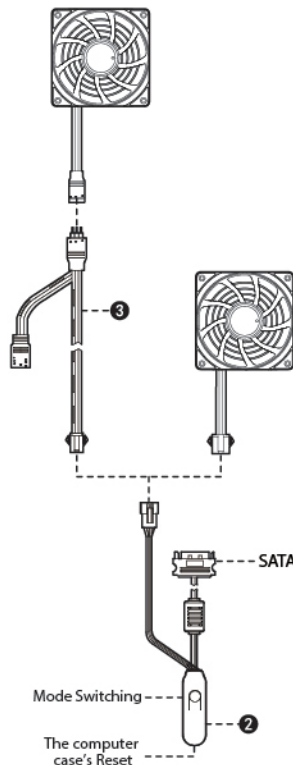

- ① Hold over 3 seconds to turn on/off lighting.
- + 5 level speed adjustments (Respire and Gradual Change Modes)
- 5 level brightness adjustments (Normal Mode)
- M Mode Switching: 4 Lighting Modes: Flowing Color, Gradual Change, Normal, Meteoroid
- Flowing color in the following order: Red, orange, yellow, green, turquoise, blue, purple.
- Respire Mode: Red, orange, yellow, green, turquoise, blue, purple, white;
- Gradual Change Mode: Gradual color change in the following order: Red, orange, yellow, green, turquoise, blue, purple
- Meteoroid Mode



- Hold over 3 seconds to turn on/off lighting; Quick press will allow switching of lighting modes.
- The receptor can be connected to the computer case's Reset button, allowing switching of lighting modes. (The computer case's Reset button has the same functions as the receptor's button)

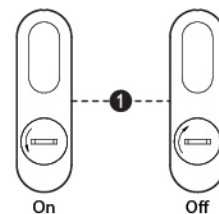

On Off