

QUICK START GUIDE

TUNE115TWS



WHAT'S IN THE BOX



HOW TO WEAR

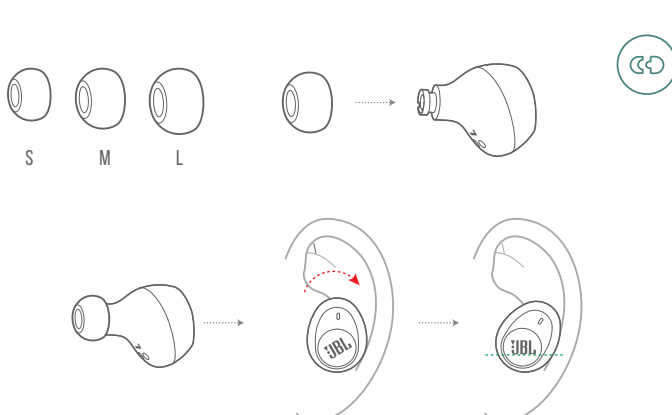

FIRST TIME USE

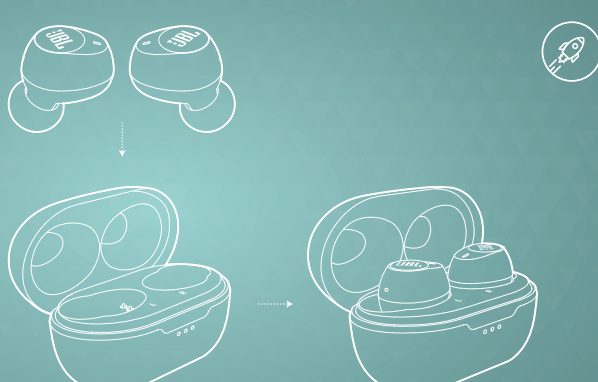

POWER ON & CONNECT

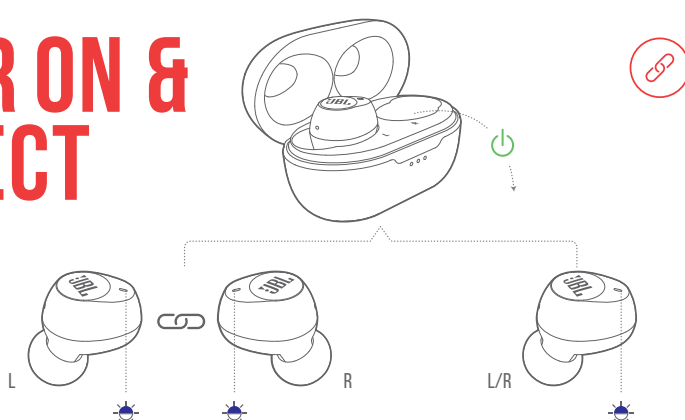

PAIRING

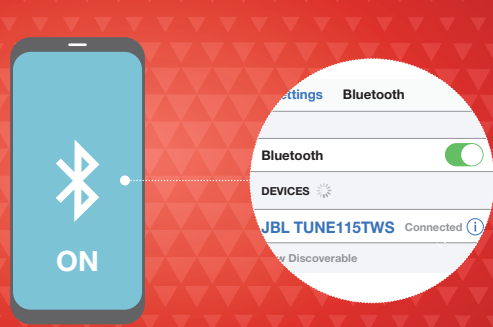

CHOOSE "JBL TUNE115TWS" TO CONNECT

POWER OFF

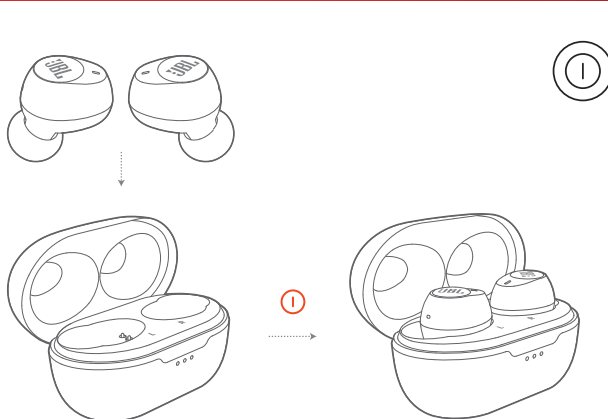

MANUAL CONTROLS

POWER ON & CONNECT TO DEVICE



RECONNECTING LEFT & RIGHT



POWER ON



POWER OFF



BUTTON COMMAND

1. STEREO MODE

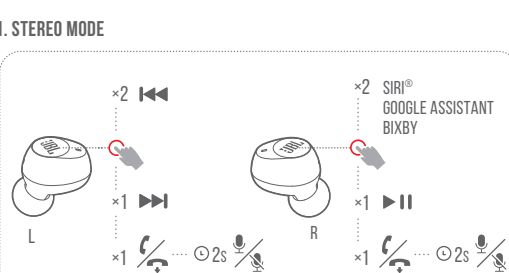

2. MONO MODE

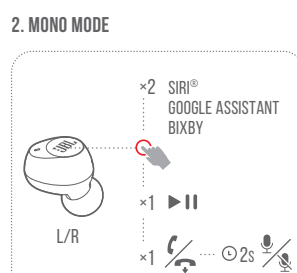

SEAMLESS AUTOMATIC SWITCH

CHARGING

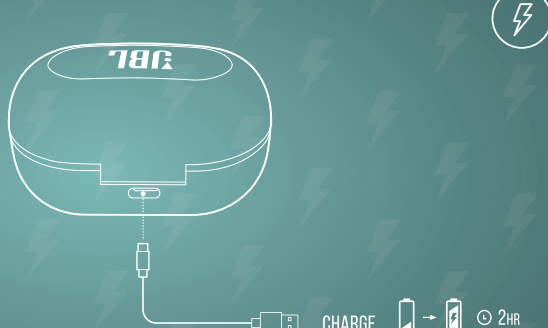

LED BEHAVIORS

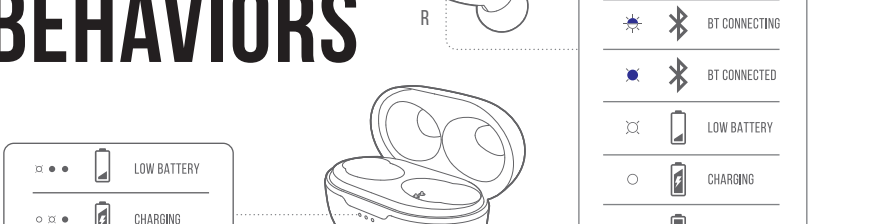

TECH SPEC

Model:	TUNE115TWS
Driver size:	5.8 mm / 0.23" Dynamic driver
Power supply:	5V ~ 0.5 A
Weight:	51.8 g / 0.114 lbs
Earpiece:	5.15 g / 0.0114 lbs / pc (10.3 g / 0.0227 lbs combined)
Charging case:	41.5 g / 0.0915 lbs
Headset battery type:	Lithium-ion Battery (55 mAh / 3.7 V)
Charging case battery type:	Lithium-ion Battery (410 mAh / 3.8 V)
Charging time:	< 2 hrs from empty
Music playtime with BT on:	up to 6 hrs
Frequency Response:	20 Hz - 20 kHz
Impedance:	14 ohm
Maximum SPL:	95 dB
Sensitivity:	108 dB SPL@1 kHz / 1 mW
Microphone sensitivity:	-38 dBV@1 kHz / Pa
Bluetooth version:	5.0
Bluetooth profile version:	A2DP 1.3, AVRCP 1.6, HFP 1.7
Bluetooth transmitter frequency range:	2.4 GHz - 2.4835 GHz
Bluetooth transmitter power:	< 12 dBm
Bluetooth transmitter modulation:	GFSK, π/4 DQPSK, 8DPSK
Maximum operation temperature:	45 °C

