

**aceline**

User Manual

---

Wireless Mouse  
AGS-W01

# Contents

Intended Use.....	3
Safety Precautions .....	3
Rechargeable Battery Guidelines (Li-pol/Li-ion) .....	4
Battery Capacity and Charge-Discharge Cycles.....	4
Natural Battery Wear .....	5
Use Only the Original Charger.....	5
Observe the Temperature Requirements .....	6
Do Not Disassemble, Burn, or Use Damaged Batteries.....	6
Device Diagram .....	7
Specifications .....	8
Package Contents.....	8
Operating Instructions.....	9
Rules and Conditions for Installation, Storage, Transportation, Sale (Distribution), and Disposal .....	10
Warranty Information .....	11
Additional Information .....	11

## Dear Customer,

Thank you for choosing our products.

We are pleased to offer you appliances and devices designed and manufactured to the highest standards of quality, functionality, and design. Before using the device, please read this manual carefully. It contains important information regarding your safety, as well as recommendations for the proper use and care of the product. Please keep this manual in a safe place and use it as a reference guide during future operation of the product.

## Intended Use

The mouse is a device for controlling the cursor and issuing various commands to the computer.

## Safety Precautions

- Do not make any modifications to the device.
- To avoid short circuits, do not expose the device to any liquids, and do not place open containers of liquid near it.
- Do not expose the device to electromagnetic radiation.
- This device is not intended for commercial use.
- This device is not intended for use by persons (including children) with reduced physical, sensory or mental capabilities, or lack of experience and knowledge, unless they have been given supervision or instruction concerning use of appliance by a person responsible for their safety. Children should be supervised to ensure that they do not play with the device.

# Rechargeable Battery Guidelines (Li-pol/Li-ion)

Dear Customer, please note that this device uses a lithium-based rechargeable battery as its power source. Please carefully read the information below to help extend the life of your battery and prevent undesirable consequences during its operation.

## Battery Capacity and Charge-Discharge Cycles

During prolonged storage and use, the rechargeable battery (hereinafter referred to as «the battery») tends to lose its charge and capacity. After 300 charge-discharge cycles (approximately one year of device use), the battery capacity may decrease to 80% of its nominal value. After 400 charge-discharge cycles, the battery capacity may decrease to 60% of its nominal capacity. Partial capacity reduction within these limits and timeframes is natural battery wear and is not considered a defect.

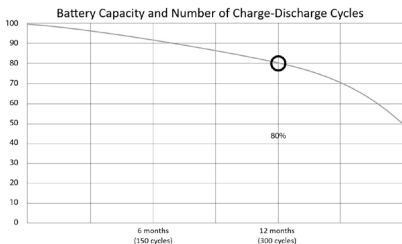

## Natural Battery Wear

The battery loses charge even when stored separately from the device. The self-discharge rate is approximately 5% per month. Due to their design, batteries are not durable and constantly degrade regardless of whether they are in use. This degradation accelerates at higher temperatures and when the charge level deviates from the «optimal» storage level, which is generally considered to be 40%. In other words, if the battery is not in use, it is advisable to keep the charge level between 40% and 50%.

## Use Only the Original Charger

The battery's charge and discharge capability is controlled by its built-in Battery Management System (BMS). Forced «fast charging» modes using external chargers for Li-ion batteries are strictly not recommended, as charge and discharge currents are limited.

Li-ion batteries do not have a so-called «memory effect» You can start charging or discharging the battery from any charge level.

Most devices have charge and discharge limits—the controller may prevent the battery charging if, for example, the charge is already above 90%. It will also prevent the battery from fully discharging, protecting the cells from damage. Even if the device is powered by the electrical grids, the Li-ion battery should undergo a full charge/discharge cycle at least once a month (until the «low battery» warning appears). Never let the battery discharge completely. A Li-ion battery degrades quickly if stored in a discharged state for a prolonged period. If this happens, charge it immediately. If the battery remains in a discharged state for two weeks or more, irreversible capacity loss occurs in the cells, which will ultimately lead to battery failure.

## Observe the Temperature Requirements

Batteries must be stored in a charged state at temperatures between +15 °C and +35 °C with normal humidity. Batteries do not perform well prolonged operation in very high (above +40 °C) or very low (below -10 °C) ambient temperatures. Do not leave the battery in direct sunlight.

## Do Not Disassemble, Burn, or Use Damaged Batteries

Under no circumstances should you attempt to disassemble the battery or charge its individual cells. For repair or maintenance, please contact an authorized service center.

Puncturing or crushing the cells can cause an internal short circuit, leading to fire and explosion. Melting of lithium due to high temperatures can also cause an explosion. If the seal is broken, water or condensed atmospheric moisture can enter the cell, potentially triggering a reaction that releases hydrogen and causes a fire. You can check the current battery status using the battery indicator, which is available on almost all devices (please check its location and operation method at the time of purchase).

### CAUTION:

- Be careful — damaged batteries may release harmful substances.
- If the battery is replaceable (removable), and you discover problems with its performance, contact a service center (see the warranty period in the warranty information). If the battery is built-in (an integral part of the device), the warranty applies to the device itself. You should also contact a service center. The sooner you bring a malfunctioning battery in for repair, the more likely it can be restored with minimal cost.

- Battery operating time depends on many other factors, and the actual operating time may differ from the stated value.
- Rechargeable batteries have a limited number of charge cycles and may eventually need replacement (see the limited warranty conditions for the battery in the warranty information). Battery operating time depends on the usage mode and settings.

## Device Diagram

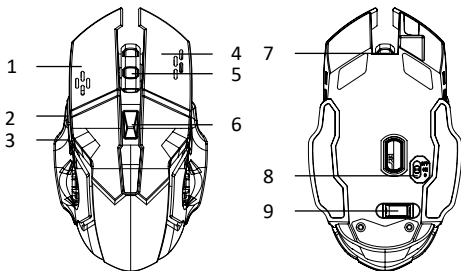

1. Left button.
2. Forward button.
3. Back button.
4. Right button.
5. Scroll wheel.
6. DPI switch.
7. USB Type-C port for charging and wired mode.
8. Power switch.
9. USB dongle compartment.

## Specifications

- Model: AGS-W01.
- Trademark: Aceline.
- Power supply: 3,7 V = 15 mA.
- Mouse type: wireless/wired.
- Connection: 2.4GHz band, USB Type-C.
- Material: Plastic.
- LED sensor: S203.
- Max. tracking speed: 60 IPS.
- Mouse acceleration: 20 G.
- Polling rate: 250 Hz.
- DPI modes: 800 / 1200 / 2400 / 3200 / 6400 DPI.
- Wireless standard: IEEE 802.15.4.
- Radio spectrum: 2402–2480 MHz.
- Transmit power: 0 dBm.
- Backlight: Rainbow.
- Battery type: Li-ion, 600 mAh.
- Charging time: up to 2 hours.
- Battery life:
  - Up to 30 hours (with backlight).
  - Up to 40 hours (without backlight).
- Switches: HUANO 5M.
- Encoder: F-switch.
- Cable: 1,5 m.
- Compatible OS: Windows.
- Scope of application: Domestic.

## Package Contents

- Device.
- User manual.
- Charging cable.
- USB dongle.

## Operating Instructions

1. Remove the USB dongle from the dedicated compartment on the bottom of the mouse.
2. Plug the dongle into a USB port on your computer (or connect the cable for wired mode).

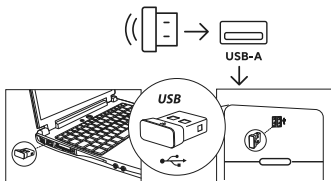

3. Turn on the mouse by sliding the switch on the bottom to the corresponding position (OFF — power off / wired mode; ON — power on without backlight; 0 — power on with backlight).
4. Wait for the device installation wizard to complete on your computer.
5. The mouse is ready for use.

## Rules and Conditions for Installation, Storage, Transportation, Sale (Distribution), and Disposal

- This device requires no assembly or mounting.
- The device must be stored in its original packaging, on heated premises, both at the manufacturer's and at the consumer's sites. The ambient temperature should be between +5 °C and +40 °C, and the relative humidity should not exceed 80% (non-condensing). The storage area must be free from aggressive contaminants (e.g., acid or alkali vapors) that could cause corrosion.
- The device must be transported in a dry place.
- The device requires careful handling. Protect it from exposure to dust, dirt, impact, moisture, fire, and other hazards.
- Sale or distribution of the device must be carried out in accordance with local legislation.
- Upon expiration of the device's service life, it must not be disposed of with unsorted household waste. Instead, it must be taken to an authorized collection point for electrical and electronic equipment for subsequent recycling and disposal in accordance with federal or local legislation. By ensuring proper disposal of this product, you help conserve natural resources and prevent potential harm to the environment and human health that may result from improper handling. For more detailed information about collection and disposal points for this product, please contact your local municipal authorities or your household waste disposal service.

## Warranty Information

The manufacturer guarantees the device will function properly throughout the warranty period and be free from defects in materials and assembly. The warranty period commences on the date of purchase and applies to new products only. Warranty service includes free repair or replacement of defective parts that fail during the warranty period, provided the failure is not caused by consumer misuse and the product is operated in accordance with the user manual. Repairs or part replacements shall be performed at authorized service centers.

**Warranty Period:** 12 months.

**Service Life:** 12 months.

For the up-to-date list of authorized service centers, please visit:  
<https://www.dns-shop.ru/service-center/>

## Additional Information

**Manufacturer:** SHENZHEN YUANYICHANG TECHNOLOGY CO., LTD.  
Building B, No.60, Zhuang Village Road, Xiner Industrial Park,  
Xinqiao Street, Bao'an District, Shenzhen City, Guangdong  
Province, China.

Made in China.

The product meets the requirements of the CU TR (EAEU).

Product specifications, information and appearance are subject to change without prior notice, for quality improvement of our products.



Production date (mm.yyyy): \_\_\_\_\_ v.1

**aceline**