

RAGE

GAMING LAPTOP



Contents

Intended Use	3
Safety Precautions	3
Rechargeable Battery Guidelines (Li-pol/Li-ion).....	4
Operating Instructions.....	6
Device Diagram (R15-R7ND502)	7
Device Diagram (R17-R7ND503).....	8
Device Indicators	9
Function Keys	9
Specifications	10
Cleaning and Maintenance.....	11
Troubleshooting Guide	11
Rules and Conditions for Installation, Storage, Transportation, Sale (Distribution), and Disposal	11
Warranty Information.....	12
Additional Information	12

Laptop ARDOR GAMING RAGE

User Manual

Dear Customer,

Thank you for your trust!

Our team fully shares your passion for computer games, which is why we put all our efforts into making your gaming experience unforgettable with our accessories for gamers. Wishing you new victories and the brightest impressions ahead!

Intended Use

A laptop is a portable personal computer that offers a high degree of autonomy thanks to its built-in input/output devices (touchpad, keyboard, and display) and an integrated rechargeable battery. It is capable of performing all the same tasks as desktop personal computers, including: data processing and storage, connecting to wireless networks, playing multimedia (audio and video) files, and running various applications and games.

Safety Precautions

- Do not expose the device to excessively high or low temperatures, dust, moisture, direct sunlight, strong vibration, or strong electromagnetic radiation.
- Avoid getting liquid into the device. Do not use it in areas where there is a risk of the device falling into water (e.g., swimming pool, pond, bathtub, etc.).
- Avoid getting dust and dirt into the laptop.
- The manufacturer does not guarantee full compatibility of the device with any third-party applications or the correct operation of these applications.
- Avoid dropping the device or striking it against hard surfaces.
- To avoid data loss, we recommend creating backup copies of your files. We are not responsible for data loss.
- Use only manufacturer-approved chargers and accessories. Using third-party power adapters may cause device failure, and using other accessories voids the warranty and may be dangerous.
- This device is not intended for use by persons (including children) with reduced physical, sensory or mental capabilities, or lack of experience and knowledge, unless they have been given supervision or instruction concerning use of appliance by a person responsible for their safety. Children should be supervised to ensure that they do not play with the device.
- Do not open the device housing. There are no user-serviceable parts inside. Servicing must be performed exclusively by qualified service personnel at an authorized service center.
- When removing the battery, charge it for at least 30 minutes before restarting the laptop.
- This device is not intended for commercial use.
- Turn off the laptop and disconnect it from the power source before cleaning it or connecting/disconnecting peripheral devices.
- Place the laptop on a flat and stable surface.
- Do not place the operating laptop directly on exposed body parts (legs, stomach, etc.).
- Do not carry the laptop constantly in a tightly packed bag (except for specially designed ones). Additionally, do not transport the laptop while it is turned on.
- Never lift or hold the laptop by the display.
- Do not turn the laptop over when it is connected to the charger (this may damage the cable).
- The slots and openings in the laptop housing are designed for ventilation. They ensure reliable operation of the laptop and protect it from overheating. Do not block or cover them.
- Do not allow any objects to enter the laptop through the openings in the housing.
- Do not use the laptop for extended periods on a bed or carpeted surface, as heat accumulates underneath it.
- Do not allow foreign objects to enter the laptop ports (e.g., paper clips).
- Do not place the power adapter on heat-sensitive surfaces.
- To avoid damaging the speakers, do not set the volume level to a point that causes obvious sound distortion.
- Never turn off or restart the laptop while the hard drive is being accessed, as indicated by the corresponding LED indicators, as this may result in data loss or damage to the HDD itself.
- Do not turn on the laptop within 5 seconds after turning it off. Hasty power-on may cause damage to the device.

Rechargeable Battery Guidelines (Li-pol/Li-ion)

Dear Customer, please note that this device uses a lithium-based rechargeable battery as its power source. Please carefully read the information below to help extend the life of your battery and prevent undesirable consequences during its operation.

Battery Capacity and Charge-Discharge Cycles

During prolonged storage and use, the rechargeable battery (hereinafter referred to as “the battery”) tends to lose its charge and capacity. After 300 charge-discharge cycles (approximately one year of device use), the battery capacity may decrease to 80% of its nominal value. After 400 charge-discharge cycles, the battery capacity may decrease to 60% of its nominal capacity. Partial capacity reduction within these limits and time frames is natural battery wear and is not considered a defect.

Battery Capacity and Number of Charge-Discharge Cycles

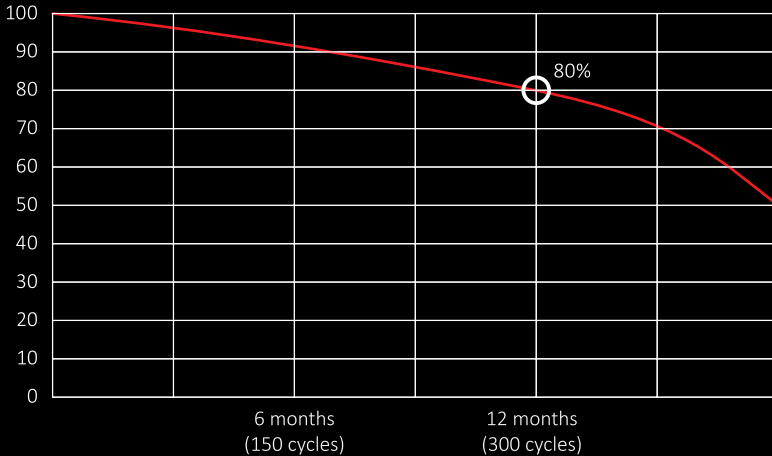

Natural Battery Wear

The battery loses charge even when stored separately from the device. The self-discharge rate is approximately 5% per month. Due to their design, batteries are not durable and constantly degrade regardless of whether they are in use. This degradation accelerates at higher temperatures and when the charge level deviates from the “optimal” storage level, which is generally considered to be 40%. In other words, if the battery is not in use, it is advisable to keep the charge level between 40% and 50%.

Use Only the Original Charger

The battery’s charge and discharge capability is controlled by its built-in Battery Management System (BMS). Forced “fast charging” modes using external chargers for Li-ion batteries are strictly not recommended, as charge and discharge currents are limited.

Li-ion batteries do not have a so-called “memory effect” You can start charging or discharging the battery from any charge level.

Most devices have charge and discharge limits—the controller may prevent the battery charging if, for example, the charge is already above 90%. It will also prevent the battery from fully discharging, protecting the cells from damage. Even if the device is powered by the electrical grids, the Li-ion battery should undergo a full charge/discharge cycle at least once a month (until the “low battery” warning appears). Never let the battery discharge completely. A Li-ion battery degrades quickly if stored in a discharged state for a prolonged period. If this happens, charge it immediately. If the battery remains in a discharged state for two weeks or more, irreversible capacity loss occurs in the cells, which will ultimately lead to battery failure.

Observe the Temperature Requirements

Batteries must be stored in a charged state at temperatures between +15 °C and +35 °C with normal humidity. Batteries do not perform well prolonged operation in very high (above +40 °C) or very low (below -10 °C) ambient temperatures. Do not leave the battery in direct sunlight.

Do Not Disassemble, Burn, or Use Damaged Batteries

Under no circumstances should you attempt to disassemble the battery or charge its individual cells. For repair or maintenance, please contact an authorized service center.

Puncturing or crushing the cells can cause an internal short circuit, leading to fire and explosion. Melting of lithium due to high temperatures can also cause an explosion. If the seal is broken, water or condensed atmospheric moisture can enter the cell, potentially triggering a reaction that releases hydrogen and causes a fire. You can check the current battery status using the battery indicator, which is available on almost all devices (please check its location and operation method at the time of purchase).

CAUTION:

- Be careful — damaged batteries may release harmful substances.
- If the battery is replaceable (removable), and you discover problems with its performance, contact a service center (see the warranty period in the warranty information). If the battery is built-in (an integral part of the device), the warranty applies to the device itself. You should also contact a service center. The sooner you bring a malfunctioning battery in for repair, the more likely it can be restored with minimal cost.
- Battery operating time depends on many other factors, and the actual operating time may differ from the stated value.
- Rechargeable batteries have a limited number of charge cycles and may eventually need replacement (see the limited warranty conditions for the battery in the warranty information). Battery operating time depends on the usage mode and settings.

Low-Temperature Operation Warning

- The optimal temperature range for using the device is 0 °C to +35 °C.
- We do not recommend using the device at temperatures below 0 °C or above +35 °C, as this may result in the following:
 - Displays experience incorrect color reproduction, reduced response time, and a sharp increase in contrast — the screen may simply «go black»; at a certain temperature, the image «freezes» — becomes stationary, even though the device is still functioning.
 - Most displays regain their normal functions after warming up, but severe cooling can cause displays to fail.
 - Batteries are not designed for use at low temperatures.
 - A device with an overcooled battery may shut down spontaneously, regardless of how recently it was charged.
 - You can restore battery functionality (at least partially) by warming the device to room temperature.
 - Energy consumption in the cold, numerous freeze/thaw cycles, and severe battery overcooling — all of these significantly reduce the maximum battery capacity of the device.
- When the device is deeply cooled (below -20 °C) and then warmed up, condensation may form on the internal components. Repeated condensation can oxidize metal circuit elements, potentially causing the device to fail.
- When cooled, the device's internal components, the display and housing, become more brittle and vulnerable to damage when frozen

To Avoid the Effects of Overcooling

- **Keep the device warm.** It is not advisable to store the device in bags, briefcases, and other similar places. If the device is in a bag, it is better to keep it in an insulated case. Short-term use of the device at low temperatures is acceptable.
- **Charge the device when it is warm.** Lithium-ion batteries should only be charged at temperatures between +5 °C and +45 °C. When coming in from the cold, allow the device to warm up to room temperature before connecting the charger.
- **Avoid thermal shock.** After returning to a warm room, give the device time to warm up gradually. This will prevent condensation from forming inside the device and protect it from corrosion. Rapid heating near heat sources can cause damage to the screen elements and internal circuits of the device, as well as failure of the device battery.

Operating Instructions

Preparation for use

1. Remove all packaging materials.
2. Place the laptop on a flat, stable surface.
3. Connect all peripheral devices you wish to use with the laptop (keyboard, mouse, etc.).
4. To protect the laptop during transport, the battery is locked and does not supply power to the system until the first connection to the power adapter. On first startup, unlock the battery by connecting the laptop to the power adapter.
5. Keep the adapter connected to the laptop until the battery is fully charged (the charging indicator will turn green).
6. With one hand, open the laptop lid to a comfortable viewing angle (no more than 130°); use your other hand (as shown in the figure below) to support the laptop base.

CAUTION: Never lift the device by the lid.

7. Press the power button to turn on the laptop.

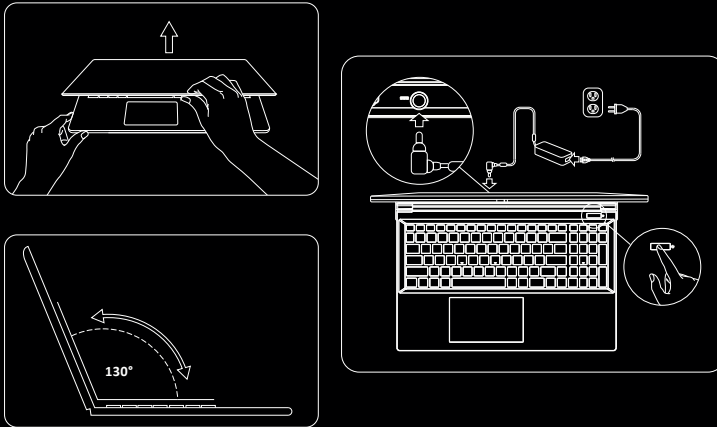

Device Diagram (R15-R7ND502)

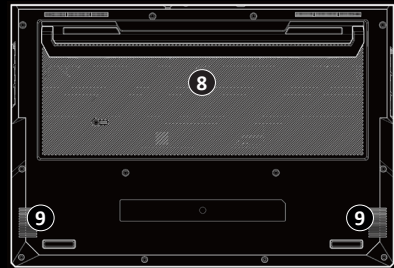

Front side



Left side



Right side



Back side



- | | |
|---|--------------------------|
| 1. Camera | 6. Keyboard |
| 2. Camera LED indicator (lights up when the camera is on) | 7. Touchpad with buttons |
| 3. Built-in microphone | 8. Ventilation openings |
| 4. Screen | 9. Speakers |
| 5. ON/OFF button | 10. LED indicators |

Device Diagram (R17-R7ND503)

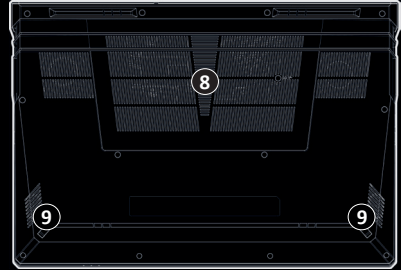
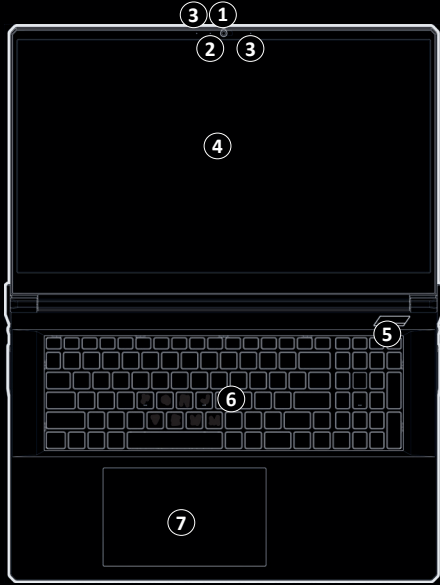

Front side



Left side



Right side





Back side



- 11. Kensington security lock slot
- 12. USB 3.2 Gen 1 Type-A connector
- 13. USB 2.0 Type-A connector
- 14. Audio jack
- 15. USB 3.2 Gen 2 Type-A connector

- 16. DisplayPort 2.1 over USB 3.2 Gen 2 Type-C
- 17. RJ-45 LAN connector
- 18. Power connector
- 19. HDMI connector
- 20. Mini DisplayPort 1.4 connector

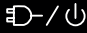
Device Indicators

Indicator	State	Description
	Solid orange	Power adapter is connected
	Solid green	Laptop is turned on
	Flashing green	Laptop is in sleep mode
	Solid orange	Battery is charging
	Solid green	Battery is fully charged
	Flashing orange	Battery charge level is critically low
	Solid green	Hard drive access

Function Keys

Combination	Description
Fn + ~`	Play/Pause (available for video and audio applications)
Fn + F1	Touchpad On/Off
Fn + F2	Turn off the display (press any key or touch the touchpad to turn it back on)
Fn + F3	Mute/Unmute sound
Fn + F4	Mute/Unmute microphone
Fn + F5	Decrease volume
Fn + F6	Increase volume
Fn + F7	Display settings
Fn + F8	Decrease display brightness
Fn + F9	Increase display brightness
Fn + F10	Camera On/Off
Fn + F11	Airplane Mode On/Off
Fn + F12	Sleep Mode On/Off
Num	Num Lock On/Off
Fn + Ins ScrLk	Scroll Lock On/Off
Caps	Caps Lock On/Off
Fn + Esc	Launch Control Center
Fn + 1	Adjust fan speed (Auto / Full speed)
Fn + 3	Switch power consumption modes
Fn + ◀ (Backspace)	FlexiKey On/Off
Fn + /	Launch keyboard backlight control program
Fn + *	Keyboard backlight On/Off
Fn + -	Decrease keyboard backlight brightness
Fn + +	Increase keyboard backlight brightness

Specifications

Trademark	ARDOR GAMING	
Model	RAGE	
Model extension	R15-R7ND502	R17-R7ND503
Power adapter specifications	Input: 100–240 V ~ 50 Hz	
	Output: 20 V = 9 A	
Operating system	No OS	
Radio Frequency Characteristics (Network standard, radio spectrum, transmit power)	Wi-Fi: IEEE 802.11 a/b/g/n/ac/ax; 2400–2483.5 MHz, 5150–5350 MHz, 5650–5725 MHz; 100 mW	
	Bluetooth: IEEE 802.15.1; 2400–2483.5 MHz; 100 mW	
Screen size	15.6''	17.3''
Resolution	1920 × 1080 (FHD)	
Refresh Rate	144 HZ	
Luminance	250 cd/m ²	
Panel technology	WVA	
Battery type and capacity	Li-Pol; 53.35 W·h	
CPU	AMD Ryzen 7 H 255	
Core count per processor	8	
CPU frequency	3.8–4.9 GHz	
Graphics processor	Nvidia RTX 5050	
Video memory size	8 GB	
Graphics processor TDP	115 W	
RAM	DDR5 5600 MHz	
RAM size	16 GB	
Number of RAM slots	2	
Internal SSD Storage	1024 GB	
Speaker power	2 × 2 W	
Camera resolution	1 MP (720p)	
Protection class (adapter)	I	
Protection class (device)	III	
Cord type	X	
IP code	IPX0	
Interface	<ul style="list-style-type: none"> • 3.5 mm jack (CTIA) • Power connector • HDMI • Mini DisplayPort (mDP) • RJ-45 • USB 2.0 Type-A • USB 3.2 Gen 1 Type-A • USB 3.2 Gen 2 Gen 1 Type-A • DisplayPort 2.1 в USB 3.2 Gen 2 Type-C 	
Scope of application	Domestic	
Package Contents	<ul style="list-style-type: none"> • Laptop • USB storage device with drivers • Power adapter • User manual 	

Cleaning and Maintenance

CAUTION: Before cleaning the device, ensure that the laptop is turned off and disconnected from the power source.

- Under no circumstances should you disassemble the device yourself.
- Wipe the device housing with a clean, soft cloth slightly dampened with soapy water, or use a specialized cleaning agent for computer equipment.
- Do not use alcohol, acetone, gasoline, or any other abrasive substances for cleaning.
- To clean the keyboard, use a soft, dry brush.

Troubleshooting Guide

Issue	Possible cause	Solution
The device does not turn on	The power cord is not properly connected	Ensure the power cord is connected properly
	Battery is discharged	Charge the battery before starting the device
The screen is very dark	The screen brightness is set to the minimum level	Go to the control panel and set the display brightness to above 50%. Or use the Fn + F8/F9 key combinations to adjust brightness
External drive is not recognized	The device has different USB connector types	Older type connectors may not read large capacity drives with newer connection interfaces. Try a different USB connector
Wi-Fi or Bluetooth is not working	Airplane Mode is turned on	Turn off Airplane Mode by pressing Fn + F11 key combination
Camera is not working	Camera is disabled	Enable the camera by pressing the Fn + F10 key combination

Rules and Conditions for Installation, Storage, Transportation, Sale (Distribution), and Disposal

- This device requires no assembly or mounting.
- The device must be stored in its original packaging, on heated premises, both at the manufacturer's and at the consumer's sites. The ambient temperature should be between +5 °C and +40 °C, and the relative humidity should not exceed 80% (non-condensing). The storage area must be free from aggressive contaminants (e.g., acid or alkali vapors) that could cause corrosion.
- The device must be transported in a dry place.
- The device requires careful handling. Protect it from exposure to dust, dirt, impact, moisture, fire, and other hazards.
- Sale or distribution of the device must be carried out in accordance with local legislation.
- Upon expiration of the device's service life, it must not be disposed of with unsorted household waste. Instead, it must be taken to an authorized collection point for electrical and electronic equipment for subsequent recycling and disposal in accordance with federal or local legislation. By ensuring proper disposal of this product, you help conserve natural resources and prevent potential harm to the environment and human health that may result from improper handling. For more detailed information about collection and disposal points for this product, please contact your local municipal authorities or your household waste disposal service.
- If a device malfunction is detected, immediately contact an authorized service center or dispose of the device.

Warranty Information

The manufacturer guarantees the device will function properly throughout the warranty period and be free from defects in materials and assembly. The warranty period commences on the date of purchase and applies to new products only. Warranty service includes free repair or replacement of defective parts that fail during the warranty period, provided the failure is not caused by consumer misuse and the product is operated in accordance with the user manual. Repairs or part replacements shall be performed at authorized service centers.

Warranty Period: 12 months

Service Life: 24 months

For the up-to-date list of authorized service centers, please visit: <https://www.dns-shop.ru/service-center/>

Additional Information

Manufacturer: Kapok Computer (Kunshan) Co., Ltd.No.200 Second Boulevard (the 2nd Road), Comprehensive Bounded Zone, Kunshan City, Jiangsu Province, China.

Made in China.

The product meets the requirements of the technical regulations of the TR CU (EAEU)

Product specifications, information and appearance are subject to change without prior notice, for quality improvement of our products.

Production date (mm.yyyy): _____ V.1





LEARN MORE:
ARDOR-GAMING.COM
VK.COM/ARDOR_GAMING

