

# User Manual

---

Monitor  
DF22N3S

**DEXP**

# Contents

<b>Intended Use</b> .....	<b>3</b>
<b>Safety Precautions</b> .....	<b>3</b>
<b>Assembly and Placement</b> .....	<b>4</b>
Monitor Placement .....	4
Assembly.....	5
Screen Position Adjustment.....	6
VESA Mount Specifications .....	6
<b>Specifications</b> .....	<b>7</b>
<b>Device Diagram</b> .....	<b>8</b>
Interface.....	9
<b>Operating Instructions</b> .....	<b>9</b>
Monitor Connection.....	9
Joystick / Control Button Functions .....	9
<b>Maintenance and Care</b> .....	<b>10</b>
<b>Troubleshooting Guide</b> .....	<b>10</b>
<b>Rules and Conditions for Installation, Storage, Transportation, Sale (Distribution), and Disposal</b> .....	<b>11</b>
<b>Warranty Information</b> .....	<b>12</b>
<b>Additional Information</b> .....	<b>12</b>

# Dear Customer,

Thank you for choosing our products.

We are pleased to offer you appliances and devices designed and manufactured to the highest standards of quality, functionality, and design. Before using the device, please read this manual carefully. It contains important information regarding your safety, as well as recommendations for the proper use and care of the product. Please keep this manual in a safe place and use it as a reference guide during future operation of the product.

## Intended Use

The monitor is designed to display information from a personal computer.

## Safety Precautions

- Before connecting the device to the power source, ensure that the voltage of your household electrical network matches its technical specifications.
- Place the device only on flat, stable surfaces.
- Avoid using the monitor near devices that generate magnetic fields (e.g., electric motors, televisions, etc.).
- Do not place heavy objects on the video cable or power cord, and protect them from physical damage (such as pinching, cutting, kinking, or twisting). Do not route the cables in areas where they may be accidentally tripped over or pulled by people or pets.
- Do not touch the power cord with wet hands.
- Position the monitor in a location that avoids reflections and glare on the screen.
- Do not block the ventilation openings on the back and bottom of the monitor or insert any objects into them.
- Protect the device from moisture, dust, and extreme temperatures.
- Always unplug the device when not in use and before assembling, disassembling, or cleaning.
- Immediately unplug the monitor from the power source in case of malfunction. Do not operate the device if it shows visible signs of damage, or if the power cord is damaged. Contact an authorized service center.
- If unusual sounds or odors occur, immediately disconnect the monitor from the power source and contact an authorized service center.
- Do not disassemble the device yourself to avoid electric shock. This device contains no user-serviceable parts. Maintenance and repairs should only be performed by qualified technicians at an authorized service center.
- This device is not intended for commercial use.
- This device is not intended for use by persons (including children) with reduced physical, sensory or mental capabilities, or lack of experience and knowledge, unless they have been given supervision or instruction concerning use of appliance by a person responsible for their safety. Children should be supervised to ensure that they do not play with the device.

# Assembly and Placement

## Monitor Placement

- Protect the device from direct sunlight.
- Install the monitor only in a well-ventilated area.
- Do not place heavy objects on top of the monitor.
- Place the monitor in a dry, dust-free location.
- Do not install the monitor near sources of magnetic fields (such as audio systems, televisions, and other devices).

**Note:** All images are for illustrative purposes only and may differ from the actual product.

*Wall mounting*

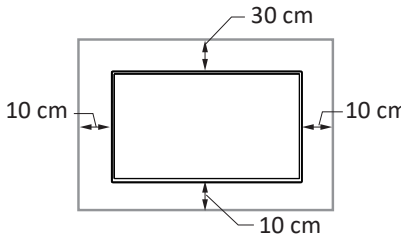

*Stand placement*

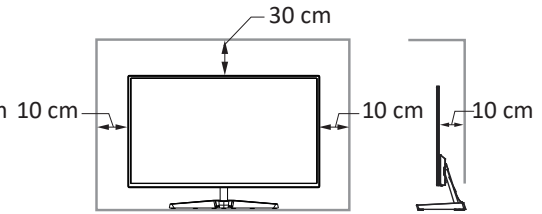

*Air circulation obstruction*

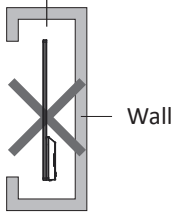

*Air circulation obstruction*

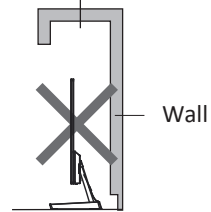

# Assembly

## Attaching the Stand

1. Join the stand parts together.

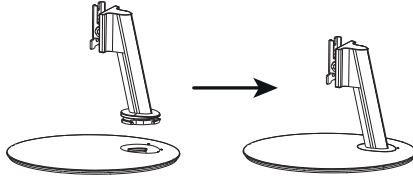

2. Insert the stand into the designated slot on the back of the monitor until it clicks into place.

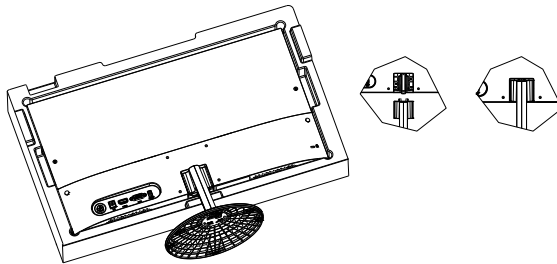

## Removing the Stand

Perform the above steps in reverse order.

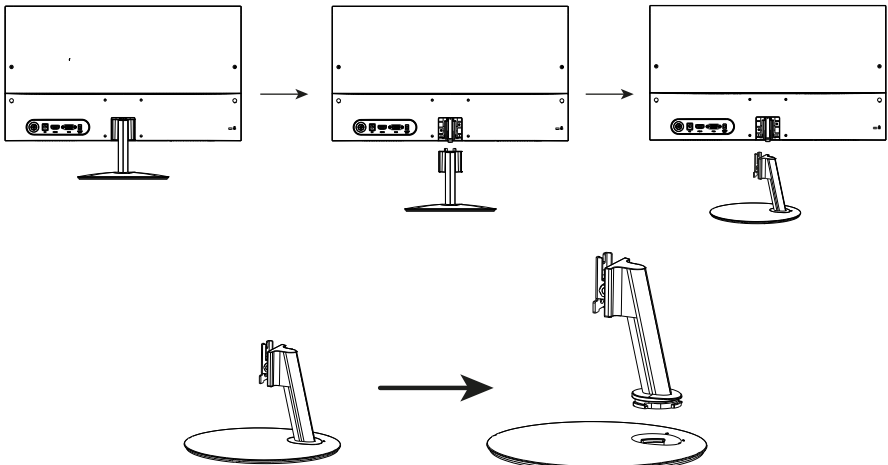

## Screen Position Adjustment

You can tilt the screen forward or backward within the angle shown in the diagram to achieve the most comfortable viewing position.

from  $-15^{\circ}$  to  $5^{\circ}$  ( $\pm 3^{\circ}$ )

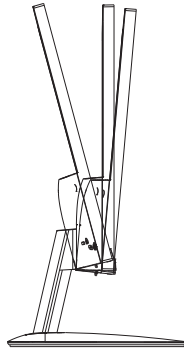

**Caution:** When adjusting the tilt angle, hold the monitor carefully by the frame and do not touch the screen itself to avoid damaging or soiling its surface. Do not apply excessive force when adjusting the tilt angle.

## VESA Mount Specifications

**Note:** The VESA mounting bracket and mounting screws are not included and must be purchased separately.

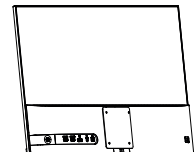
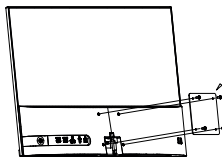
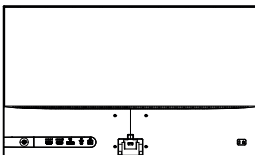
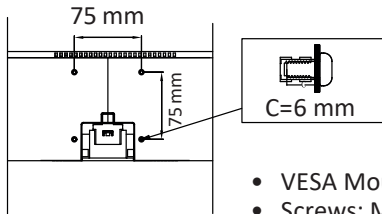

1. Place the monitor on a flat, soft, and stable surface with the screen facing down.
2. Attach the mounting bracket to the back panel using the 4 screws.

# Specifications

<b>Model</b>	DF22N3S
<b>Trademark</b>	DEXP
<b>Screen size</b>	21,45"
<b>Panel technology</b>	VA
<b>Maximum resolution</b>	1920 × 1080
<b>Maximum refresh rate</b>	100 Hz
<b>Pixel response time (GtG)</b>	5 ms
<b>Backlight technology</b>	LED
<b>Maximum number of colors</b>	16,7 million
<b>Luminance</b>	250 cd/m <sup>2</sup>
<b>Aspect ratio</b>	16:9
<b>Contrast ratio</b>	3000:1
<b>Viewing angle</b>	Horizontal — 178° Vertical — 178°
<b>Interface</b>	AUDIO OUT, HDMI, VGA
<b>Built-in speaker</b>	No
<b>Power consumption in operating mode</b>	30 W
<b>Power consumption in standby mode</b>	0,5 W
<b>VESA Mount Standard</b>	75 × 75
<b>Dimensions (W × D × H)</b>	492 × 189 × 361 mm
<b>Net weight</b>	2,3 kg
<b>Power adapter specifications</b>	Input: 100–240 V ~ 50–60 Hz Output: 12 V = 2,5 A
<b>Power supply</b>	12 V = 2,5 A
<b>Protection class (device)</b>	III
<b>Protection class (adapter)</b>	II
<b>Cord type</b>	X
<b>IP code</b>	IP20
<b>Scope of application</b>	Domestic
<b>Package Contents</b>	Monitor, power adapter, HDMI cable, cable clip, cleaning cloth, stand, user manual

# Device Diagram

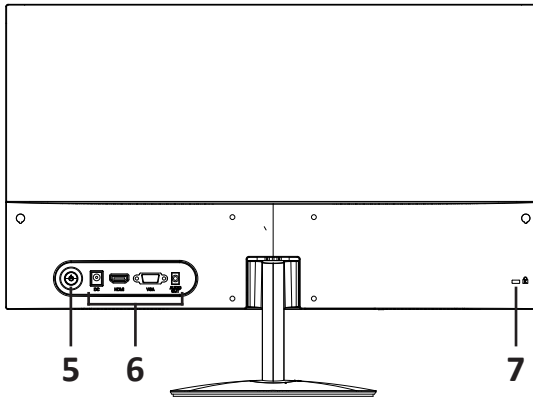
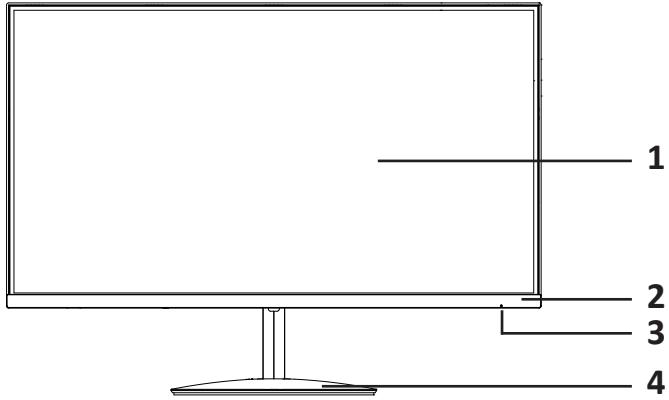

1. Screen.
2. Frame.
3. Power Indicator:
  - Off: No power.
  - On: The device is operating normally.
  - Flashing: No signal detected.
4. Stand.
5. Joystick / Control button.
6. Interface.
7. Kensington security lock slot.

# Interface

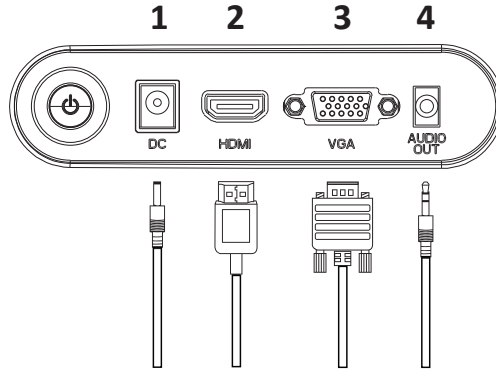

1. Power Connection.
2. Signal Source Connection (HDMI).
3. Signal Source Connection (VGA).
4. Audio Output Connection.

## Operating Instructions

### Monitor Connection

1. Ensure that both the monitor and the PC are disconnected from the power source.
2. Connect the HDMI or VGA cable to the corresponding port on the monitor, and the other end to the port on your computer’s graphics card.
3. To connect the monitor to the power source, plug the power cord into the power outlet and the other end into the monitor’s DC power input.

### Joystick / Control Button Functions

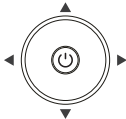
<p><b>Press the button</b></p>	<ul style="list-style-type: none"> <li>• Hold for 3–5 seconds to turn the monitor on/off</li> <li>• When the monitor is on, press briefly to open the OSD menu</li> <li>• In the OSD menu, press briefly to select an option / confirm the selected value</li> </ul>
<p><b>OSD Menu Navigation</b></p>	<p>In the OSD menu, move the joystick up/down/left/right to navigate between options. When adjusting a setting, move the joystick left/right to decrease/increase the value of the selected option accordingly</p>
<p><b>Quick Access</b></p> 	<ul style="list-style-type: none"> <li>• Joystick Left: Enter ECO mode</li> <li>• Joystick Right: Select input source</li> <li>• Joystick Up: Adjust brightness</li> <li>• Joystick Down: Enable Game mode</li> </ul>

# Maintenance and Care

To clean the screen and frame, use only a soft, dry cloth. Do not use liquids or chemicals.

## Troubleshooting Guide

The monitor does not turn on / No power	Check the power connection. Ensure the power cord is securely connected
	Check if the power cord is damaged. Replace it if necessary
The monitor is overheating	When installing the monitor, maintain the clearances specified in the «Monitor Placement» section of this manual to ensure adequate air circulation around the device
Dark/bright spots on the display when powering on	This is normal. This effect is caused by uneven back-light illumination during startup due to temperature differences. The dark/bright spots will disappear after the monitor has been operating for 20 minutes
Vertical and horizontal lines on the display	Set a refresh rate that is supported by the monitor on your PC
Power is supplied, but no image appears	Ensure the cables are securely connected
	Check the graphics card connection
	Check for damage to the monitor ports and cable connectors
	Adjust brightness and contrast
Color distortion / Black and white image	Make sure the monitor port and video cable connector are not damaged. Replace the cable if necessary
	Ensure that the graphics card is firmly seated in the motherboard slot
	Adjust brightness and contrast

**Note:** If the above solutions do not resolve the issue, discontinue use of the monitor and contact an authorized service center.

## Rules and Conditions for Installation, Storage, Transportation, Sale (Distribution), and Disposal

- The installation and mounting conditions for the device are described in the “Assembly and Placement ” section of this user manual.
- The device must be stored in its original packaging, on heated premises, both at the manufacturer’s and at the consumer’s sites. The ambient temperature should be between +5 °C and +40 °C, and the relative humidity should not exceed 80% (non-condensing). The storage area must be free from aggressive contaminants (e.g., acid or alkali vapors) that could cause corrosion.
- The device must be transported in a dry place.
- The device requires careful handling. Protect it from exposure to dust, dirt, impact, moisture, fire, and other hazards.
- Sale or distribution of the device must be carried out in accordance with local legislation.
- Upon expiration of the device’s service life, it must not be disposed of with unsorted household waste. Instead, it must be taken to an authorized collection point for electrical and electronic equipment for subsequent recycling and disposal in accordance with federal or local legislation. By ensuring proper disposal of this product, you help conserve natural resources and prevent potential harm to the environment and human health that may result from improper handling. For more detailed information about collection and disposal points for this product, please contact your local municipal authorities or your household waste disposal service.
- If a device malfunction is detected, immediately contact an authorized service center or dispose of the device.

## Warranty Information

The manufacturer guarantees the device will function properly throughout the warranty period and be free from defects in materials and assembly. The warranty period commences on the date of purchase and applies to new products only. Warranty service includes free repair or replacement of defective parts that fail during the warranty period, provided the failure is not caused by consumer misuse and the product is operated in accordance with the user manual. Repairs or part replacements shall be performed at authorized service centers.

**Warranty Period:** 36 months

**Service Life:** 48 months

**For the up-to-date list of authorized service centers, please visit:** <https://www.dns-shop.ru/service-center/>

## Additional Information

**Manufacturer:** Yibin Jiaxin Electronic Technology Co., Ltd.  
No.136, West Section of Xinggang Road, Lingang Economic Development Zone, Yibin City, Sichuan Province, China.

Made in China.

The product meets the requirements of the CU TR (EAEU).

Product specifications, information and appearance are subject to change without prior notice, for quality improvement of our products.



Production date (mm.yyyy): \_\_\_\_\_ V.1

