

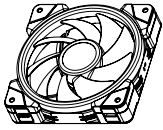

## Parts List



A x 3



B x 3

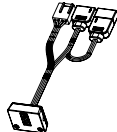

C x 3



D x 12



E x 12



F x 1

## Installation Guide

### 1 Choose your fan blade type

**Standard Fan Blade** (Pre installed on the fan **A**)

Airflow Direction:  
**Air Exhaust**

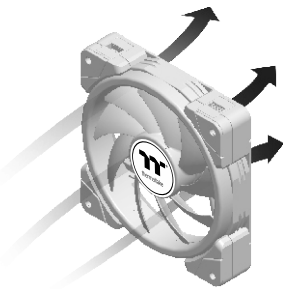
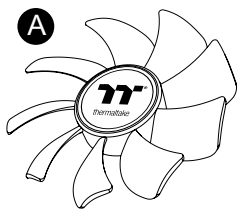

**Reverse Fan Blade**

Airflow Direction:  
**Air Intake**

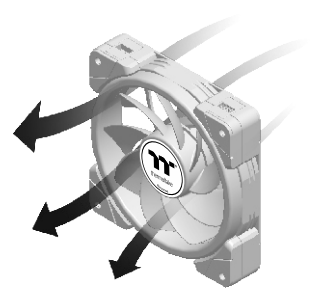
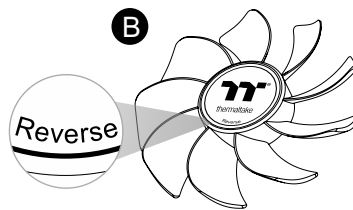

### 2 Replace fan blades

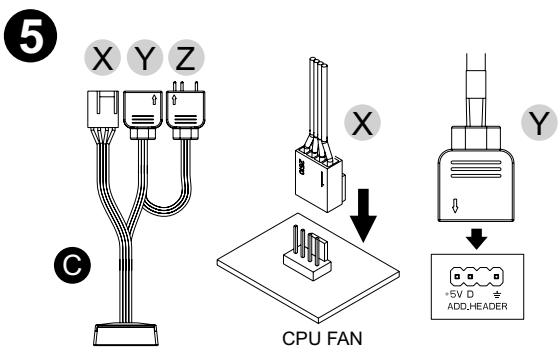
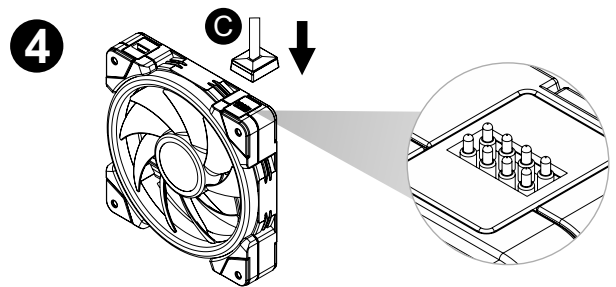
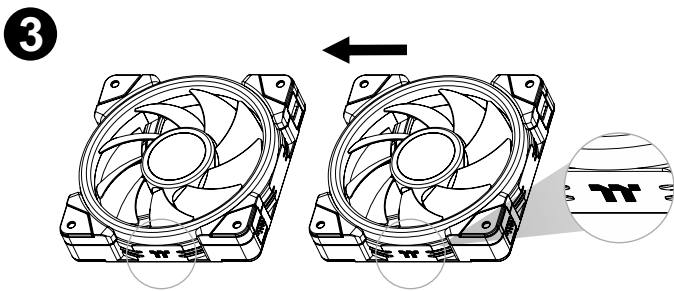
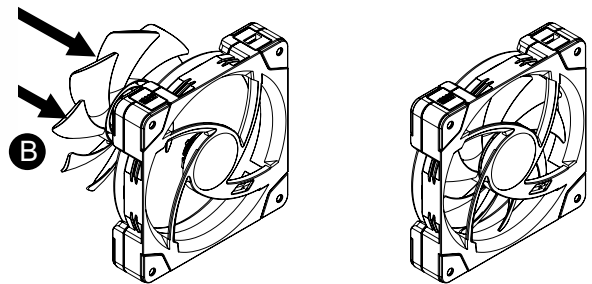
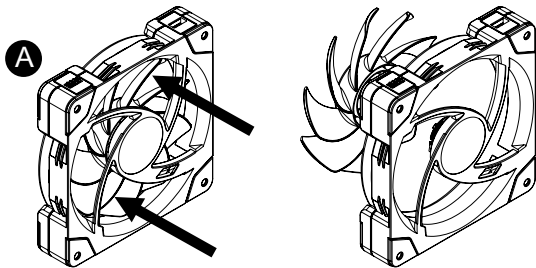

**CAUTION**  
Please power off the PC and check the Positive and Negative ends on the connector before connecting the cable to mainboard. Connecting the wrong end can damage the fans.

### Oil Setup Guide

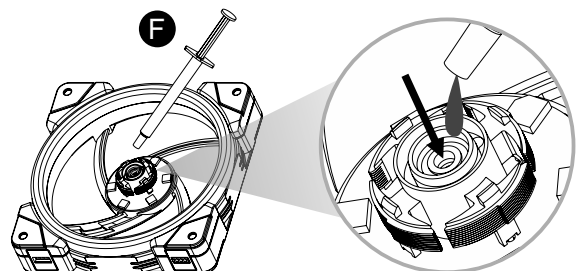

After replacing the fan blades several times, read the oil into the bearing (about 0.1ml)