

PRO X SUPERLIGHT 2 DEX

SETUP GUIDE | GUIDE D'INSTALLATION

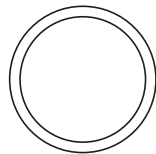

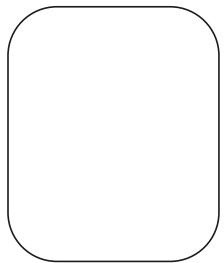
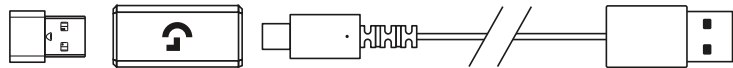
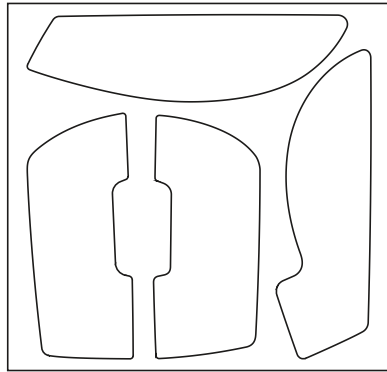
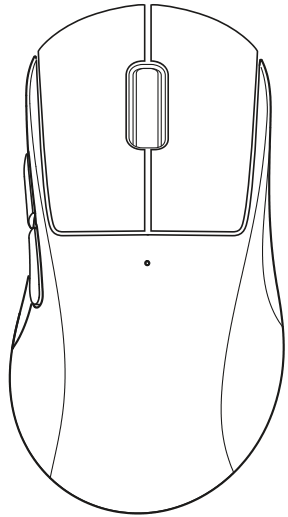

ENGLISH	3
FRANÇAIS.	10
ESPAÑOL	17
PORTUGUÊS	24

PACKAGE CONTENTS

- 1 Mouse
- 2 Optional grip tape
- 3 Receiver (installed in extension adapter)
- 4 USB charging and data cable
- 5 Surface preparation cloth
- 6 Optional POWERPLAY aperture door with PTFE foot

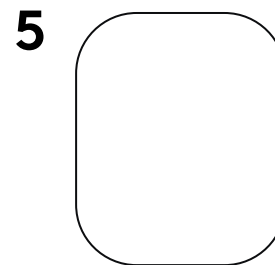
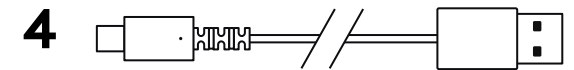
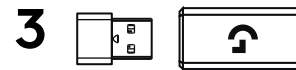
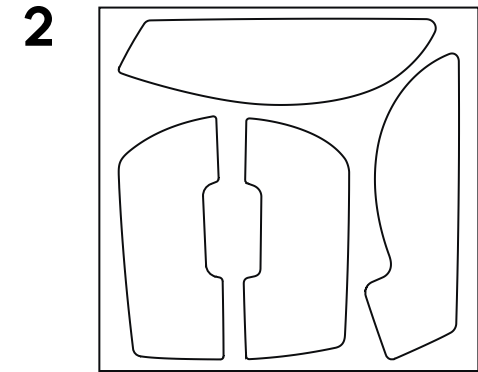
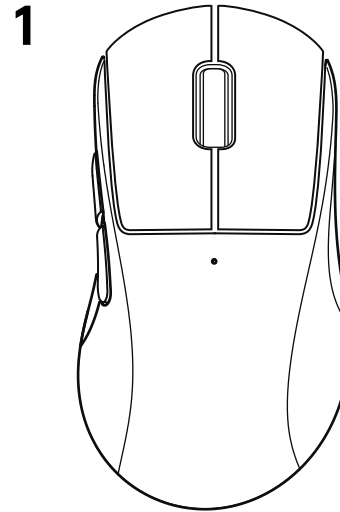

MOUSE FEATURES

- 1 Left Click
- 2 Right Click
- 3 Middle Click/Scroll
- 4 Browser Back
- 5 Browser Forward
- 6 Power LED
- 7 USB charging/data part
- 8 Power on/off
- 9 POWERPLAY Aperture door

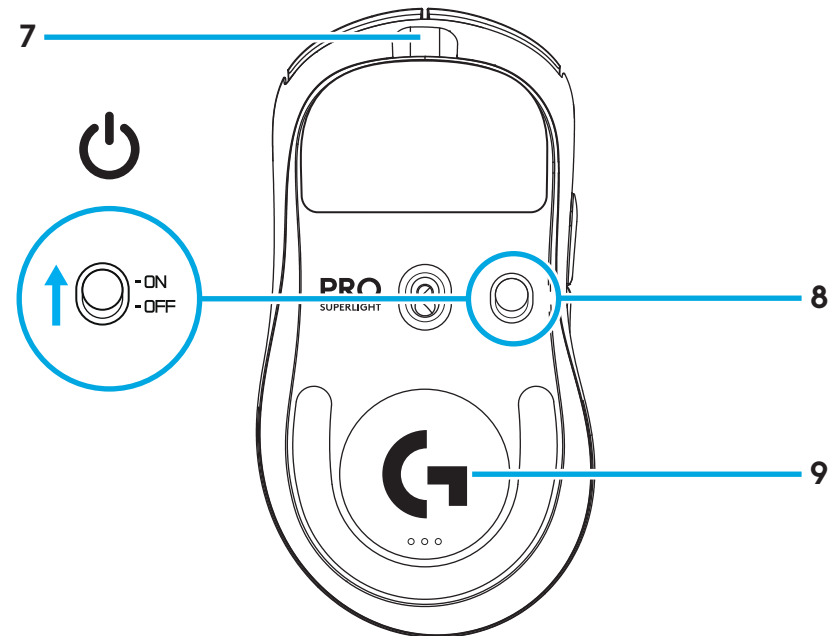
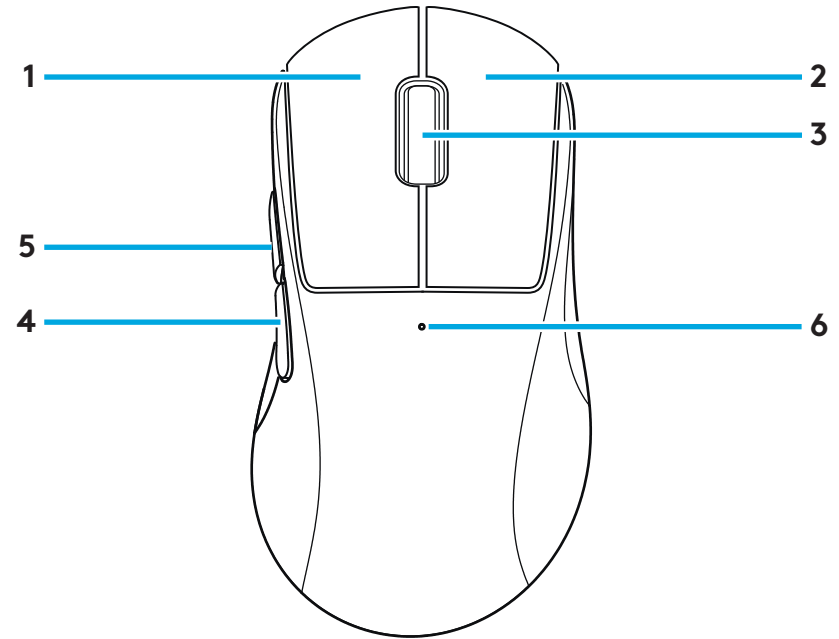

SETUP

- 1 Plug charging/data cable into PC, then plug extension adapter and receiver into charging/data cable

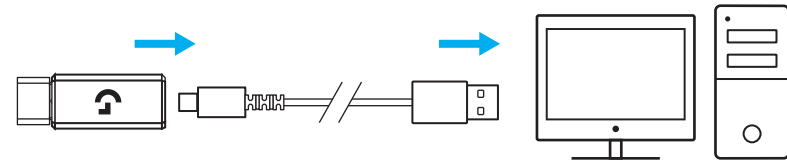

- 2 Turn on mouse

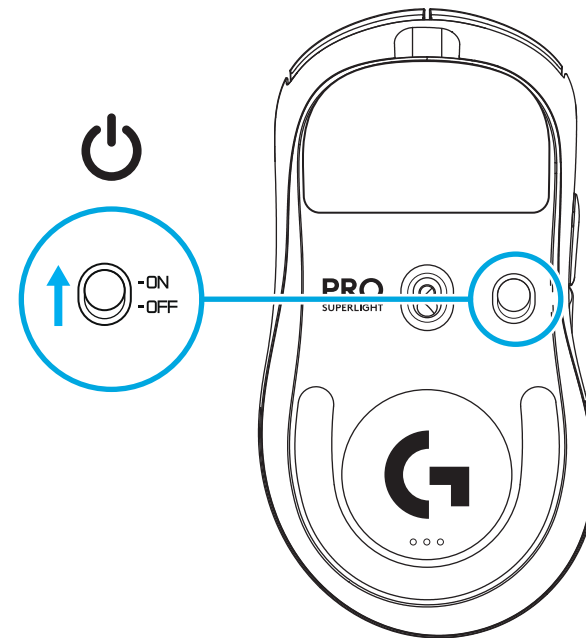

- 3** To configure mouse settings like DPI or report rate, download G HUB software from logitechG.com/GHUB

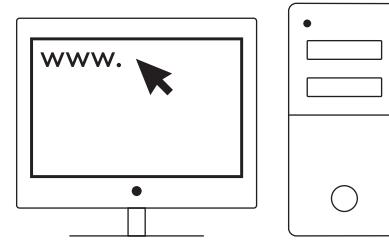

logitechG.com/ghub

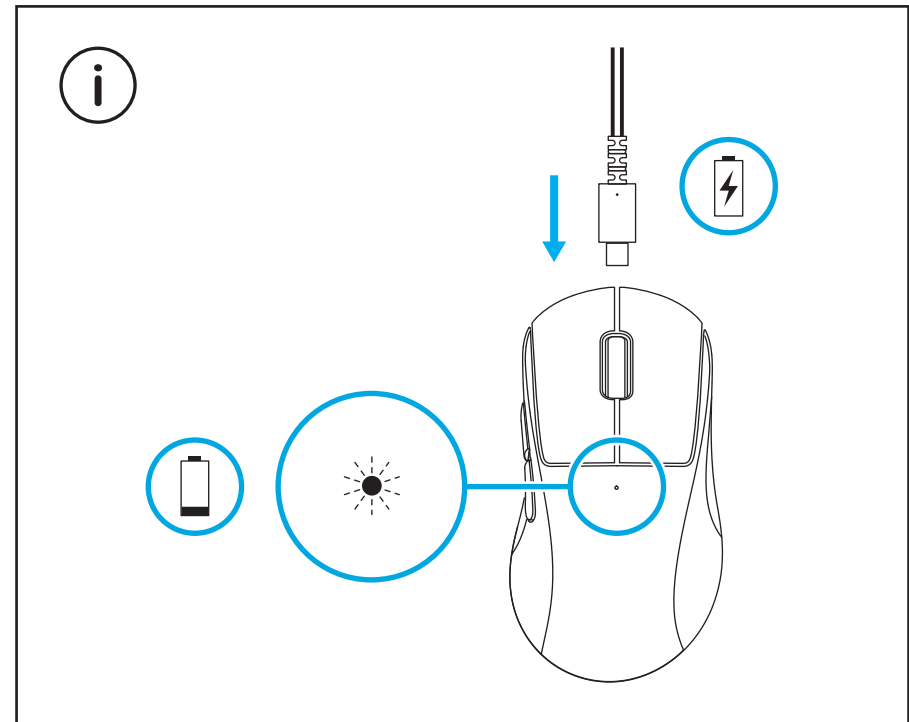

For optimal wireless performance, use mouse within 20cm of receiver and greater than 2m from sources of 2.4GHz interference (such as wifi routers).

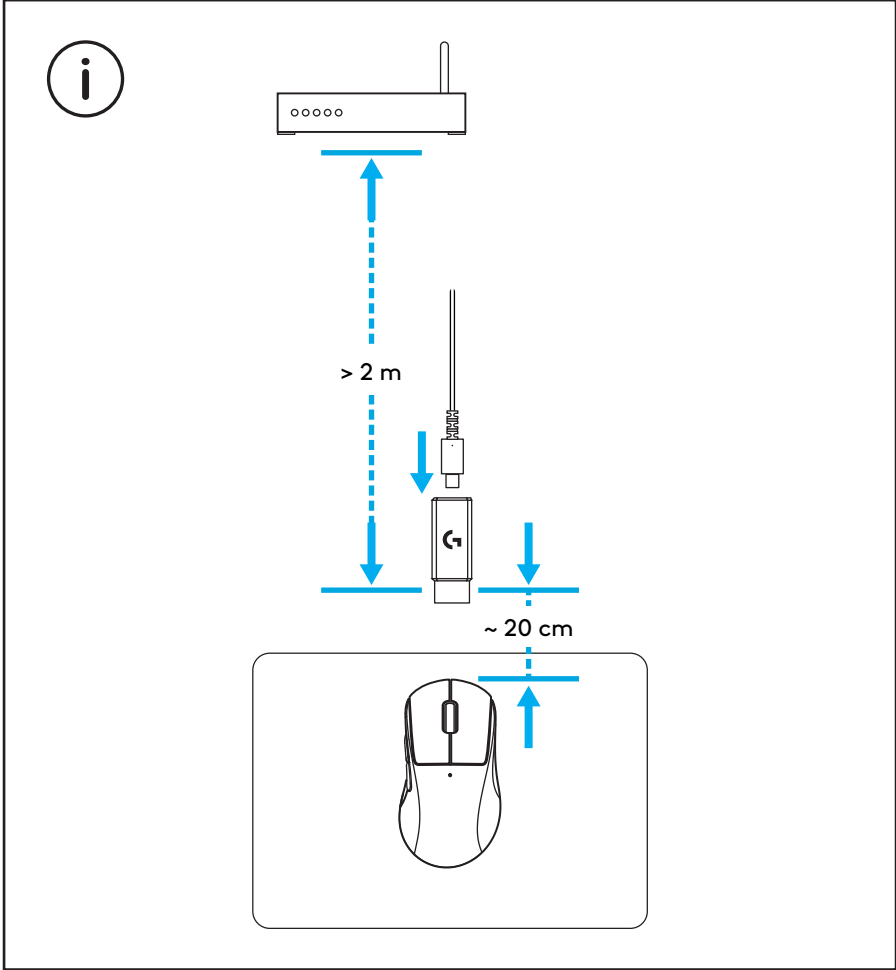

To install optional grip tape, first clean surface of mouse with provided surface preparation cloth to remove any oil or dust. Then, carefully align grip tape to mouse surfaces.

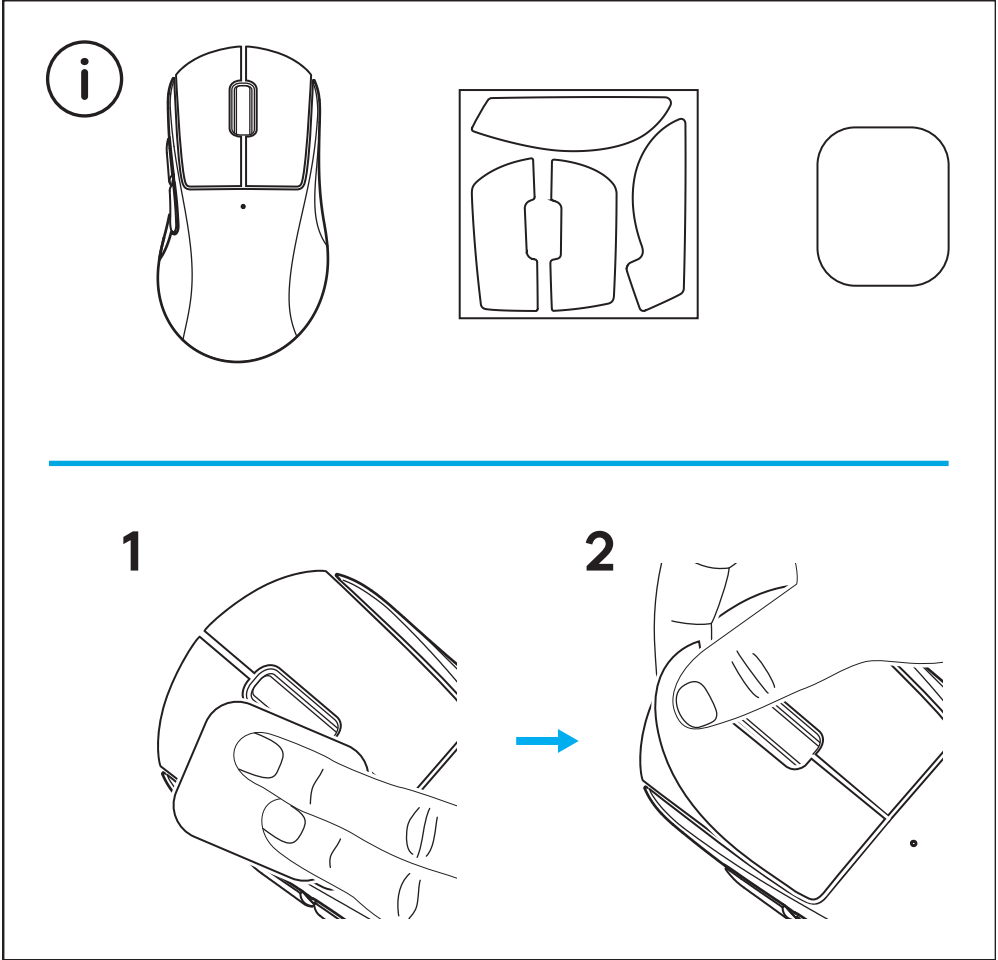

The USB receiver can be stored inside the mouse by removing the POWERPLAY aperture door. This can prevent the receiver from being lost when using the mouse with the Logitech G POWERPLAY wireless charging system.

Removing this door also allows the included, optional aperture door with PTFE foot to be installed instead of the default aperture door.

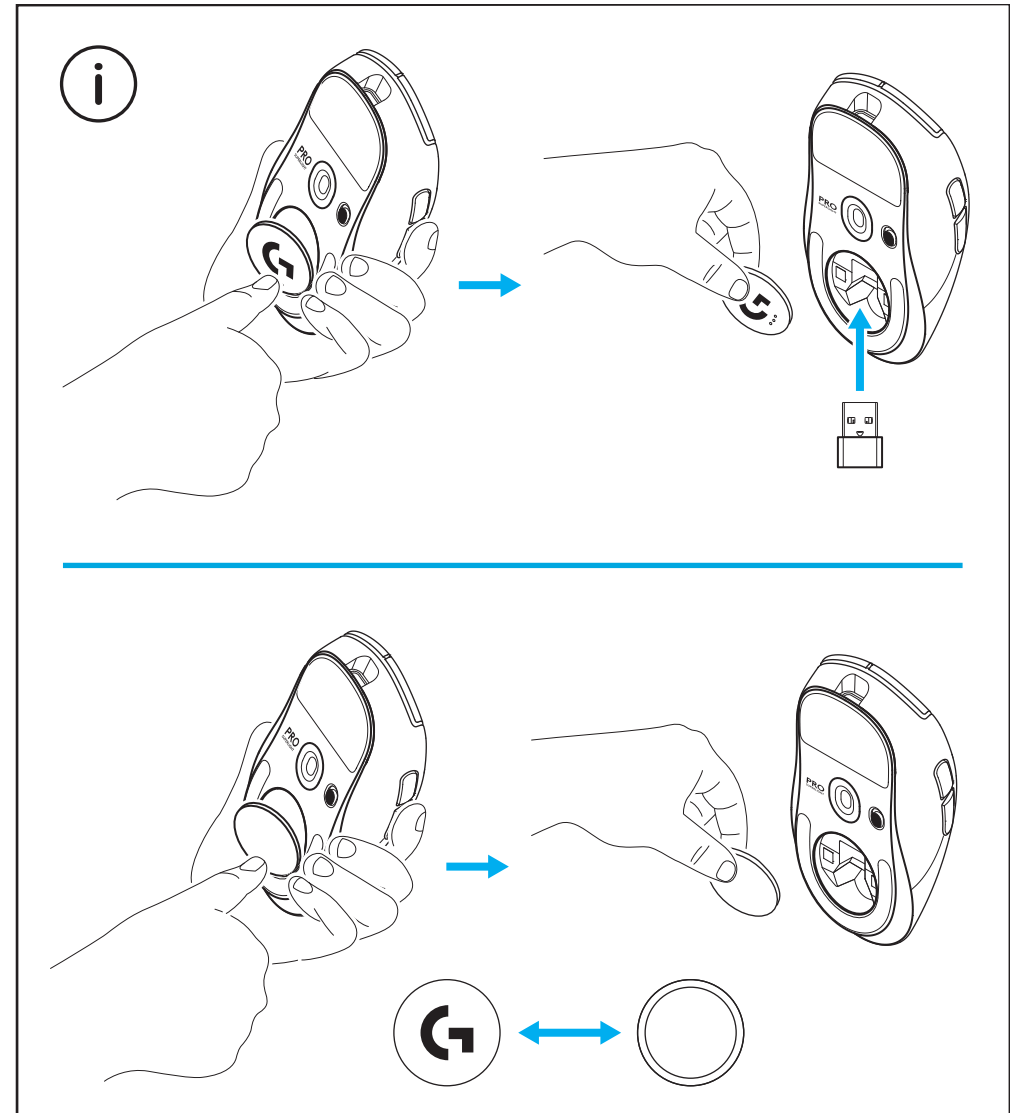

CONTENU DU COFFRET

- 1 Souris
- 2 Bande antidérapante optionnelle
- 3 Récepteur (installé dans l'adaptateur d'extension)
- 4 Câble de charge USB et câble de données
- 5 Tissu de préparation de la surface
- 6 Compartiment à ouverture optionnelle POWERPLAY avec patin PTFE

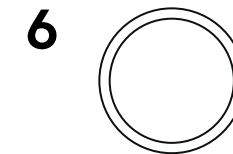
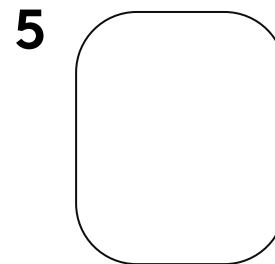
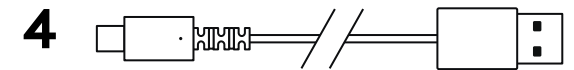
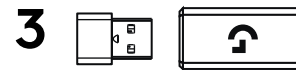
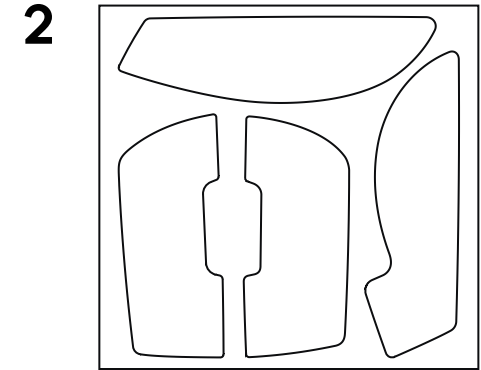
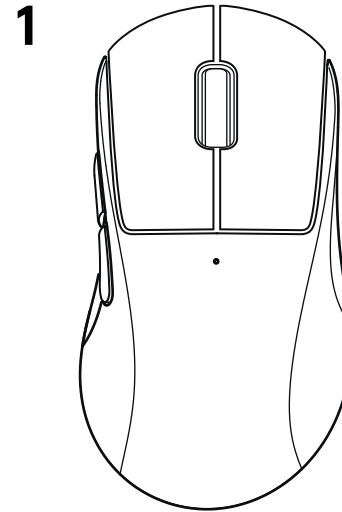

CARACTÉRISTIQUES DE LA SOURIS

- 1 Clic gauche
- 2 Clic droit
- 3 Clic central/roulette de défilement
- 4 Reculer d'une page dans le navigateur
- 5 Avancer d'une page dans le navigateur
- 6 Témoin d'alimentation
- 7 Port USB de charge/données
- 8 Marche/Arrêt
- 9 Compartiment d'ouverture POWERPLAY

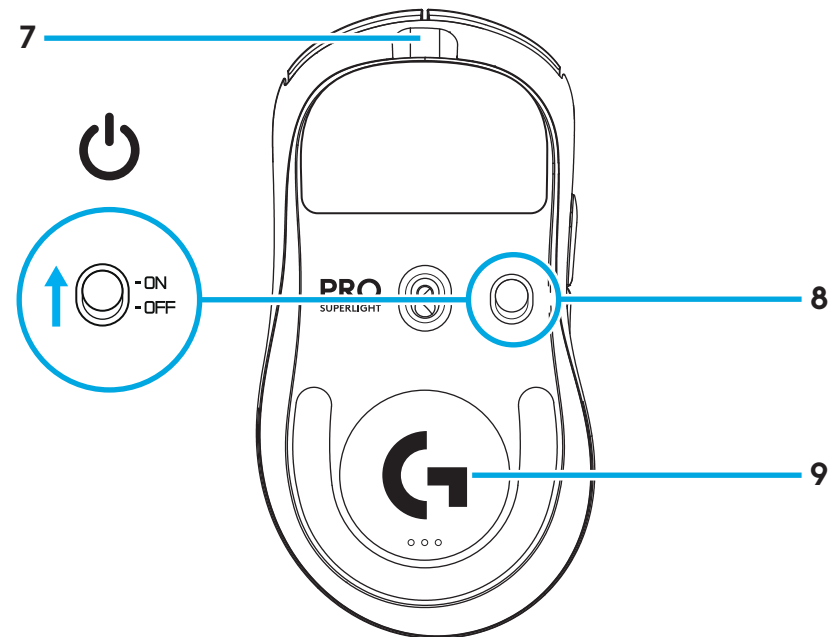
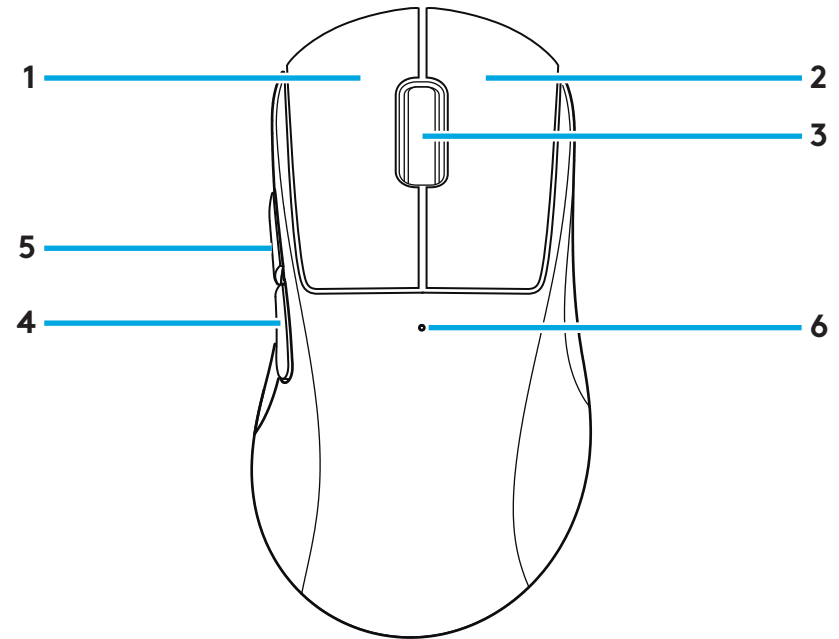

INSTALLATION

- 1 Connectez le câble de charge/données sur le PC, puis l'adaptateur d'extension et le récepteur au câble de charge/données

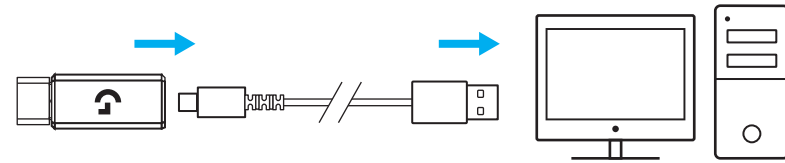

- 2 Allumez la souris

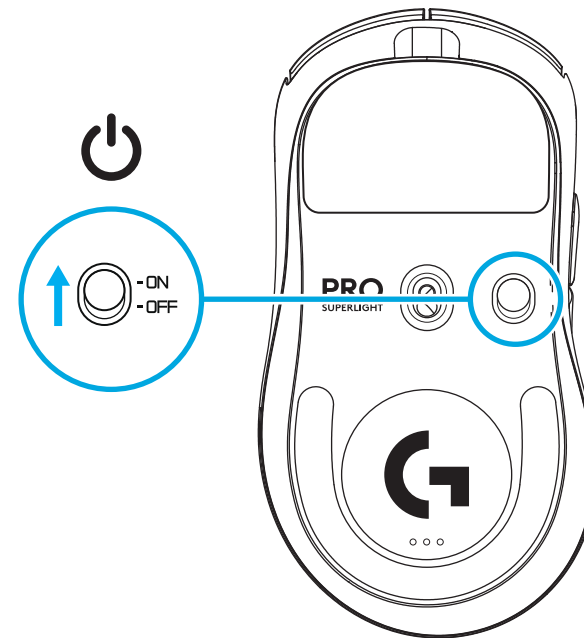

- 3** Pour configurer les paramètres de la souris, comme sa résolution ou son taux de rapport, téléchargez le logiciel G HUB à l'adresse logitechG.com/GHUB

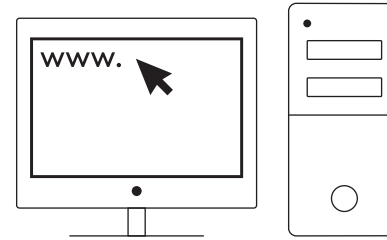

logitechG.com/ghub

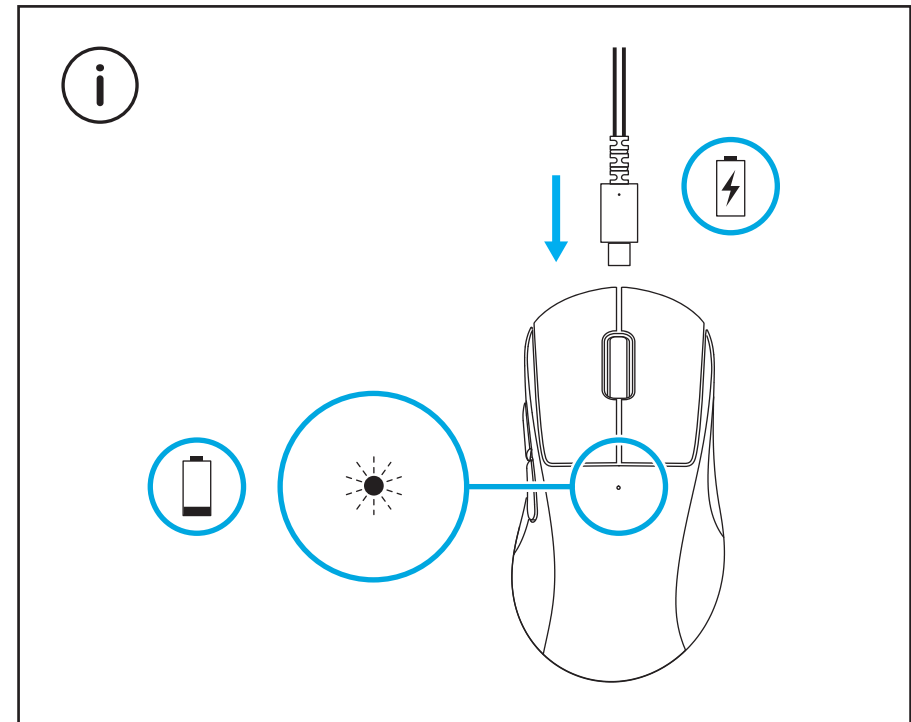

Pour bénéficier de performances optimales en mode sans fil, utilisez la souris dans un rayon de 20 cm autour du récepteur et à plus de 2 m des sources d'interférence à 2,4 GHz (notamment les routeurs Wi-Fi).

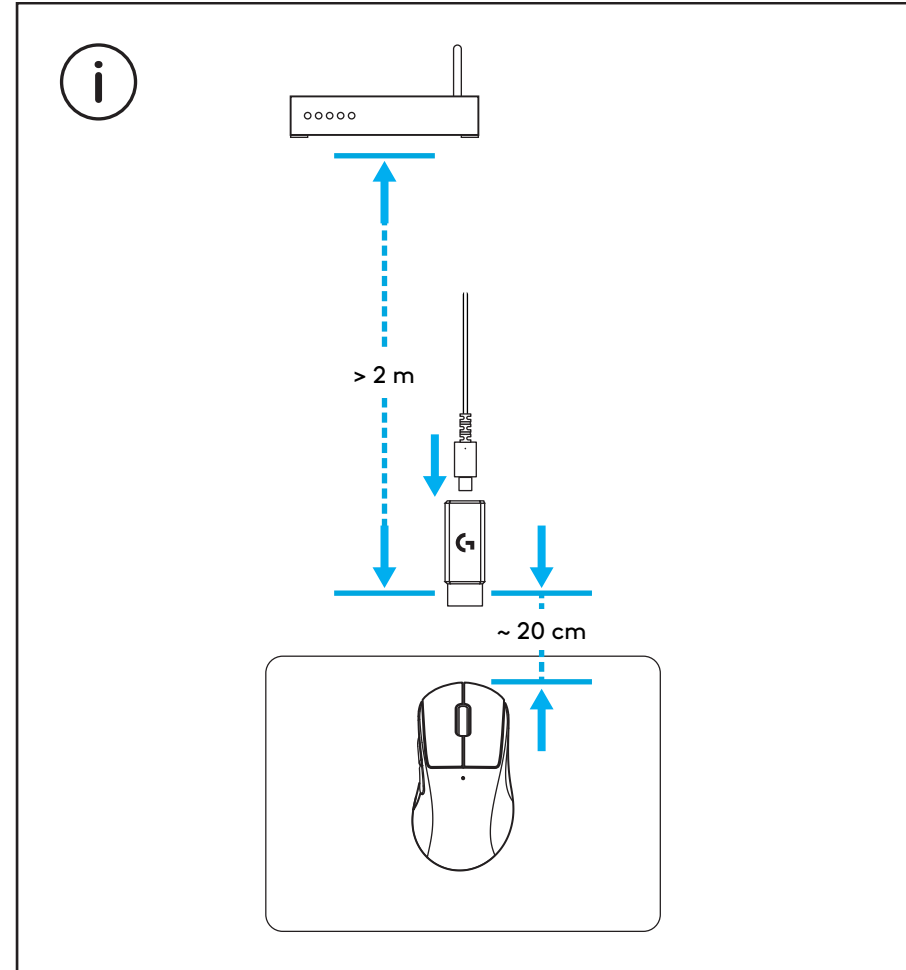

Pour installer la bande antidérapante optionnelle, commencez par nettoyer la surface de la souris avec le tissu de préparation de surface pour retirer tout résidu de graisse ou de poussière. Positionnez ensuite soigneusement la bande antidérapante sur les surfaces de la souris.

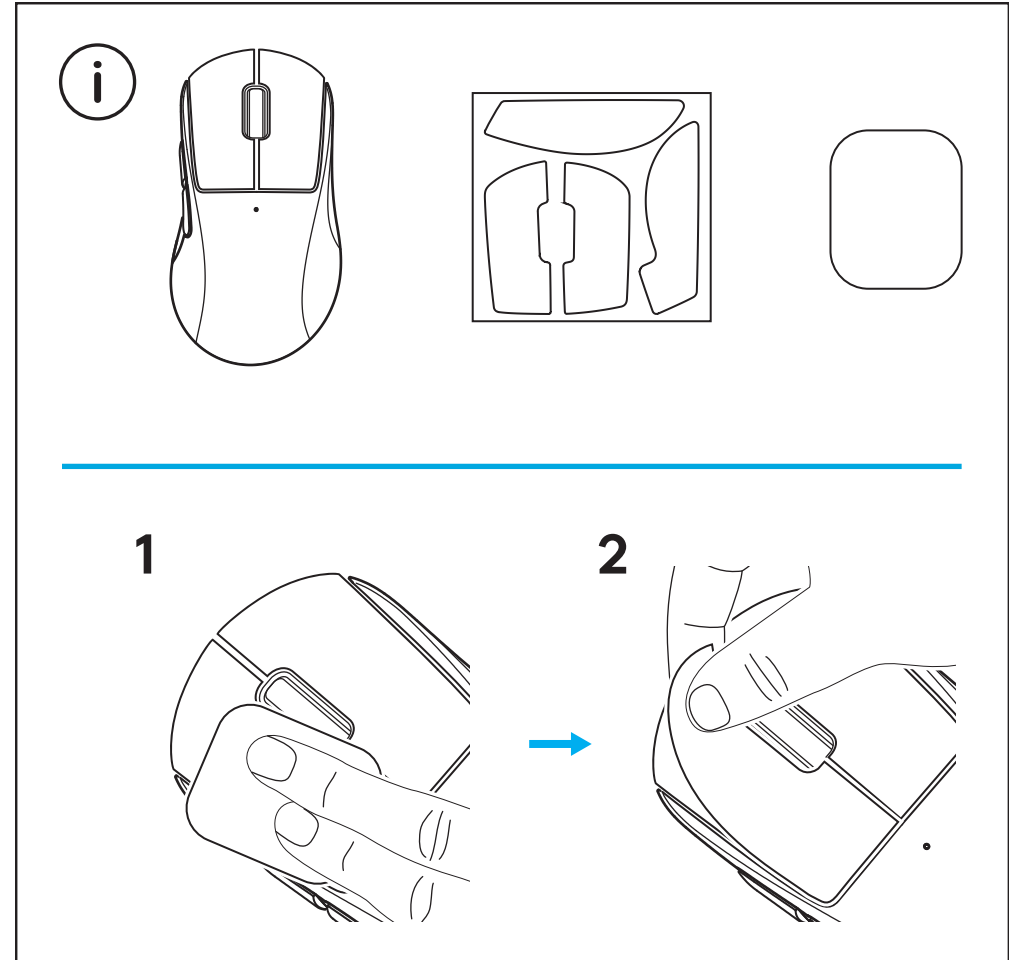

Le récepteur USB peut être stocké à l'intérieur de la souris en retirant le compartiment d'ouverture POWERPLAY. Cela permet d'éviter de perdre le récepteur lorsque la souris est utilisée avec le système de charge sans fil Logitech G POWERPLAY.

Retirer ce compartiment permet d'installer le compartiment à ouverture optionnelle avec patin PTFE au lieu du compartiment d'ouverture par défaut.

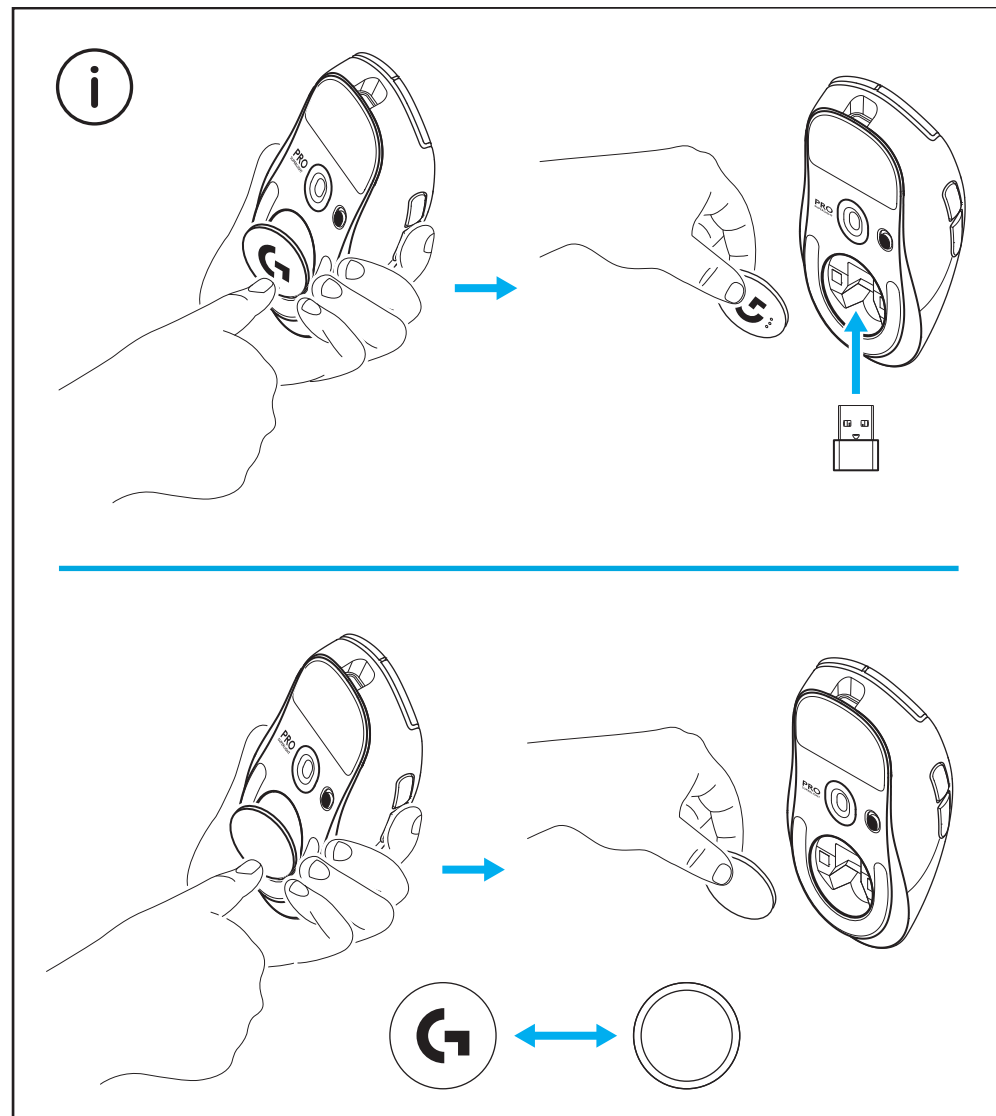

CONTENIDO DE LA CAJA

- 1 Mouse
- 2 Cinta de agarre opcional
- 3 Receptor (instalado en adaptador de extensión)
- 4 Cable de carga y datos USB
- 5 Paño de preparación de superficie
- 6 Puerta de apertura opcional POWERPLAY con pie de PTFE

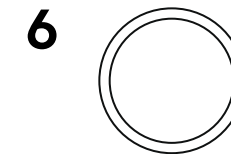
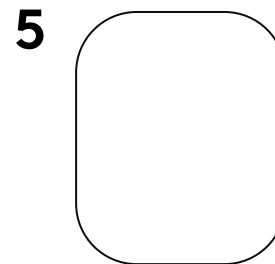
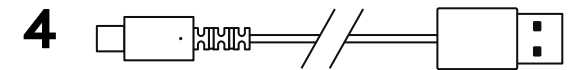
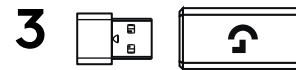
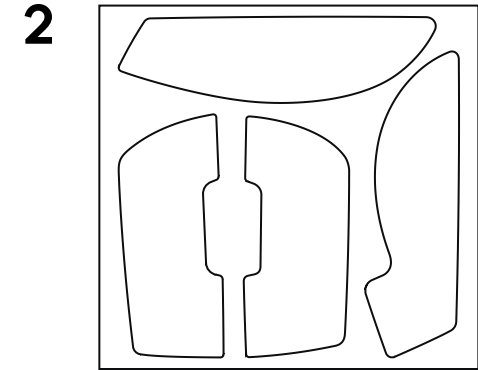
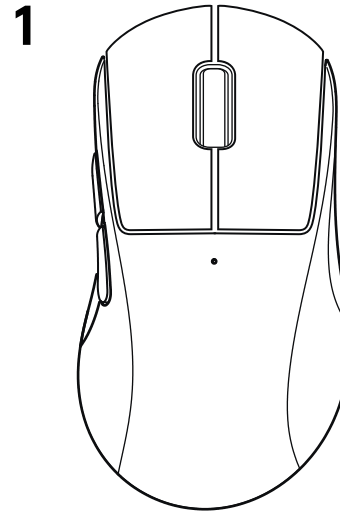

CARACTERÍSTICAS DEL MOUSE

- 1 Click de botón izquierdo
- 2 Click de botón derecho
- 3 Click de botón central/Desplazamiento
- 4 Retroceso en el navegador
- 5 Avance en el navegador
- 6 LED de encendido
- 7 Pieza USB de carga/datos
- 8 Encendido/apagado
- 9 Puerta de apertura POWERPLAY

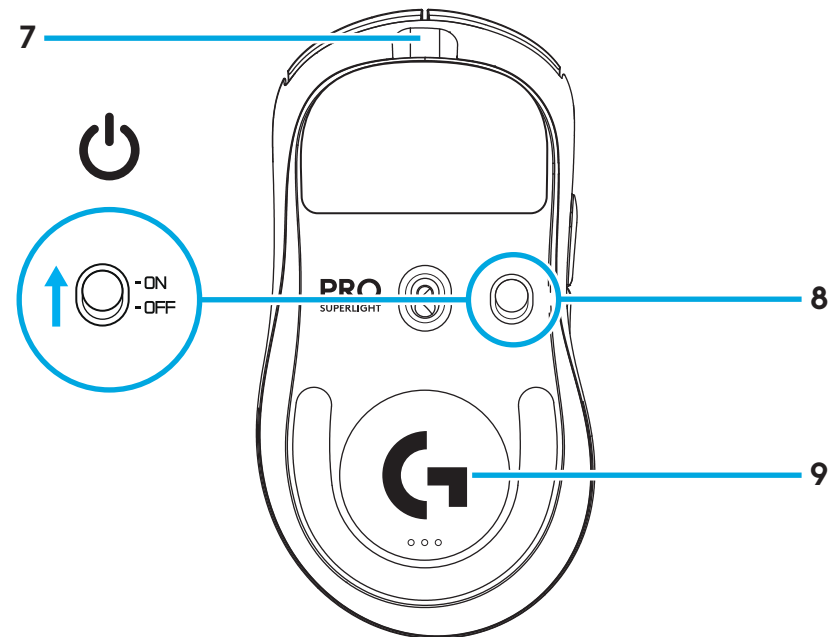
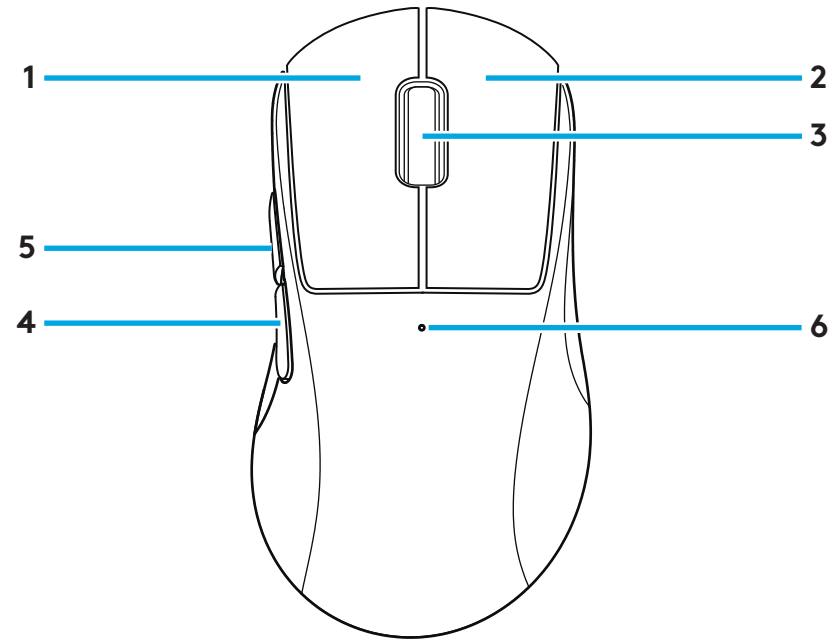

CONFIGURACIÓN

- 1 Conecta el cable de carga/datos a la PC, después conecta el adaptador de extensión y el receptor al cable de carga/datos

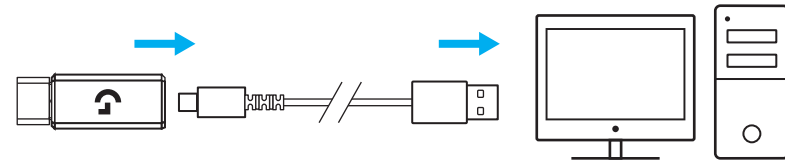

- 2 Enciende el mouse

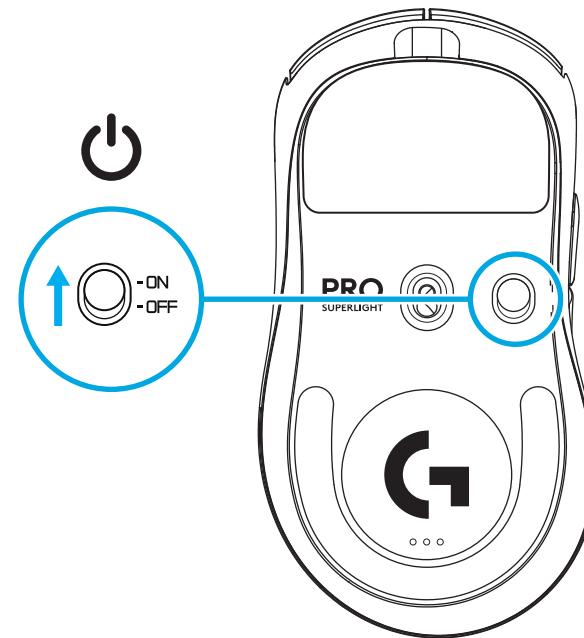

- 3** Para configurar las opciones del mouse, como el valor del DPI o la velocidad de respuesta, descarga el software G HUB en logitechG.com/GHUB

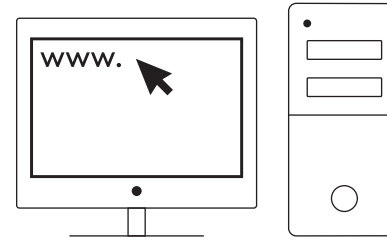

logitechG.com/ghub

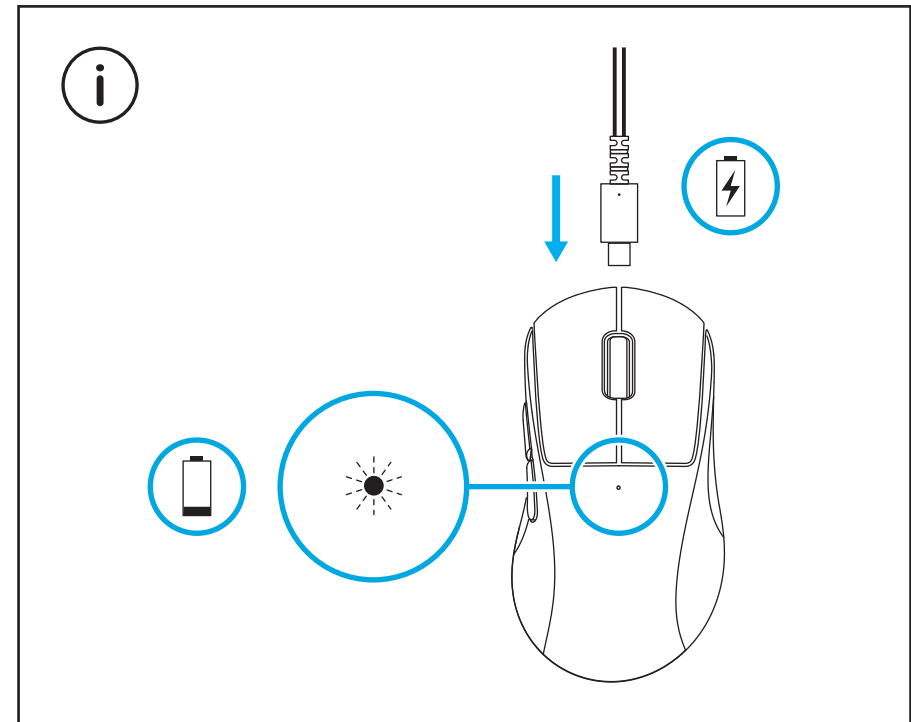

Para un óptimo rendimiento inalámbrico, usa el mouse a menos de 20 cm del receptor y a más de 2 metros de fuentes de interferencias de 2,4 GHz (como enrutadores wifi).

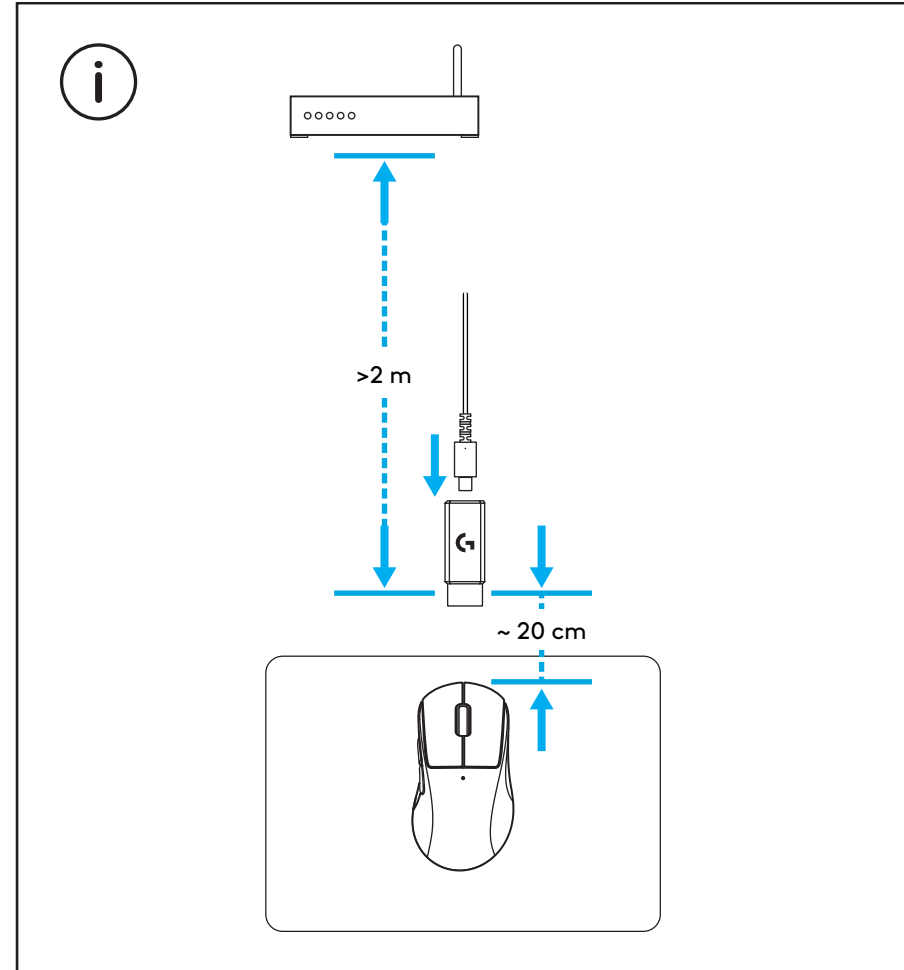

Para instalar la cinta de agarre opcional, limpia primero la superficie del mouse con el paño de preparación de superficie suministrado para eliminar posibles residuos de grasa o polvo. Luego, alinea con cuidado la cinta de agarre con las superficies del mouse.

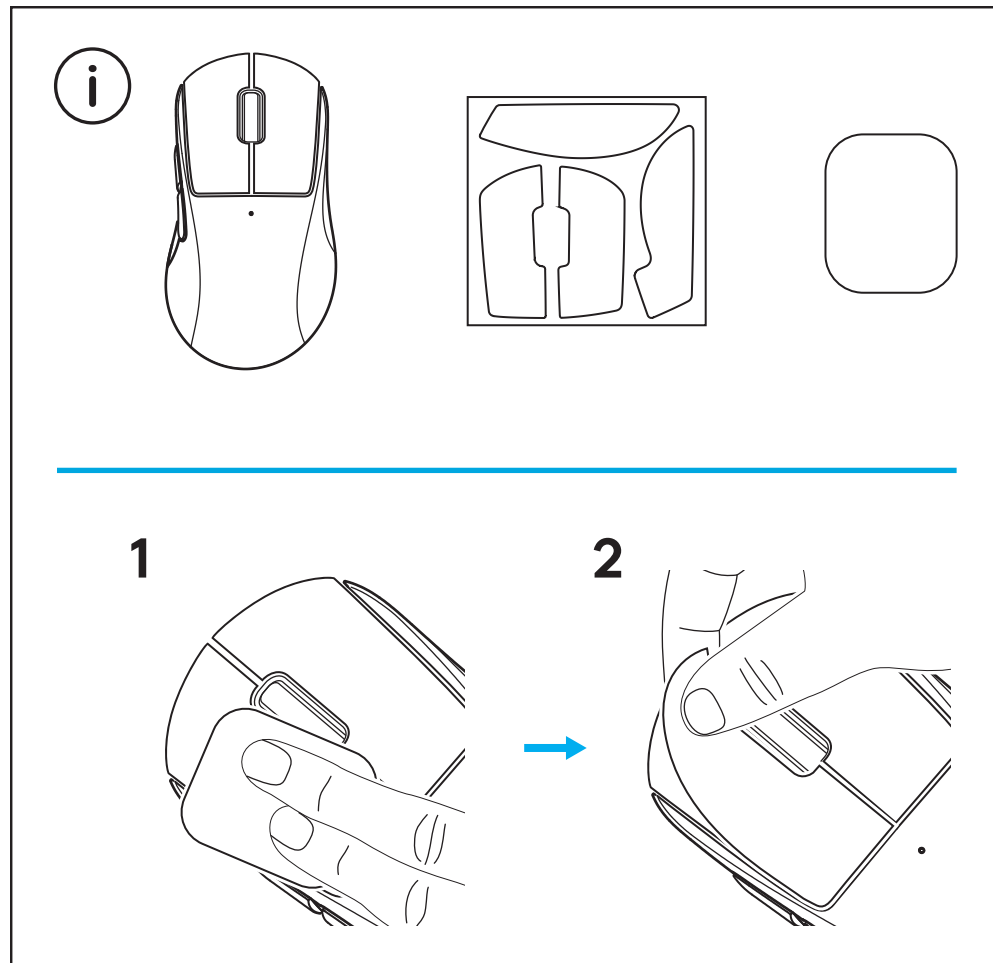

El receptor USB se puede guardar en el interior del mouse si retiras la puerta de apertura POWERPLAY. Esto puede impedir la pérdida del receptor cuando se usa el mouse con el sistema inalámbrico de carga Logitech G POWERPLAY.

Retirar esta puerta también permite instalar la puerta de apertura opcional con pie de PTFE, incluida, en lugar de la puerta de apertura predeterminada.

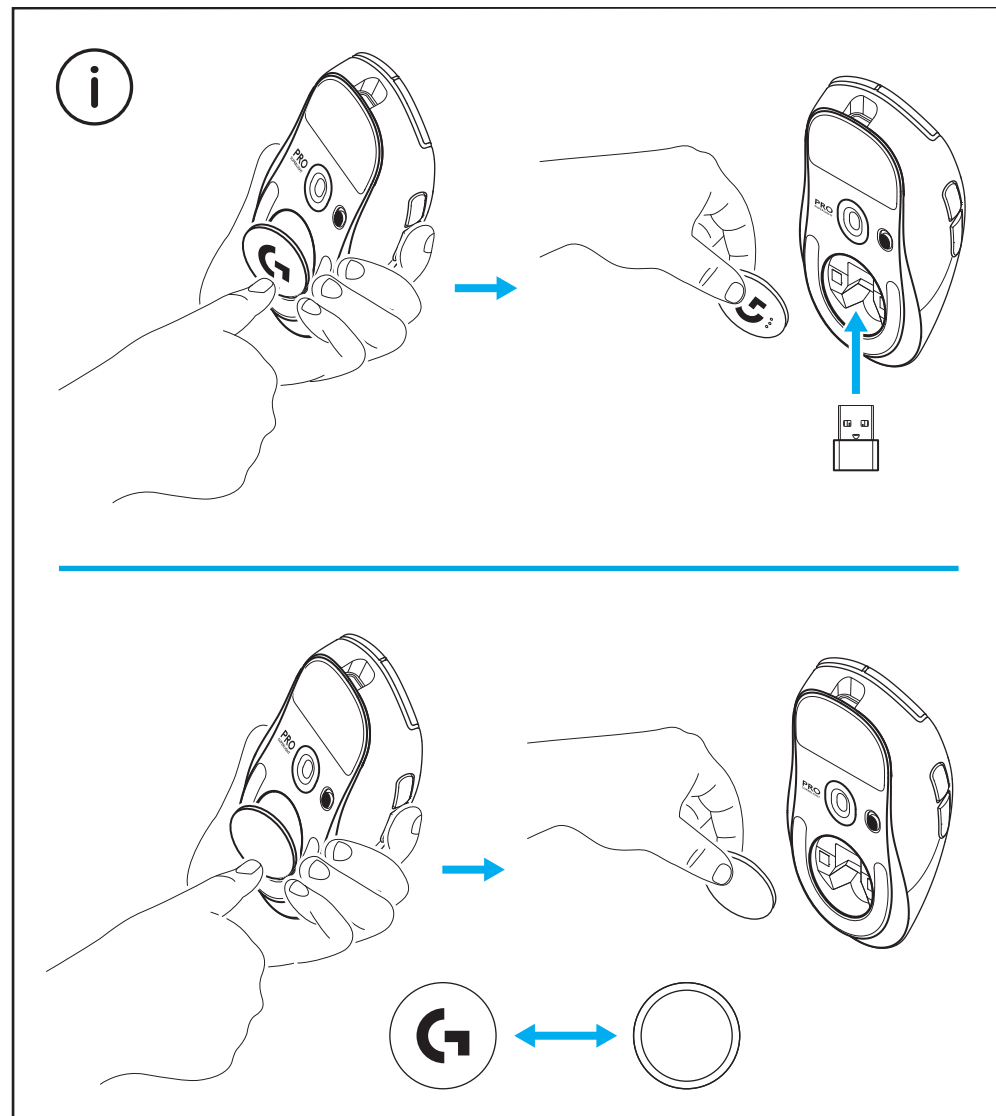

CONTEÚDO DA EMBALAGEM

- 1 Mouse
- 2 Adesivo antideslizante opcional
- 3 Receptor (instalado no adaptador de extensão)
- 4 Cabo USB de dados e carregamento
- 5 Pano de preparação de superfície
- 6 Porta de abertura opcional POWERPLAY com pé de PTFE

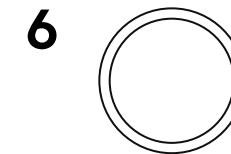
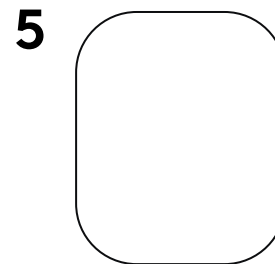
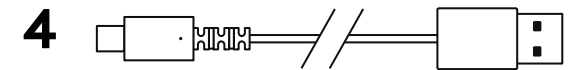
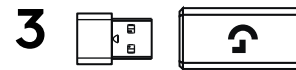
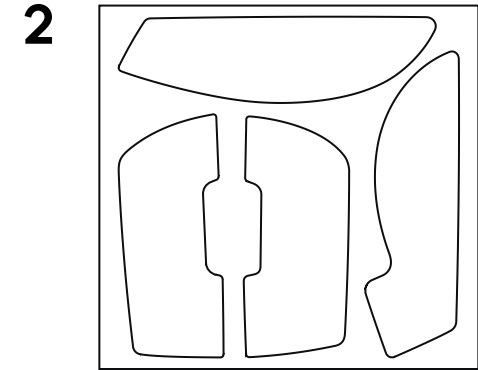
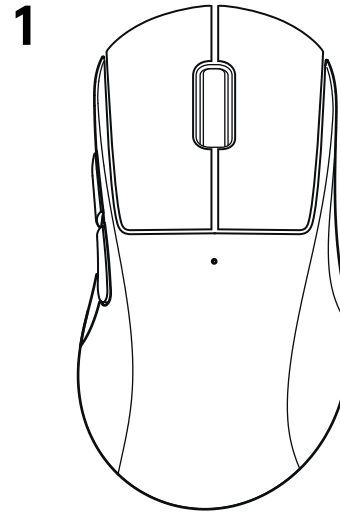

RECURSOS DO MOUSE

- 1 Botão esquerdo
- 2 Botão direito
- 3 Clique do meio/rolagem
- 4 Navegar para trás
- 5 Navegar para frente
- 6 LED de energia
- 7 Porta USB de carregamento/dados
- 8 Ligar/desligar
- 9 Porta de abertura POWERPLAY

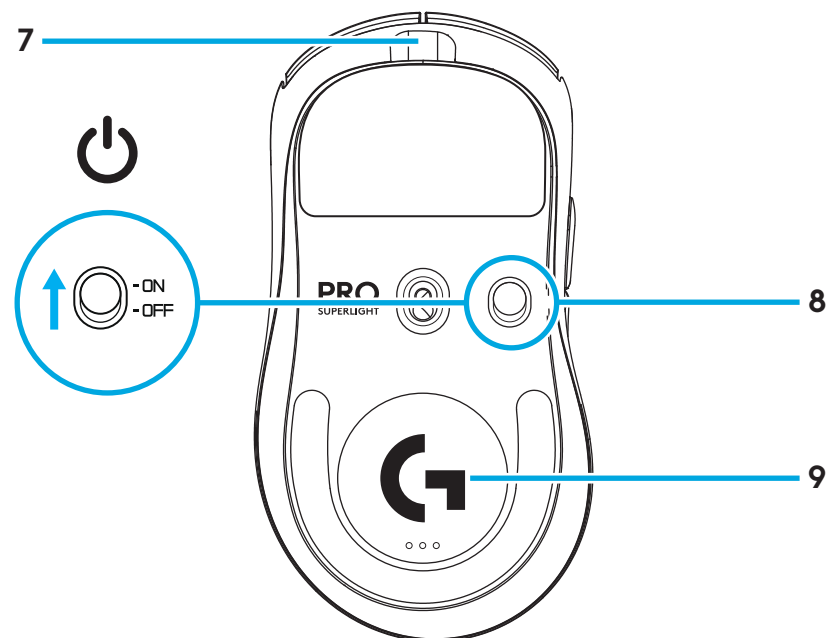
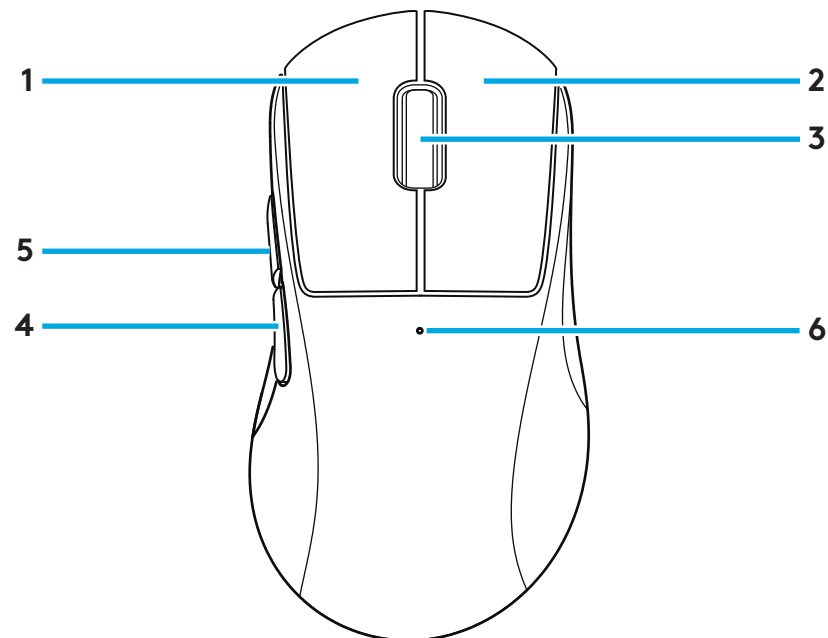

CONFIGURAÇÃO

- 1 Conecte o cabo de dados/carregamento no computador e, em seguida, conecte o adaptador de extensão e o receptor ao cabo de dados/carregamento

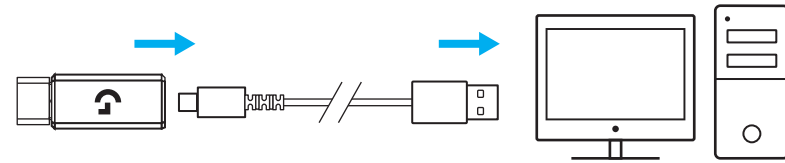

- 2 Ativar mouse

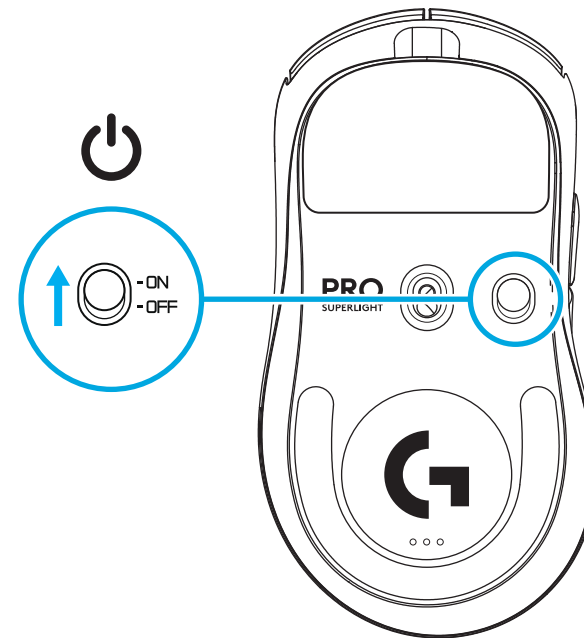

- 3** Para definir as configurações do mouse, como DPI ou taxa de transmissão, baixe o software G HUB em logitechG.com/GHUB

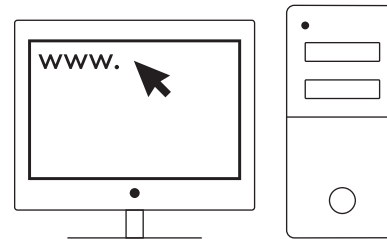

logitechG.com/gHub

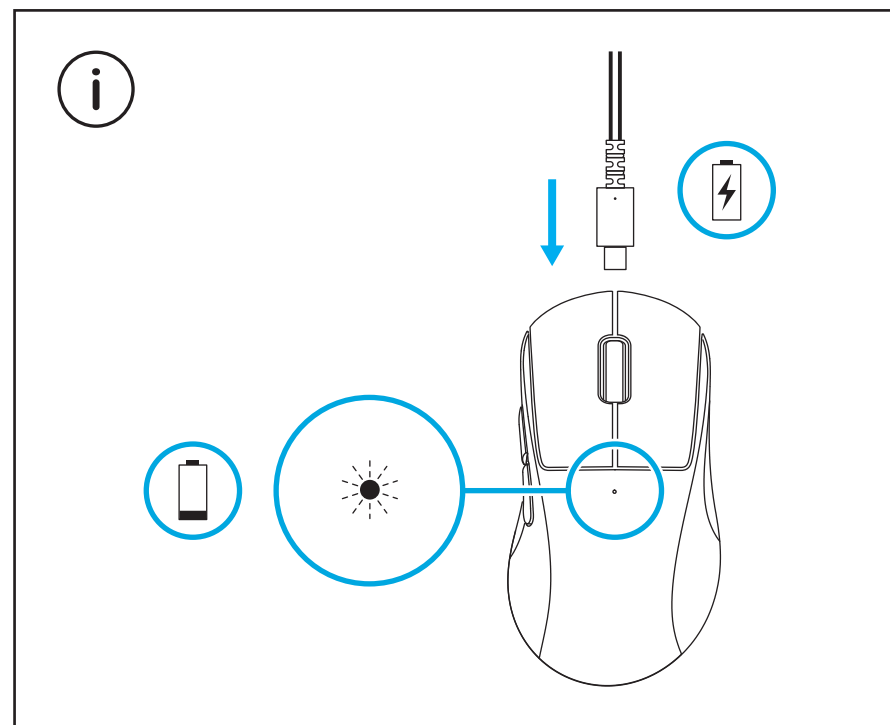

Para obter um desempenho sem fio, use o mouse a menos de 20 cm do receptor e mais do que 2 m das fontes de interferência de 2,4 GHz (como roteadores de Wi-Fi).

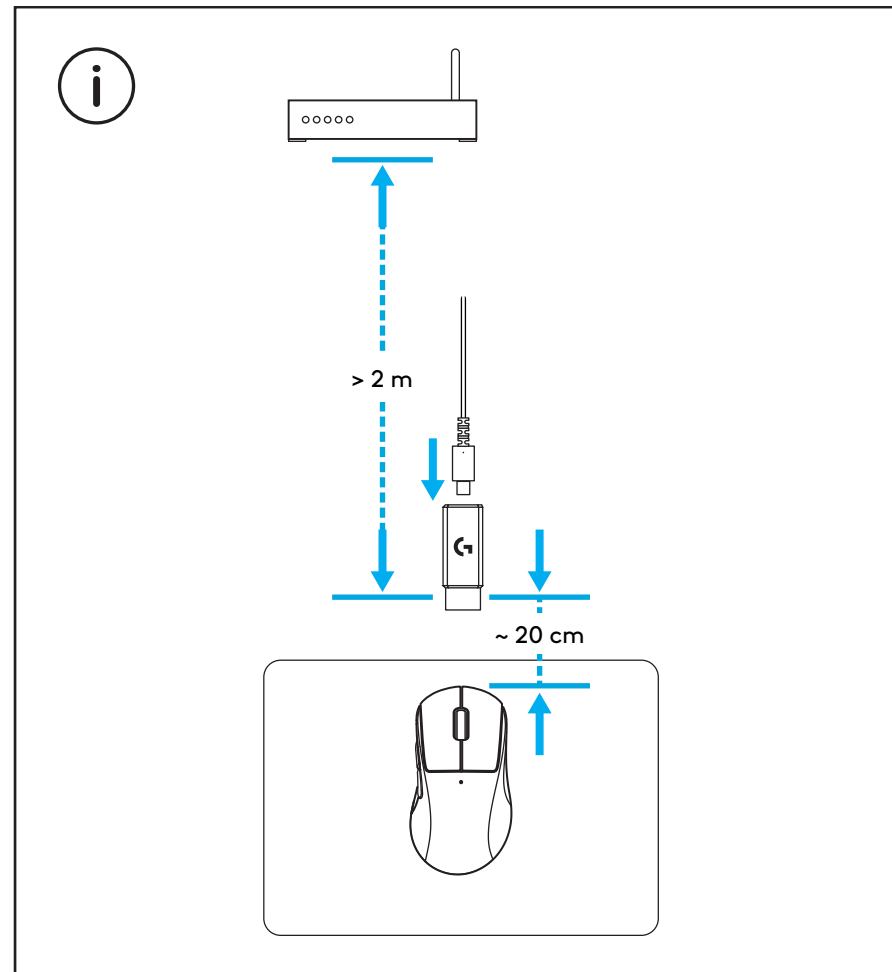

Para instalar uma fita de adesão opcional, limpe primeiro a superfície do mouse com o pano de preparação de superfície fornecida para remover oleosidade ou poeira. Em seguida, alinhe com cuidado a fita de adesão às superfícies do mouse.

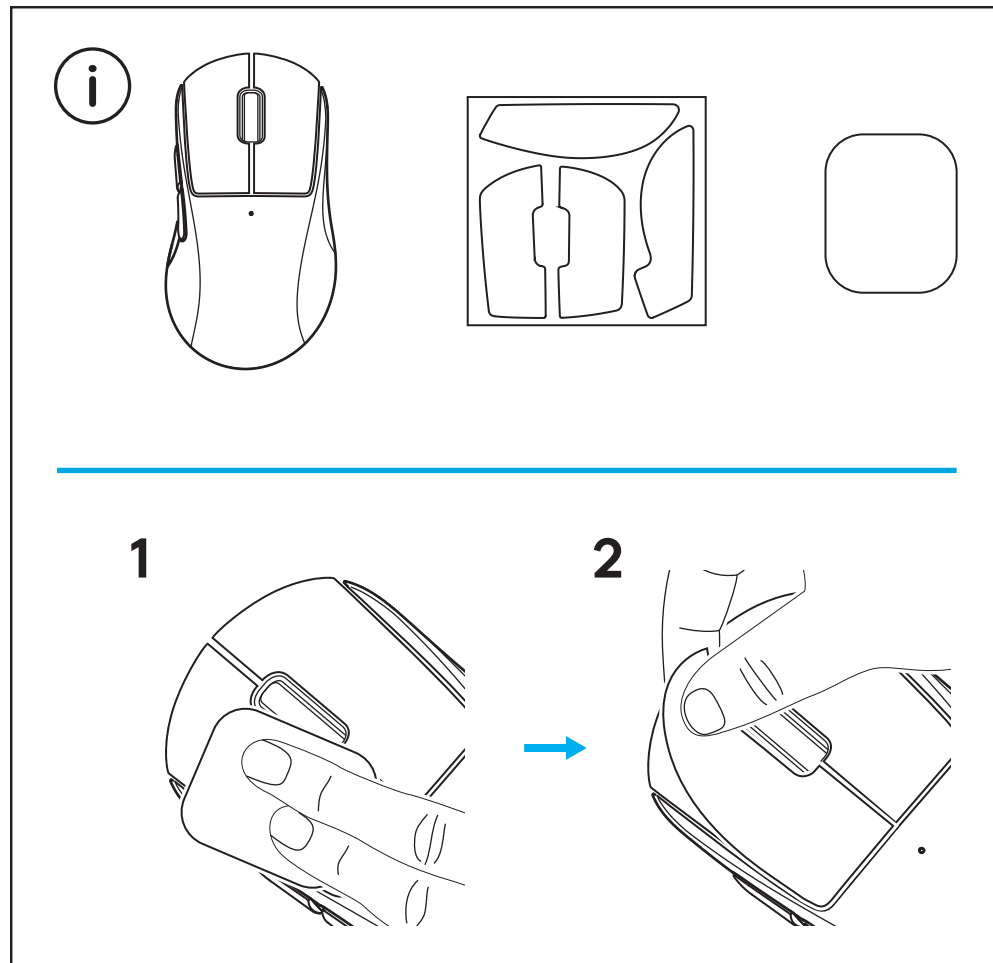

O receptor USB pode ser armazenado dentro do mouse removendo a porta de abertura do POWERPLAY. Isso pode impedir que o receptor seja perdido ao usar o mouse com o sistema de carregamento sem fio Logitech G POWERPLAY.

Remover esta porta também permite que a porta de abertura opcional com pé PTFR seja instalada em vez da porta de abertura padrão.

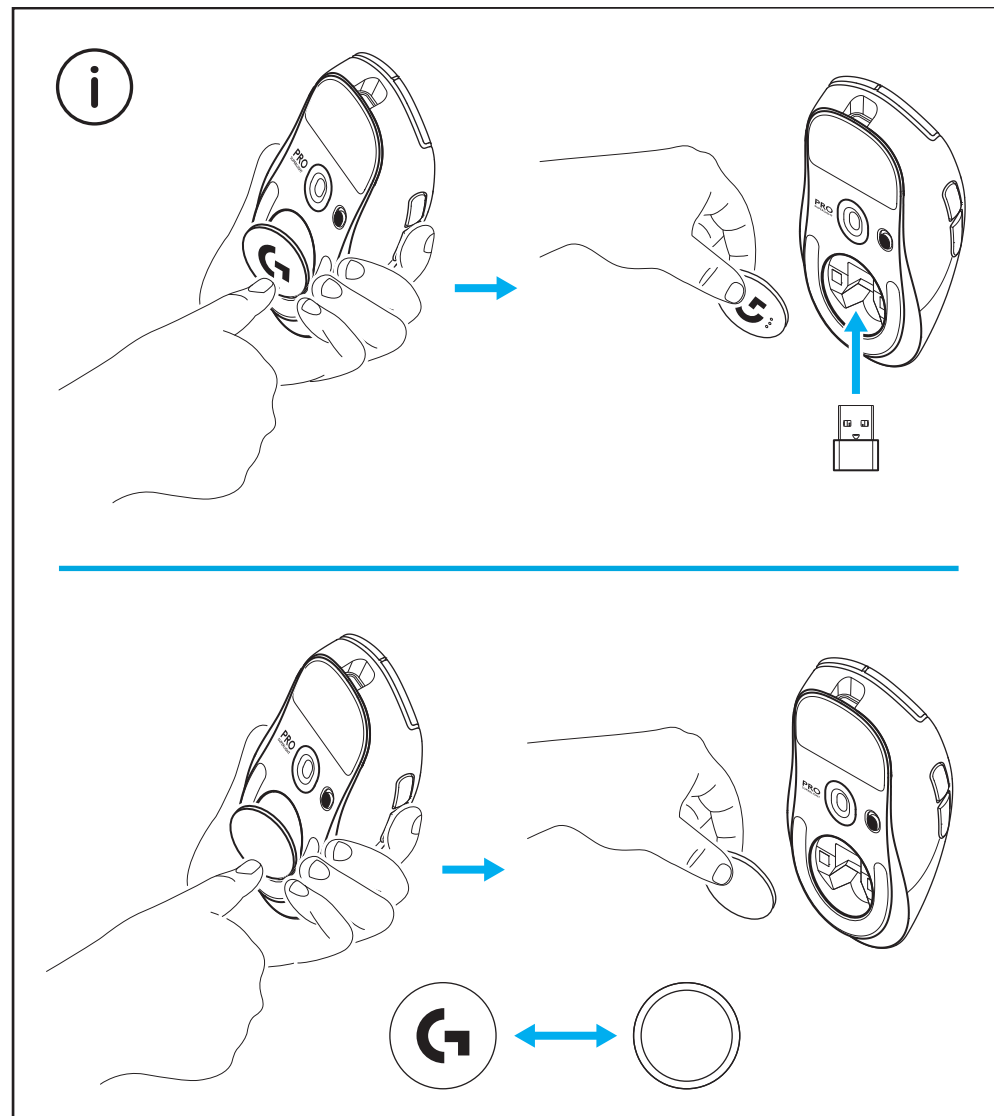



2024 Logitech. Logitech, Logitech G, their respective logos, POWERPLAY and LIGHTSPEED are trademarks or registered trademarks of Logitech Europe S.A. and/or its affiliates in the U.S. and other countries. USB-C is a trademark of USB Implementers Forum. All other trademarks are the property of their respective owners. Logitech assumes no responsibility for any errors that may appear in this manual. Information contained herein is subject to change without notice.

2024 Logitech. Logitech, Logitech G et leurs logos respectifs, et POWERPLAY et LIGHTSPEED sont des marques commerciales ou déposées de Logitech Europe S.A. et/ou de ses sociétés affiliées aux États-Unis et dans d'autres pays. USB-C est une marque déposée d'USB Implementers Forum. Toutes les autres marques sont la propriété exclusive de leurs détenteurs respectifs. Logitech décline toute responsabilité en cas d'erreurs susceptibles de s'être glissées dans le présent manuel. Les informations énoncées dans ce document peuvent faire l'objet de modifications sans préavis.

WEB-621-002582 002