



CLARITY 101 PLUS

Wireless In-Ear Headphones



Product Overview

- Earphones (Left & Right)
- Charging Case
- SportClip™ x 1 Pair (Installed)
- Eartips x 3 Pairs (S, M & L)
- USB-C Charging Cable
- Quick Start Guide & Warranty letter

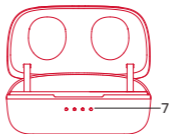
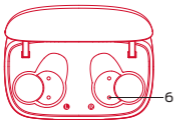
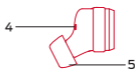

1. SportClip™
2. Multi Function Button (MFB)
3. LED Indicator
4. Charging Contacts
5. Eartip
6. Charging Case - Charging Pin
7. Charging Case - Battery level LED Indicator

Power On/Off

The earphones will automatically turn on after removing from the charging case.

To turn off the earphones, put back to the charging case.

Earphone's light indicator is on and starts charging, the earphones will automatically turn off. When the LED indicator is off, it is fully charged.

Experiment with the different sizes of ear tip to find your perfect fit.



Twist the earphone until it fits securely and comfortably.

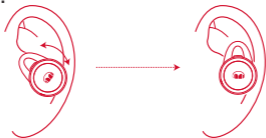

Pairing

Remove earphones from the charging case, the earphones will turn on automatically. Left and right earphones will be connected automatically. Wait for a few seconds, "pairing" voice prompt will be heard.

For new device connection, go to the Bluetooth settings on your mobile device and set it to search for new devices (new Monster device). Once the earphone is paired, you will hear "connected".

Volume Control

To decrease/increase the volume level, quickly double press the MFB on the left/right earphone during music streaming.

Calling

Short press the MFB to answer/end a phone call, long press the MFB about 2 seconds to reject a phone call.

Music

Short press the MFB once to play/pause music. To play the previous/next song, press and hold left/right MFB for around 2 seconds.

Voice Control

After connecting to the phone, quickly triple press the MFB to activate the voice assistant.

Reset

Put the earphones back to the charging case, earphone's light indicator will turn on to indicate it starts charging. Then press and hold both left and right MFB at the same time for around 5 seconds, when both light indicators flash three times, the reset process has been successfully completed. Remove earphones from the charging case, the earphones will turn on automatically. Left and right earphones will be connected automatically. Wait for a few seconds, "pairing" voice prompt will be heard.

LED Indicator Guide

Status	Description	Voice Prompt
Power On	Blue LED indicator stays on about 1 second	"Power On"
Power Off	Blue LED indicator stays on about 1 second	"Power Off"
Pairing	Blue LED indicator flashes continuously	"Pairing"
Connected	LED indicator is off	"Connected"
Charging – Earphones	Blue LED indicator stays on	-
Charging – Charging Case	Battery level LED Indicator flashes while charging. When battery level LED indicator is off, it is fully charged.	-

FCC Statement

The device has been evaluated to meet general RF exposure requirement. The device can be used in portable exposure condition without restriction. Changes or modifications not expressly approved by the party responsible for compliance could void the user's authority to operate the equipment. This equipment has been tested and found to comply with the limits for a Class B digital device, pursuant to Part 15 of the FCC Rules. These limits are designed to provide reasonable protection against harmful interference in a residential installation. This equipment generates uses and can radiate radio frequency energy and, if not installed and used in accordance with the instructions, may cause harmful interference to radio communications. However, there is no guarantee that interference will not occur in a particular installation. If this equipment does cause harmful interference to radio or television reception, which can be determined by turning the equipment off and on, the user is encouraged to try to correct the interference by one or more of the following measures:

- Reorient or relocate the receiving antenna.
- Increase the separation between the equipment and receiver.
- Connect the equipment into an outlet on a circuit different from that to which the receiver is connected.
- Consult the dealer or an experienced radio/TV technician for help

This device complies with part 15 of the FCC rules. Operation is subject to the following two conditions (1) this device may not cause harmful interference, and (2) this device must accept any interference received, including interference that may cause undesired operation.

FCC ID:2AT2J-MH22003