

Wave T5  
AI Wireless Lavalier Microphone  
**User Manual**



**Global Best Selling  
Internet Microphone**

Maono['mɑnoʊ], meaning "vision" in Kiswahili, is the Global Best Selling Internet Microphone Brand that products are sold well in 153 countries worldwide. With the beautiful vision of becoming a global leading brand of Internet audio products that deliver a pleasant sound experience, Maono is always working with audio professionals, influencers, and users, to make the world's best microphones and audio products.

## Product Overview

Thank you for purchasing the Maono AI Wireless Lavalier Microphone Wave T5. This is a professional portable 2.4GHz wireless microphone system with a built-in high-quality omnidirectional microphone. It uses an AI intelligent noise reduction algorithm to effectively reduce ambient noise and provide clear, high-quality audio recording effects. It is designed for live broadcasts, short video recordings, outdoor shooting, interviews and other scenarios. Please read the user manual carefully before using this product.

## Version Overview

Dual-TX camera version

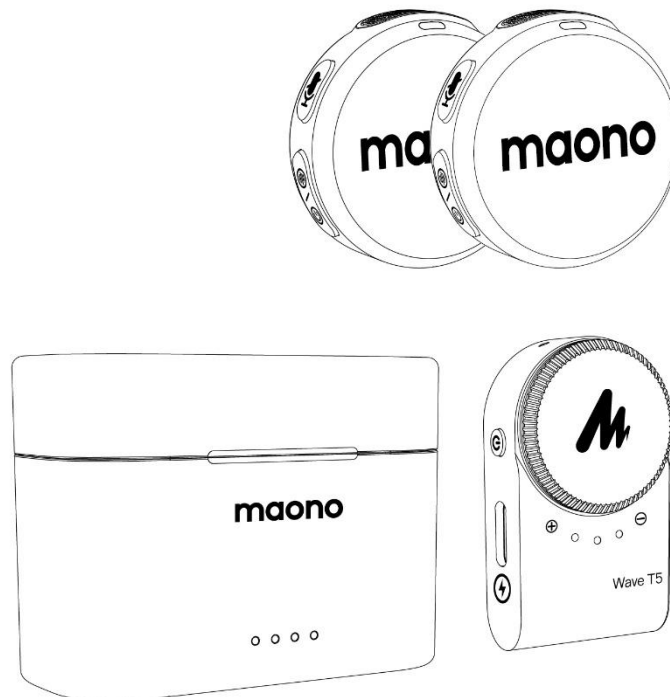

Combo version

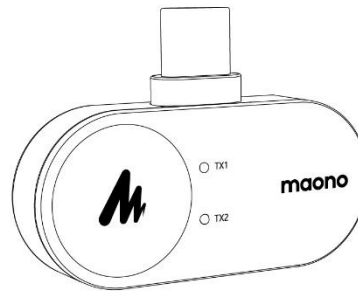
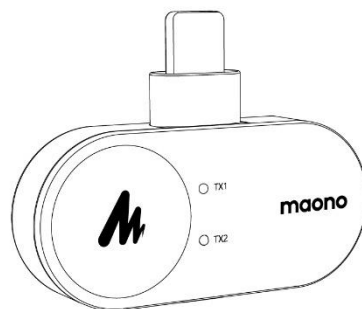
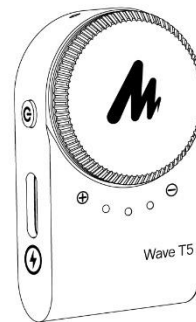
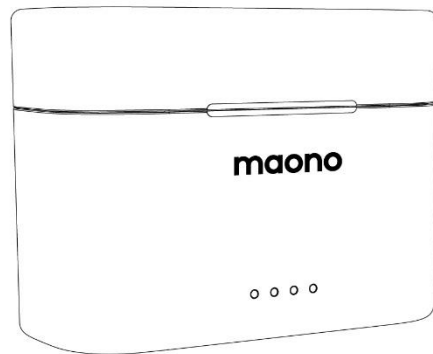

Single-TX lightning version

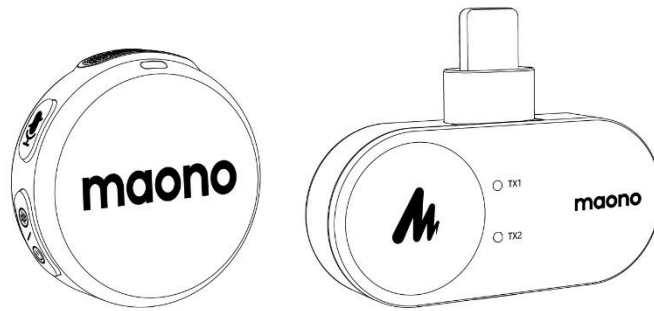

Dual-TX lightning version

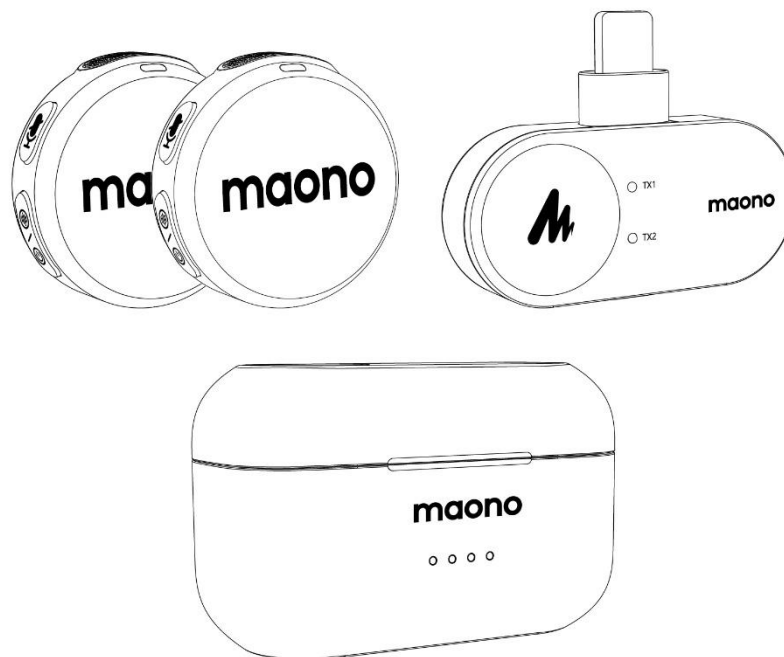

Single-TX type-C version

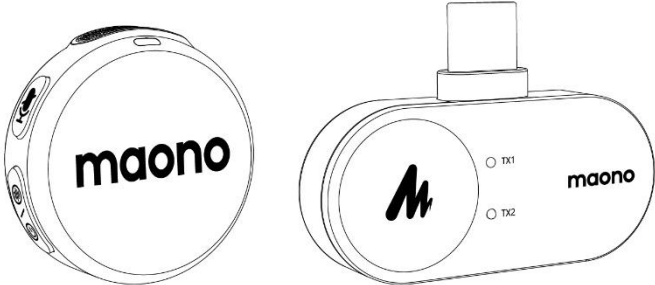

Dual-TX type-C version

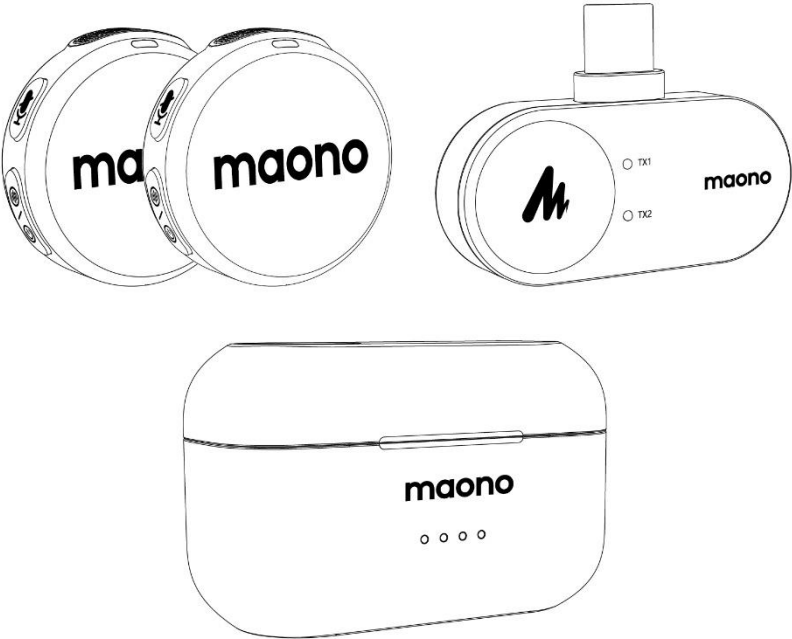

\*The quantity difference depends on specific SKU.

## Mobile version

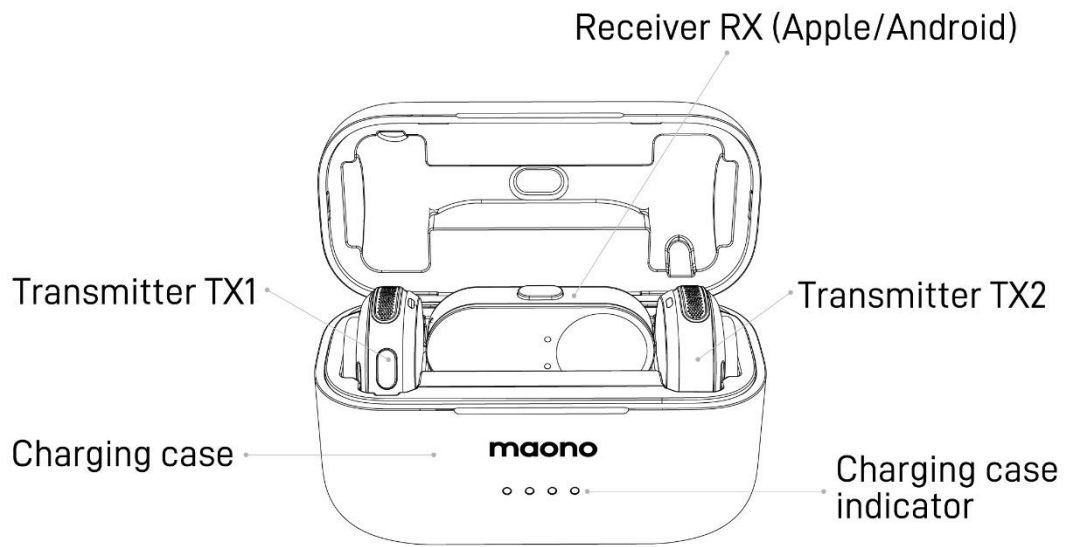

## Camera version

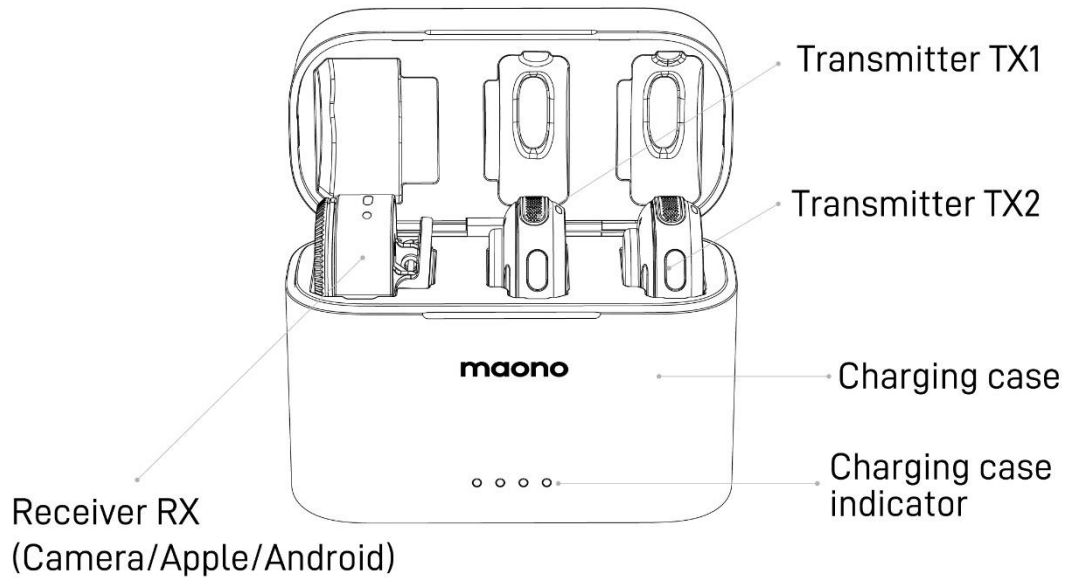

## Components Introduction

### Transmitter(TX)

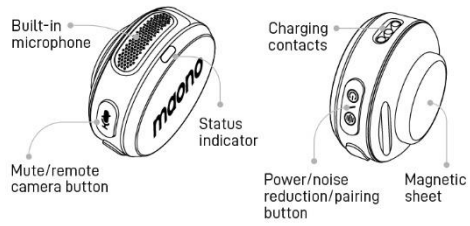

### Transmitter TX button guide

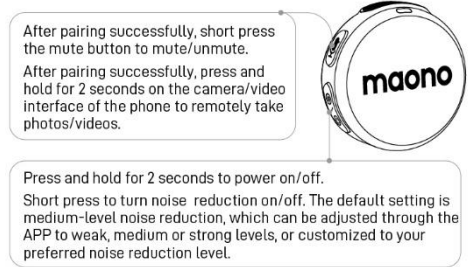

## Transmitter Indicator Instruction

Indicator Status	Indication and function introduction
Blue indicator light blink	TX and RX not paired
Blue indicator light always on	TX and RX successfully paired
Green indicator light always on	Noise reduction is activated
Red indicator light always on	Mute is activated
While charging, TX orange indicator light will be always on	TX is charging
While charging, TX green indicator light will be always on	TX is fully charged
TX status red indicator light blink slowly	TX low battery
TX status orange indicator light blink slowly	TX is upgrading

## Mobile receiver (Apple/Android RX)

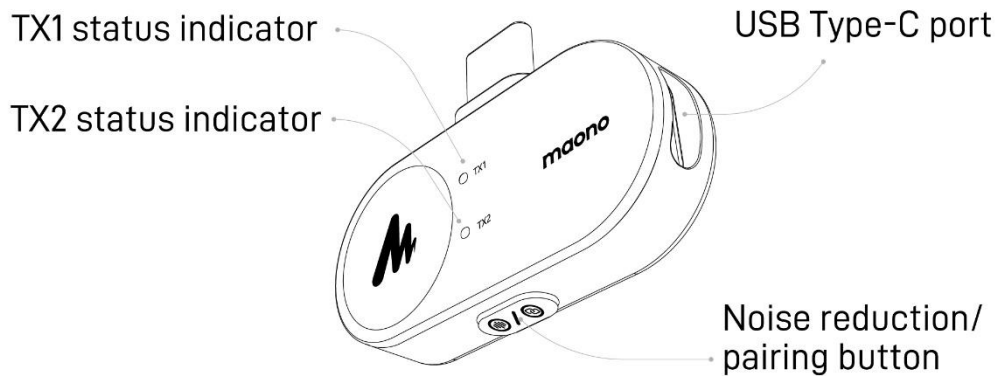

\*Apple lightning only has a different plug.

## Mobile receiver RX button guide

1. Short press the mobile RX noise reduction button to turn on or off the function. When noise reduction is turned on, the TX1/TX2 status indicator turns green.
2. Manual pairing: TX and RX have been paired before leaving the factory, no need to re-pair again. For manual pairing, connect the phone RX to the cell phone and long press the pairing key for 6s, and long press the TX pairing key for 6s when TX is off. After entering pairing mode TX status indicator changes to blue fast blinking.

## Mobile receiver RX Indicator Instruction

Indicator Status	Indication and function introduction
TX1/TX2 blue indicator light blink	TX and RX not paired
TX1/TX2 blue indicator light always on	TX and RX successfully paired
TX1/TX2 green indicator light always on	Noise reduction is activated
TX1/TX2 red indicator light always on	Mute is activated
TX1/TX2 status red indicator light blink slowly	TX low battery
TX1/TX2 status orange indicator light blink slowly	RX is upgrading

## Camera version receiver (Camera RX)

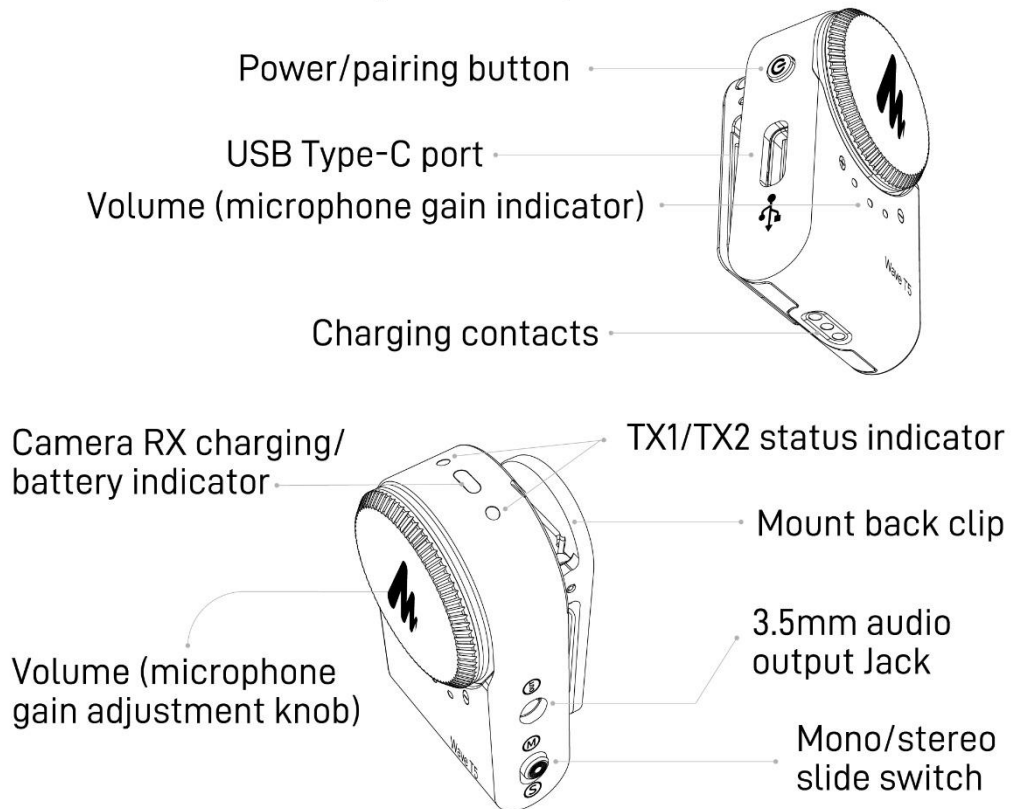

1. Volume (microphone gain) adjustment: The factory default volume setting is medium, and there are three levels of adjustable high, medium and low. Turn the volume knob clockwise to increase the volume, and turn the volume knob counterclockwise to decrease the volume.
2. Camera version RX mono/stereo mode switch: You can switch to mono **(M)** or stereo mode **(S)** by sliding the switch.
3. Manual Pairing: TX and RX have been paired before delivery, no need to re-pair. For manual pairing, long press the TX and Camera RX power button for 6s while TX and Camera RX are off.

After entering pairing mode the TX status indicator changes to a fast blinking blue light.

### Camera version RX Indicator Instruction

Indicator Status	Indication and function introduction
TX1/TX2 blue indicator light blinks	TX and RX not paired
TX1/TX2 blue indicator light always on	TX and RX successfully paired
TX1/TX2 green indicator light always on	Noise reduction is activated
TX1/TX2 red indicator light blink slowly	TX low battery
TX1/TX2 red indicator light always on	Mute is activated
RX charging/power orange indicator light blinks	RX is upgrading
RX charging/power red indicator light blink slowly	RX low battery
RX charging/power orange indicator light always on	RX is charging
RX charging/power green indicator light always on	RX is fully charged
1 volume indicator light always on	Low volume mode
2 volume indicator lights are always on	Medium volume mode
3 volume indicator lights are always on	High volume mode

# Instructions

## Product installation and connection

### Transmitter installation instructions

Attach the transmitter to the collar through the magnetic suction sheet, or clip it to the collar through the magnetic suction back clip.

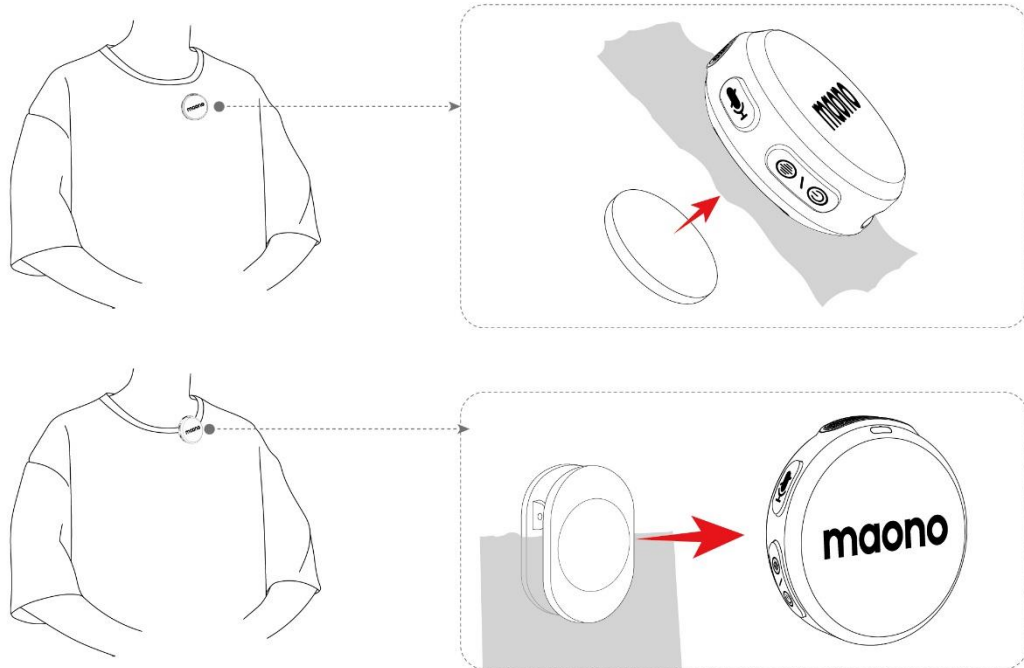

**\*Warm Tips:** If the recorded voice is loud and soft, it is mostly caused by the wearing position of the microphone. Be careful not to block the microphone. In outdoor environments, you can install a windproof fur cover to reduce the exposure caused by wind and breath. Insert the TX into the windproof fur sleeve as shown below, and install it in the upward direction of the arrow on the TX's back shell (microphone mesh facing upwards).

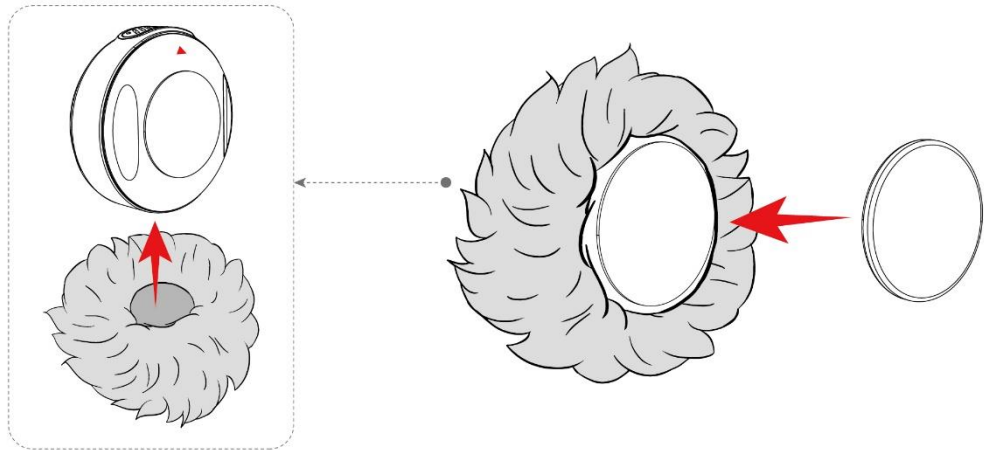

You can embed the magnetic tabs into the silicone sleeve, and the TX will be sucked on the magnetic tabs to hang the neck for use.

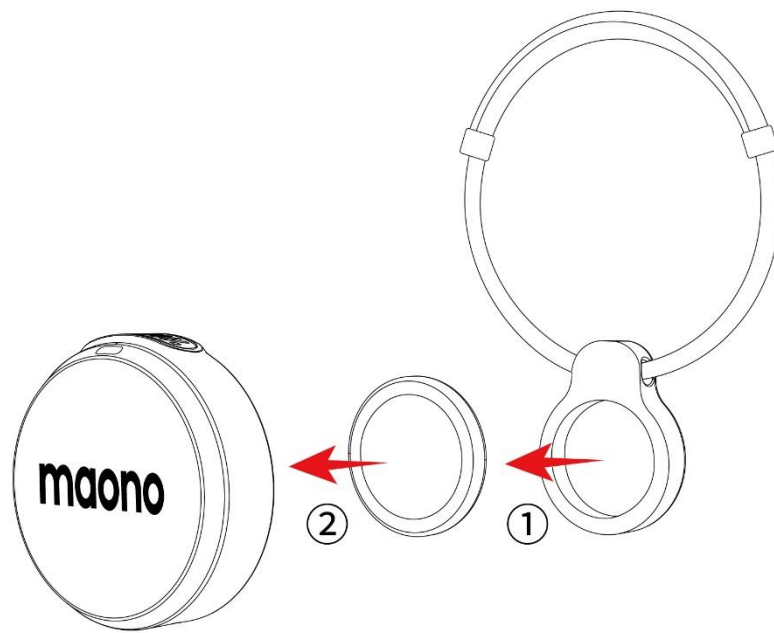

## Mobile version installation and connection instructions

1. Connect the mobile version receiver RX to the mobile phone through the lightning/Type-C plug to automatically turn on.

RX (Type-C version)  
connected to  
the mobile phone



RX (Lightning version)  
connected to  
the mobile phone

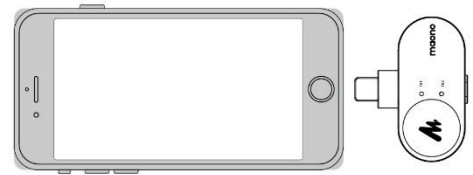

Charge the mobile device through RX, and support charging while using.

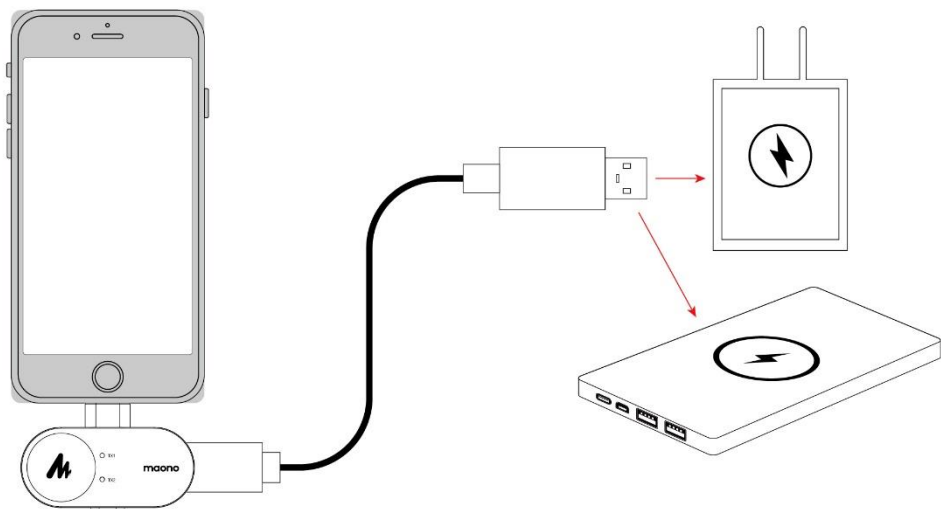

2. Take out the TX from the charging box, and the TX will automatically turn on; or press and hold the power button for 2 seconds to turn on the TX when it is turned off. After turning on, the TX and the RX will automatically connect, and the blue light (original sound mode) or green light (noise reduction mode) will be on and you can use it.

## Camera version installation and connection instructions

### 1. Camera and camera receiver RX connection

- (1) Install the receiver on the camera hot shoe/cold shoe interface through the back clip;
- (2) Connect the receiver's 3.5mm audio output interface to the camera's 3.5 mm audio input interface through a 3.5mm TRS to TRS cable;
- (3) Set the camera recording volume to the minimum and the receiver output volume to the middle level to ensure the best recording effect.

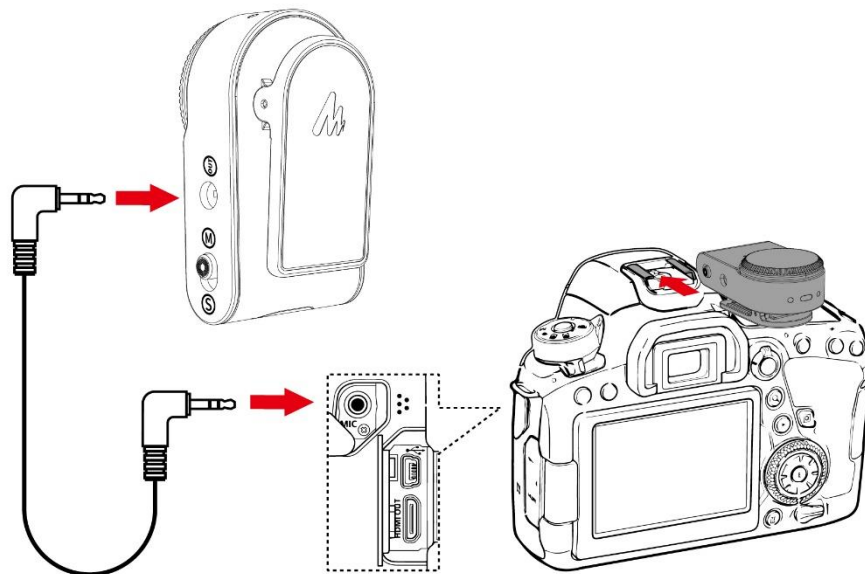

\*You can connect the phone via a USB Type-C to USB Type-C cable or a USB Type-C to Lightning cable.

## 2. Connect the mobile phone to the camera receiver RX

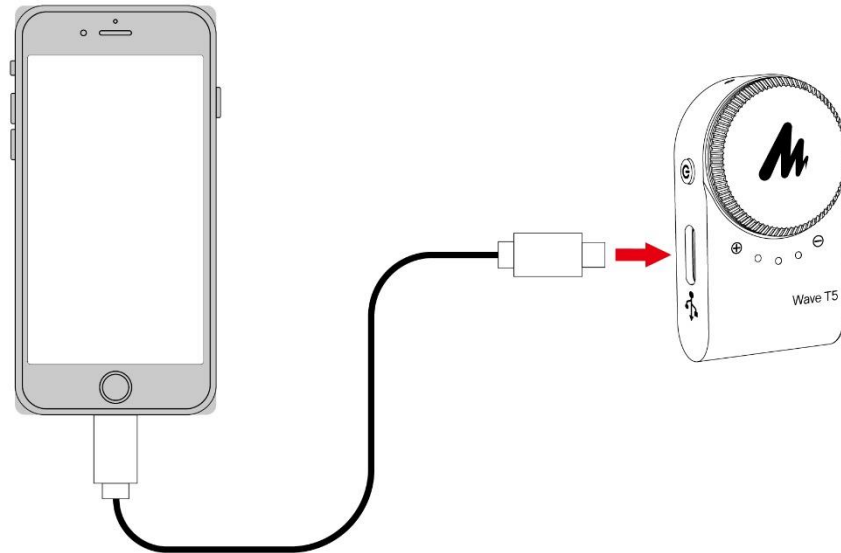

## Product installation and connection

### Charging with charging cable

Connect the transmitter TX to the power supply through the magnetic charging cable to charge the TX. The orange light of the TX status indicator is always on during charging, and it will turn green after charging is completed.

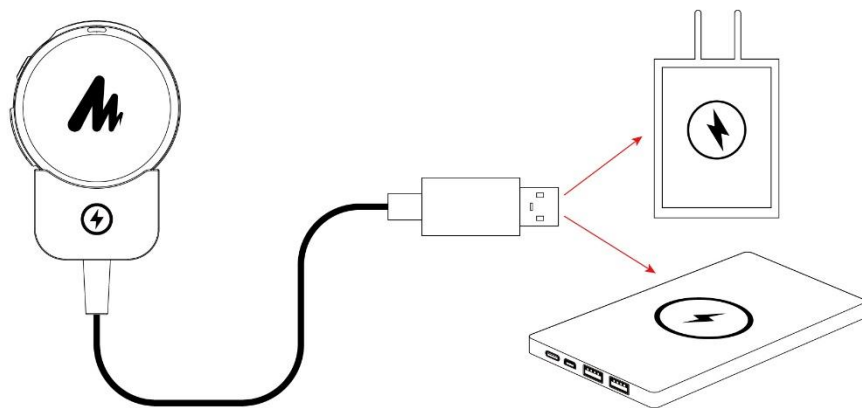

Charge the camera RX through the charging cable. The orange light of the RX status indicator is always on during charging, and it will turn green after charging is completed.

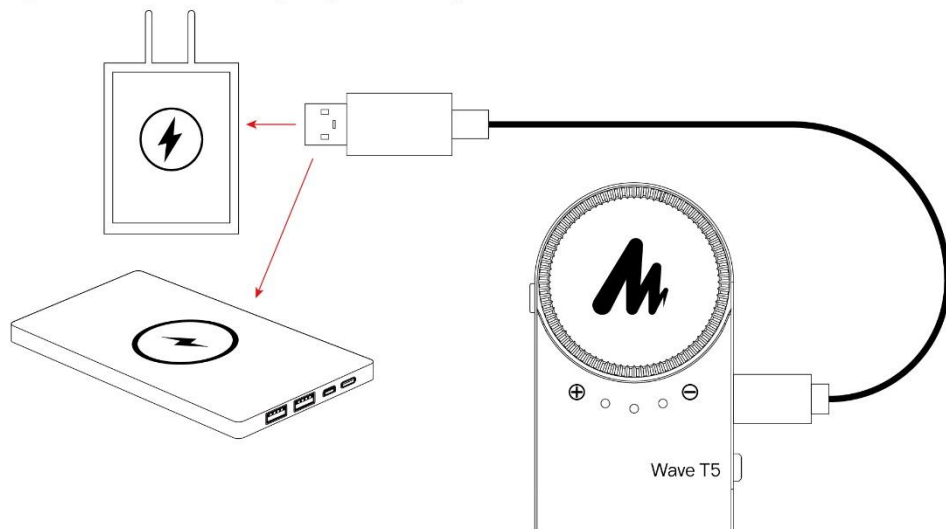

### **Charging with charging box**

When the transmitter TX or the camera receiver RX is placed in the charging box and the charging box is opened: Automatically detect whether the transmitter TX or the camera RX is fully charged.

If it is not fully charged, it will start charging until it is fully charged. The charging box indicator lights up when the cover is opened and goes out after 5S.

When the product is placed in the charging box and the box cover is closed: the product enters the shutdown state and charges. After it is fully charged, it will no longer be replenished.

### Charging the charging box itself

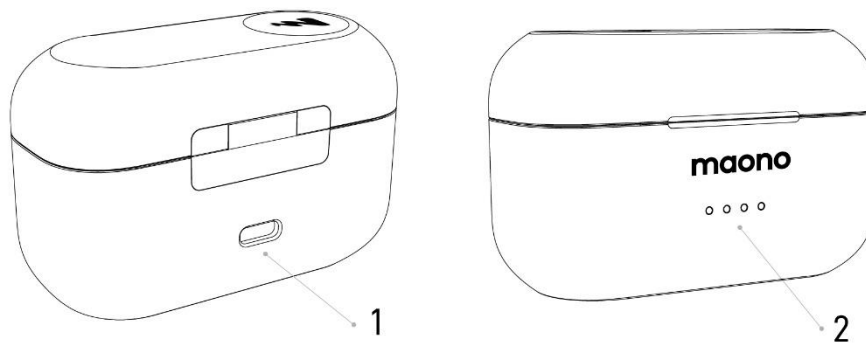

#### 1. Charging interface (USB-C)

Charge the charging box itself through the USB-C interface.

#### 2. Power indicator

Display the current charging box power information, see the table below for details.

---

The power indicator can be used to display the power during the charging and discharging process. The indicator definition is as follows.

- Indicates that the LED light is always on during the indication process
- ⦿ Indicates that the LED light flashes during the indication process
- Indicates that the LED light is off

### Charging Case indicator

LED1	LED2	LED3	LED4	Charging Indicator(while charging, LED will be on in turn)
				76~99%
				51~75%
				26~50%
				$\leq 25\%$
LED1	LED2	LED3	LED4	Power indicator(non-charging status)
				76~100%
				51~75%
				26~50%
				10~25%
				<10%

## APP Download

Scan the official QR code to download Maono Link APP, or download Maono Link APP in the App Store or Apple App Store. After successful connection, you can easily set microphone gain (volume), noise reduction level, vocal beautification, mobile phone speaker switch, firmware upgrade and other smart settings through APP.



\*When upgrading the device through APP, you need to connect the mobile version RX to the mobile phone or the camera version RX to the mobile phone through the connecting cable, and successfully connect with TX.

\*When upgrading through APP, do not connect the mobile phone RX Type-C charging port to an external charger.

\*The camera version needs to purchase a USB Type-C to USB Type-C or USB Type-C to Lightning cable to connect the mobile phone to use APP.

## Important safety precautions

1. Please read this manual carefully and follow all instructions and terms and pay attention to all precautions.
2. You can use a standard 5V USB-C mobile phone charger to charge this product. To avoid product damage, do not use a charger exceeding 5V to

charge this product. In order to reduce the pollution of waste electronic equipment to the environment, the package is no longer equipped with an additional charger.

3. Do not drop or hit the microphone, which will damage the microphone pickup and affect the sound quality.
4. Do not use this product in water, humid environments, such as outdoor rainy days, or wet basements. It is forbidden to use the battery after it is soaked in water.
5. Do not expose this product to liquid splashing or dripping areas, and do not place utensils filled with liquid on this product.
6. Do not use this product in heat sources, high temperatures, etc., such as near fire sources, sun exposure areas, radiators, heaters and other equipment.
7. Please try not to use the microphone in thunderstorms, and unplug the USB charger to prevent lightning high voltage from breaking through the circuit of this product.
8. When going out or not using this product for a long time, please unplug the USB charger to avoid fire.
9. Do not place this product near strong magnetic or strong interference equipment, such as cable concentration areas, Wifi routers, high-voltage power supplies, etc., otherwise abnormal noise may be generated.
10. Do not use any acidic/alkaline or corrosive detergents to clean this product, which may cause irreversible damage to the appearance. When cleaning this product, it is recommended to wipe the body gently with a clean soft cloth dipped in clean water.
11. Please protect the USB charging cable to prevent it from being stepped on or the cable from being entangled and torn off.
12. If the charger or body is found to be abnormal, such as severe heating, odor, etc., please unplug the USB charger immediately and cut off the power supply.
13. Do not disassemble and repair the machine without authorization. If the machine is damaged or a fire is caused, Maono will not bear any responsibility.

## Specifications

Name	Transmitter	Receiver-Lightning/ Receiver-Type-C
Transmission Type	2.4GHz Digital Frequency Hopping Technology	2.4GHz Digital Frequency Hopping Technology
Polar Pattern	Omnidirectional	
Frequency Response Range	20Hz-20KHz	
Maximum Sound Pressure Level	120dB SPL	
Dynamic Range	93dB	
S/N	>80dB	
Flexibility	-2.5dBFS at 1000Hz 94dB	
Max Wireless Transmission Range	300m(viewing range) 100m(Rotation)	300m(viewing range) 100m(Rotation)
Lithium Battery Parameters	3.8V 97mAh	
Battery Life	About 10h	
Charging Time	About 1.5h	
Work Environment Temperature	-10~50°C	-10~50°C
Charging Environment Temperature	0~45°C	
Size	27*27*13mm	41*32*8mm
Weight	9.0g	5.1g

Name	Receiver (Camera)	Phone charging case	Camera charging case
Transmission Type	2.4GHz Digital Frequency Hopping Technology		
Polar Pattern			
Frequency Response Range			
Max Sound Pressure Level			
Dynamic Range			
S/N			
Flexibility			
Max Wireless Transmission Range	300m(viewing range) 60m(Rotation)		
Lithium Battery Parameters	3.8V 145mAh	3.8V 750mAh	3.8V 1950mAh
Battery Life	About 9h	Charge for twice (Approximately)	Charge for twice (Approximately)
Charging Time	About 1.5h	About 2h	About 2h
Work Environment Temperature	-10~50°C	-10~50°C	-10~50°C
Charging Environment Temperature	0~45°C	0~45°C	0~45°C
Size	44*26*19mm	81*37*51mm	78*36*57mm
Weight	13.6g	79.6g	107.6g

## **FCC Requirement**

Any changes or modifications not expressly approved by the party responsible for compliance could void the user's authority to operate the equipment. This device complies with Part 15 of the FCC Rules. Operation is subject to the following two conditions:

- (1) this device may not cause harmful interference, and
- (2) this device must accept any interference received, including interference that may cause undesired operation.

Note: This equipment has been tested and found to comply with the limits for a Class B digital device, pursuant to Part 15 of the FCC Rules. These limits are designed to provide reasonable protection against harmful interference in a residential installation. This equipment generates, uses, and can radiate radio frequency energy, and if not installed and used in accordance with the instructions, may cause harmful interference to radio communications. However, there is no guarantee that interference will not occur in a particular installation. If this equipment does cause harmful interference to radio or television reception, which can be determined by turning the equipment off and on, the user is encouraged to try to correct the interference by one or more of the following measures:

- Reorient or relocate the receiving antenna.
- Increase the separation between the equipment and receiver.
- Connect the equipment into an outlet on a circuit different from that to which the receiver is connected.
- Consult the dealer or an experienced radio/TV technician for help.

The device has been evaluated to meet general RF exposure requirement. The device can be used in portable exposure condition without restriction.

**IC Caution:****-English:**

This device complies with Industry Canada licence-exempt RSS standard(s).

Operation is subject to the following two conditions:

- (1) This device may not cause interference, and
- (2) This device must accept any interference, including interference that may cause undesired operation of the device.

The device has been evaluated to meet general RF exposure requirement. The device can be used in portable exposure condition without restriction.

**-French:**

Le présent appareil est conforme aux CNR d'Industrie Canada applicables aux appareils radio exempts de licence. L'exploitation n'est autorisée aux deux conditions suivantes:

- (1) l'appareil ne doit pas produire de brouillage, et
- (2) l'utilisateur de l'appareil doit accepter tout brouillage radioélectrique subi, même si le brouillage est susceptible d'en compromettre le fonctionnement.

Le matériel a été évalué pour répondre aux exigences générales d'exposition aux radiofréquences. Le dispositif peut être utilisé dans des conditions d'exposition portables illimitées.

Model : WM650/WM650A



To get technical support, please scan the QR code

**Technical support:**  
support@maono.com  
www.maono.com

**UK REP**

Company: CET PRODUCT SERVICE LTD.  
Address: Chase Business Centre, 39-41  
Chase Side, London N14 5BP United Kingdom  
Email: info.cetservice@gmail.com  
TEL: +447419325266



**Made in China**

**Final clause :**

Information and data contained in this manual are subject to change without notice in advance.

**EC REP**

Company: Zhou's Jade Star UG  
Address: Brunnenallee 11A 14478 Potsdam  
Tell: +49 179 7962788  
E-mail: jadestar.eu@gmail.com

We frequently update product firmware to improve user experiences and performance. The status display and operations may be slightly different among different firmware versions. For latest user manuals, please access on <https://www.maono.com>

V1.0\_20241111