

# DBU-AGM1275 ▶ 12V75Ah

AGM series are the universal battery, which adopt the AGM valve Control technology and high purity raw materials. The battery owns the advantage of high consistency, good performance and long cycle Life. The battery is applicable to UPS/EPS, medical equipment and safety system.

## ► Specification

Internal Cell	6
Nominal Voltage	12
Capacity	60Ah @ 10 hr-rate 1.8V/cell @25°C (77°F)
Weight	Approx. 21kg±3%
Max. Discharging Current	600A(5sec)
Internal Resistance	Approx. 13.5mΩ
Operating Temperature Range	Discharge: -15°C~50°C (5°F~122°F) Charge: -15°C~40°C (5°F~104°F) Storage: -15°C~40°C (5°F~104°F)
Nominal Operating Temperature Range	25°C±3°C(77°F±5°F)
Float Charging Voltage	13.5~13.8V VDC/unit Average at 25°C (77°F)
Recommended Maximum Charging Current Limit	18A
Equalization and Cycle Service	14.4~15.0V VDC/unit Average at 25°C (77°F)
Self Discharge	Batteries can be stored for more than 6 months at 25°C (77°F). Please charge batteries before using. For higher temperatures the time interval will be shorter.
Terminal	Thread lead alloy recessed terminal to accept M6 bolt
Container Material	ABS (UL 94-HB) & Flammability resistance of (UL 94-V0) can be available upon request.



## ► Dimensions :

Overall Height (H)	Container height (h)	Length (L)	Width (W)
Unit: mm 218±2	213±2	260±2	168±1.5

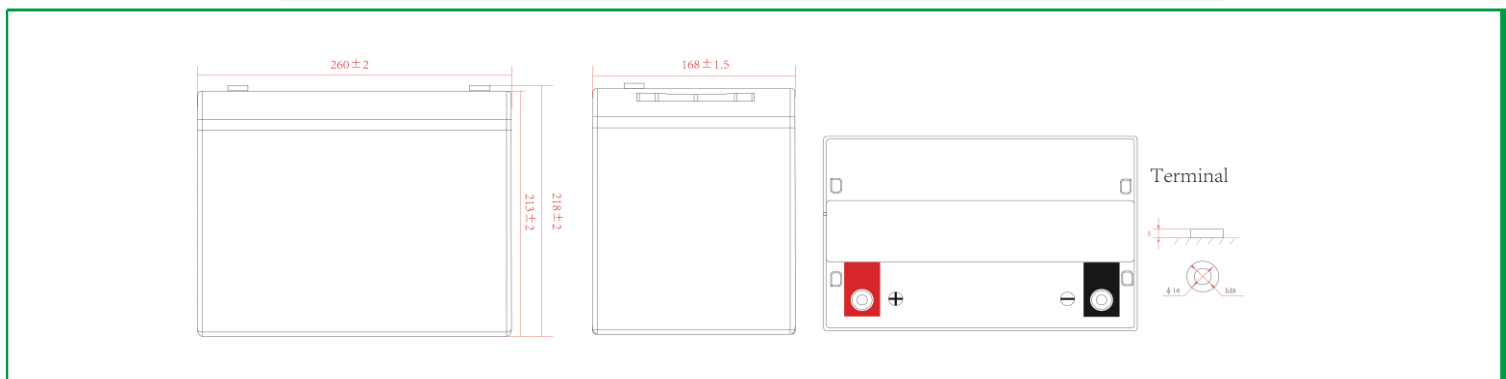

## Constant Current Discharge Characteristics Unit:A (25°C,77°F)

F.V/Time	15min	30min	1h	3h	5h	8h	10h	20h
1.60V	62.4	37.4	31.2	15.6	10.85	7.56	6.24	3.21
1.67V	61.8	37.0	30.9	15.4	10.75	7.48	6.18	3.18
1.7V	61.2	36.7	30.6	15.3	10.64	7.41	6.12	3.15
1.75V	60.6	36.3	30.3	15.1	10.54	7.34	6.06	3.12
1.8V	60.0	36.0	30.0	15.0	10.44	7.27	6.00	3.09
1.85V	58.2	34.9	29.1	14.5	10.12	7.05	5.82	2.99

## Constant Power Discharge Unit:W (25°C,77°F)

F.V/Time	15min	30min	1h	3h	5h	8h	10h	20h
1.60V	124.8	74.8	62.4	31.2	21.70	15.12	12.48	6.42
1.67V	123.6	74.0	61.8	30.8	21.50	14.96	12.36	6.36
1.7V	122.4	73.4	61.2	30.6	21.28	14.82	12.24	6.30
1.75V	121.2	72.6	60.6	30.2	21.08	14.68	12.12	6.24
1.8V	120.0	72.0	60.0	30.0	20.88	14.54	12.00	6.18
1.85V	116.4	69.8	58.2	29.0	20.24	14.10	11.64	5.98

### Trickle(or Float)Design Life

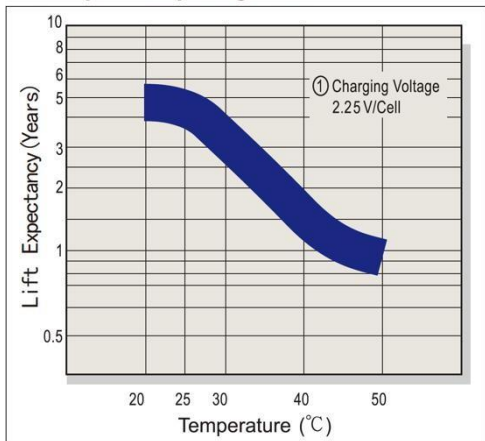

### Capacity Retention Characteristic

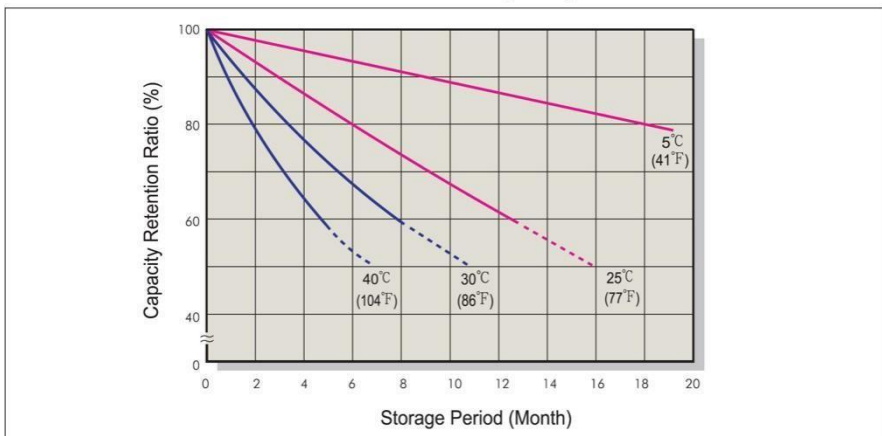

### Battery Voltage and Charge Time for Standby Use

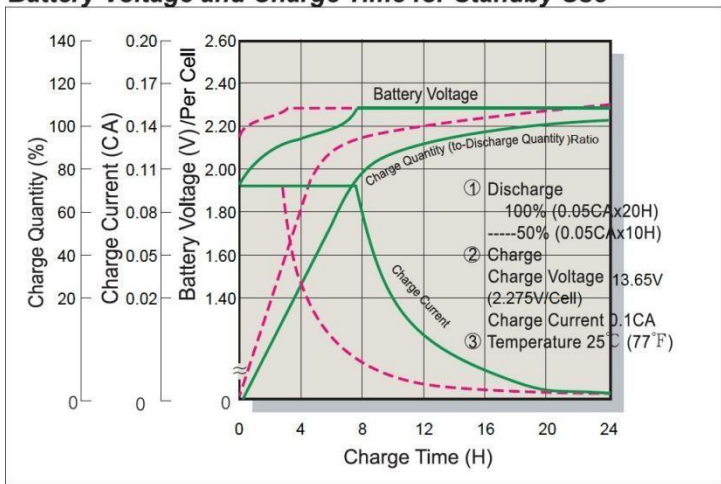

### Cycle Service Life

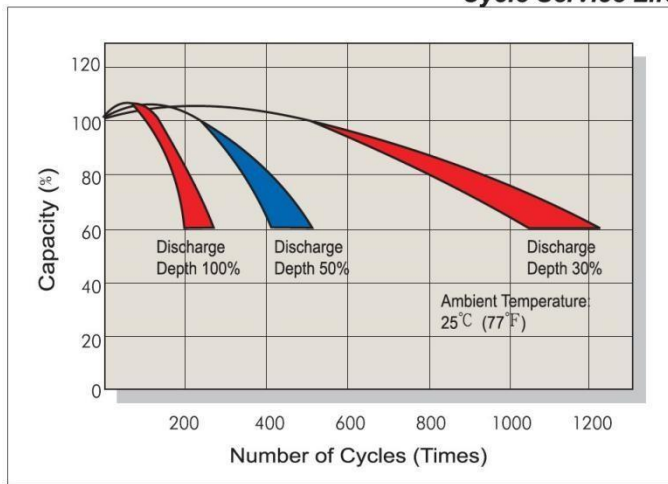

### Battery Voltage and Charge Time for Cycle Use

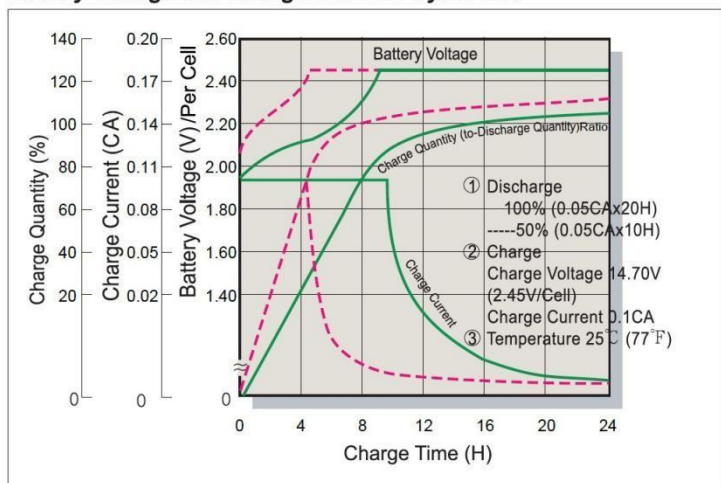

### Terminal Voltage (V) and Discharge Time

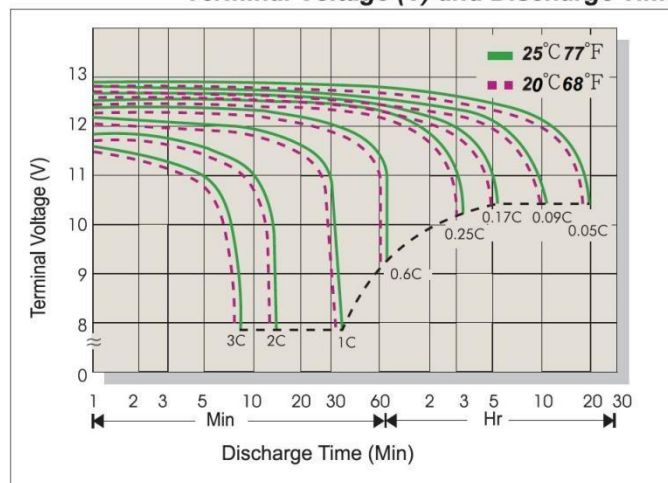

### Charging Procedures

Application	Charge Voltage (V/Cell)			Max. Charge Current
	Temperature	Set Point	Allowable Range	
Cycle Use	25°C (77°F)	2.45	2.40~2.50	0.3C
Standby	25°C (77°F)	2.275	2.25~2.30	

### Discharge Current VS. Discharge Voltage

Final Discharge Voltage V/Cell	1.75	1.70	1.65	1.6
Discharge Current(A)	0.2C > (A)	0.2C < (A) < 0.5C	0.5C < (A) < 1.0C	(A) > 1.0C

### Effect of temperature on capacity(20HR)

Temperature	Dependency of Capacity(20HR)
40°C	103%
25°C	100%
0°C	85%
-15°C	65%

### Self-discharge Characteristics

Storage time	Preservation rate
3 months	91%
6 months	82%
12 months	64%