

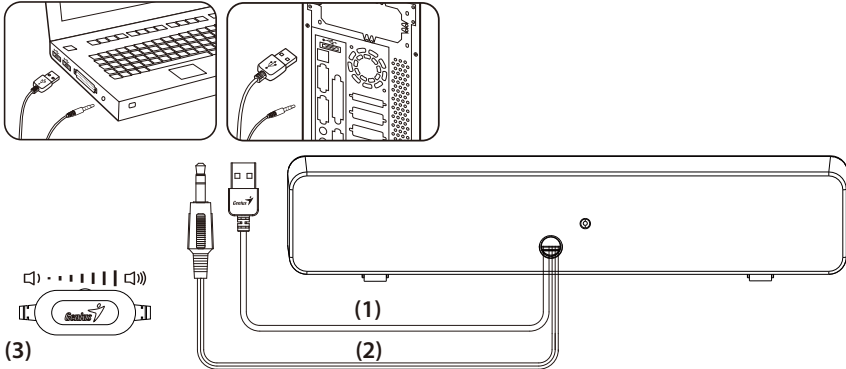

USB SoundBar 100 User's Manual



English

Instructions for Connecting the Speakers

1. Place the speakers next to the monitor, one on either side.
2. Connect USB plug (1) to PC or notebook for power supply only.
3. Connect (2) to any audio playback device with standard 3.5mm audio plug, such as PC, notebook, MP3/MP4 player, mobile phone, or CD player.
4. Adjust volume by using the knob (3).

Warning

1. Do not expose the speakers to any dripping or splashing and make sure no object filled with liquids, such as vases, etc., are placed on them

Русский

Инструкции по подключению колонок

1. Установите колонки
2. Подключите разъем USB (1) к компьютеру или ноутбуку только для питания.
3. Подключите разъем (2) к любому устройству воспроизведения звука со стандартным звуковым разъемом 3,5 мм: компьютеру, ноутбуку, MP3/MP4-плееру, мобильному телефону или проигрывателю компакт-дисков.
4. Отрегулируйте уровень звука рукояткой (3).

Внимание!

1. Защищайте колонки от капель и брызг воды. Не ставьте на них наполненные водой предметы (например, вазы).



Symbol for Separate Collection in European Countries

This symbol indicates that this product is to be recycled separately.

The instructions should be read in the language of the country of origin.

For more information, please refer to the local authorities or your waste management.

For more information, please refer to the local authorities or your waste management.

Symbol for Mitbringen in der Europäischen Union

This symbol indicates that this product must be brought to a separate collection point.

The instructions should be read in the language of the country of origin.

For more information, please refer to the local authorities or your waste management.

For more information, please refer to the local authorities or your waste management.

Symbol de collectie aparte în țările europene

Un simbol indică faptul că acest produs trebuie să fie reciclat separat.

Instrucțiunile trebuie citite în limba țării de origine.

Pentru mai multe informații, vă rugăm să vă adresați autorităților locale sau serviciilor de gestionare a deșeurilor.

Pentru mai multe informații, vă rugăm să vă adresați autorităților locale sau serviciilor de gestionare a deșeurilor.

Symbol for the separate differentiated recycling

This symbol indicates that this product is to be recycled separately.

The instructions should be read in the language of the country of origin.

For more information, please refer to the local authorities or your waste management.

For more information, please refer to the local authorities or your waste management.

Ανακύκλιση ηλεκτρονικών συσκευών (προϊόντων ηλεκτρονικής αλληλεπίδρασης)

Αυτό το σύμβολο υποδηλώνει ότι αυτό το προϊόν πρέπει να ανακυκλωθεί χωριστά.

Οι οδηγίες χρήσης πρέπει να διαβαστούν στην γλώσσα της χώρας προέλευσης.

Για περισσότερες πληροφορίες, παρακαλούμε να επικοινωνήσετε με τις αρχές τοπικές ή τις υπηρεσίες διαχείρισης αποβλήτων.

Για περισσότερες πληροφορίες, παρακαλούμε να επικοινωνήσετε με τις αρχές τοπικές ή τις υπηρεσίες διαχείρισης αποβλήτων.

Символ для сбора отходов в странах еврозоны

Этот символ указывает на то, что этот продукт должен быть утилизирован отдельно.

Инструкции по эксплуатации должны быть прочитаны на языке страны происхождения.

Для получения дополнительной информации, пожалуйста, обратитесь к местным властям или к службам по обращению с отходами.

Для получения дополнительной информации, пожалуйста, обратитесь к местным властям или к службам по обращению с отходами.

Символ за разграничаване на различни видове отпадък

Този символ показва, че този продукт трябва да се рециклира отделно.

Инструкциите за употреба трябва да се четат на езика на произхода.

За повече информация, моля, обърнете се към местните власти или към службите за управление на отпадъците.

За повече информация, моля, обърнете се към местните власти или към службите за управление на отпадъците.

Simbolul separării deșeurilor în statele membre ale Uniunii Europene

Acest simbol indică faptul că acest produs trebuie să fie reciclat separat.

Instrucțiunile de utilizare trebuie citite în limba țării de origine.

Pentru mai multe informații, vă rugăm să vă adresați autorităților locale sau serviciilor de gestionare a deșeurilor.

Pentru mai multe informații, vă rugăm să vă adresați autorităților locale sau serviciilor de gestionare a deșeurilor.

Symbol for recycling in other countries

This symbol indicates that this product is to be recycled separately.

The instructions should be read in the language of the country of origin.

For more information, please refer to the local authorities or your waste management.

For more information, please refer to the local authorities or your waste management.

Symbol for recycling in other countries

This symbol indicates that this product is to be recycled separately.

The instructions should be read in the language of the country of origin.

For more information, please refer to the local authorities or your waste management.

For more information, please refer to the local authorities or your waste management.

Symbol voor gescheiden afvalafhandeling in Europese landen

Dit symbool geeft aan dat dit product moet worden gerecycled.

De instructies moeten worden gelezen in de taal van het land van herkomst.

Voor meer informatie, wordt verzocht te contact opnemen met de lokale autoriteiten of de afvalbeheerders.

Voor meer informatie, wordt verzocht te contact opnemen met de lokale autoriteiten of de afvalbeheerders.

Symbol pentru reciclare în țările europene

Acest simbol indică faptul că acest produs trebuie să fie reciclat separat.

Instrucțiunile trebuie citite în limba țării de origine.

Pentru mai multe informații, vă rugăm să vă adresați autorităților locale sau serviciilor de gestionare a deșeurilor.

Pentru mai multe informații, vă rugăm să vă adresați autorităților locale sau serviciilor de gestionare a deșeurilor.

Symbol for recycling in other countries

This symbol indicates that this product is to be recycled separately.

The instructions should be read in the language of the country of origin.

For more information, please refer to the local authorities or your waste management.

For more information, please refer to the local authorities or your waste management.

Symbol for recycling in other countries

This symbol indicates that this product is to be recycled separately.

The instructions should be read in the language of the country of origin.

For more information, please refer to the local authorities or your waste management.

For more information, please refer to the local authorities or your waste management.

Symbol for recycling in other countries

This symbol indicates that this product is to be recycled separately.

The instructions should be read in the language of the country of origin.

For more information, please refer to the local authorities or your waste management.

For more information, please refer to the local authorities or your waste management.

Symbol for recycling in other countries

This symbol indicates that this product is to be recycled separately.

The instructions should be read in the language of the country of origin.

For more information, please refer to the local authorities or your waste management.

For more information, please refer to the local authorities or your waste management.

KYE SYSTEMS CORP.
www.geniusnet.com
 #492, 39c/3, Chung Hwa Rd.,
 Sanching Dist., New Taipei City 24196, Taiwan
 Tel: +886-2-2951-6648 Fax: +886-2-2951-6649

Производственная Компания «Гениус Нет»
 Адрес: №492, Чаунг Хва Роуд,
 Район Санчинг, Тайбэй, Тайвань.
 Тел: +886-2-2951-6648 Факс: +886-2-2951-6649

KYE Systems Europe GmbH
 Karlsruhe/Strabe 3, D-40789 Langenfeld, Germany

KYE Systems America Corporation (Latin)
 1301 NW 84TH Ave., Suite 127, Doral, FL 33126, USA

KYE International Corp. (USA & Canada)
 1037E Colony Street, Chino, CA 91710, USA

