



MSI Graphics Card Quick User's Guide



Installation Guide (NVIDIA)



Installation Guide (AMD)

Package Contents

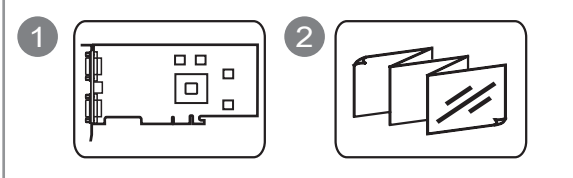

System Requirements

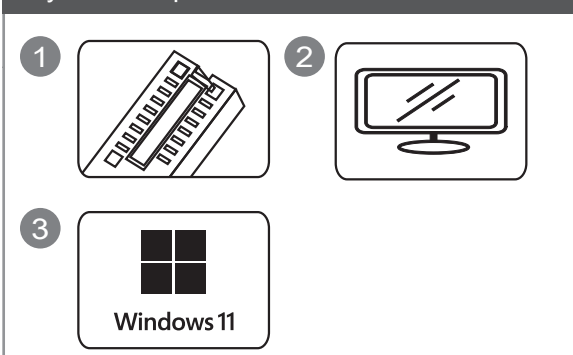

Auxiliary Tools



Hardware Installation

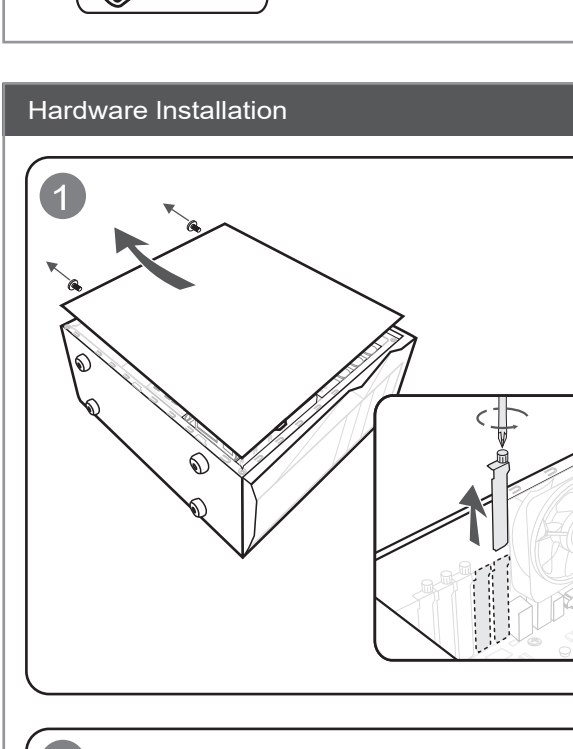

System Requirements

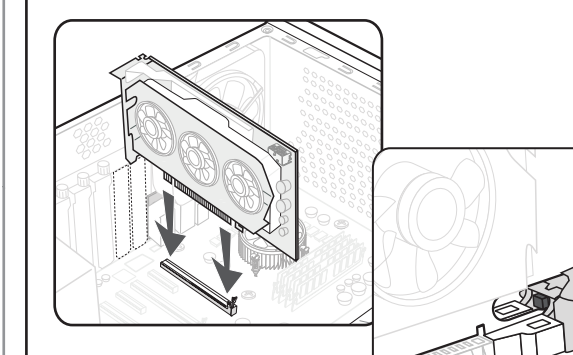

Auxiliary Tools

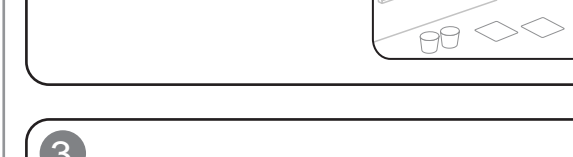

Hardware Installation

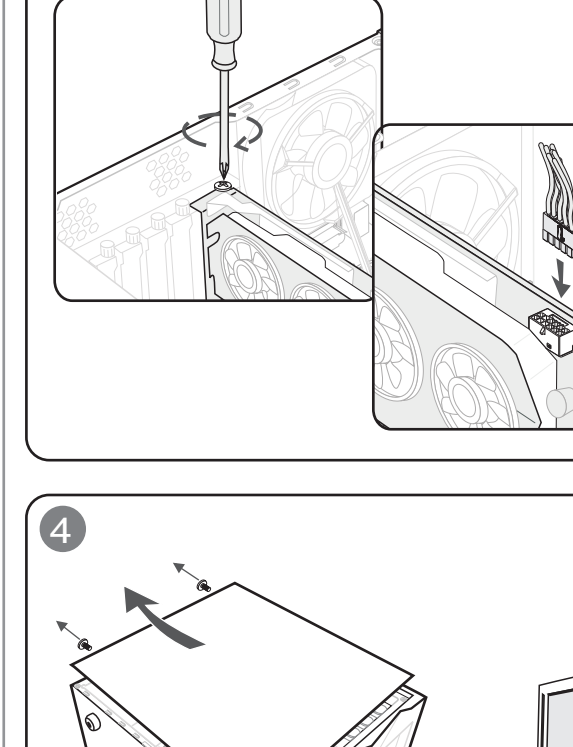

System Requirements

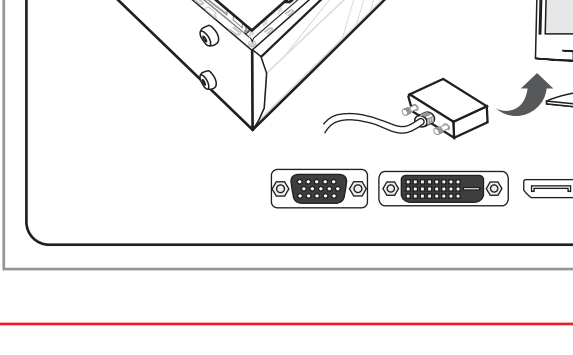

Auxiliary Tools



Package Contents

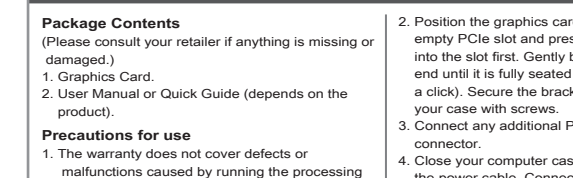

System Requirements

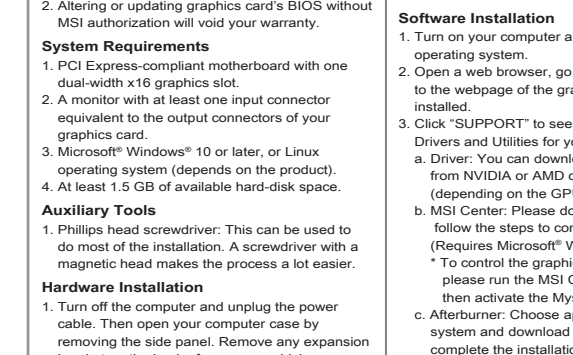

Auxiliary Tools

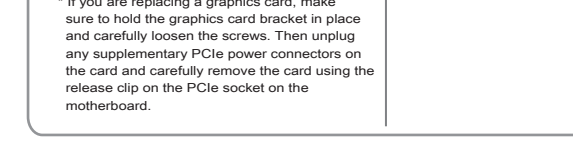

Hardware Installation

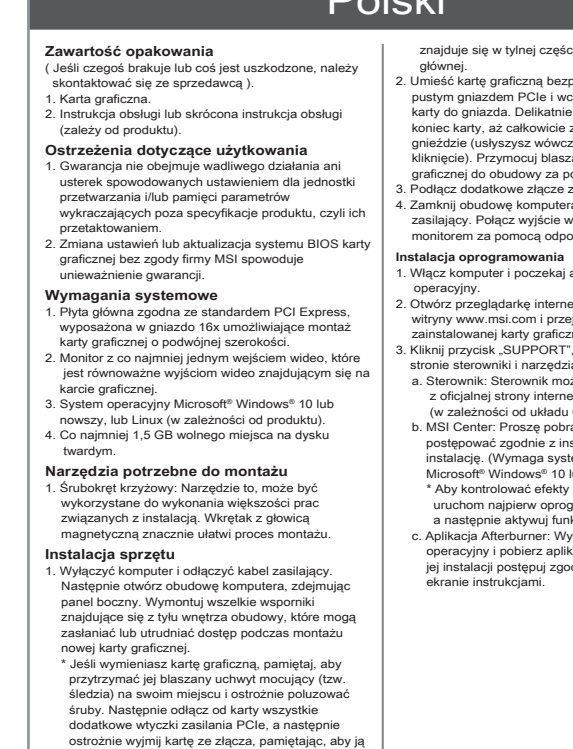

System Requirements



Auxiliary Tools

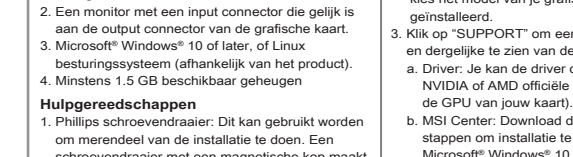

Hardware Installation

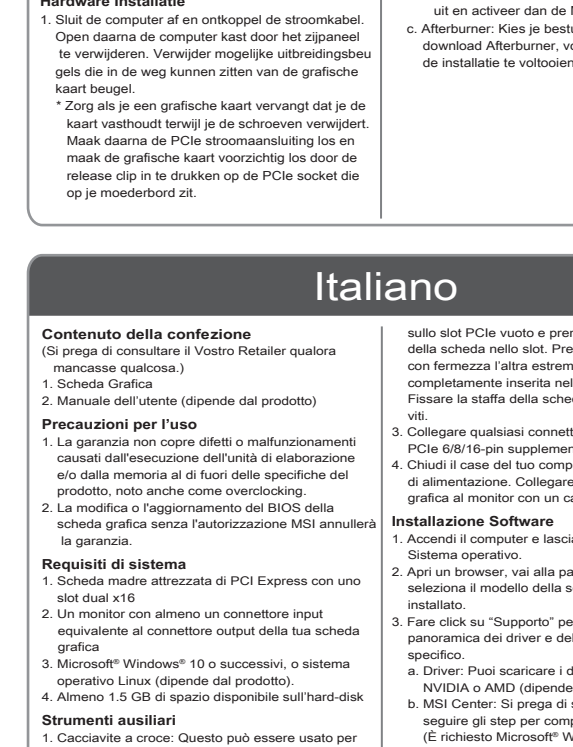

System Requirements

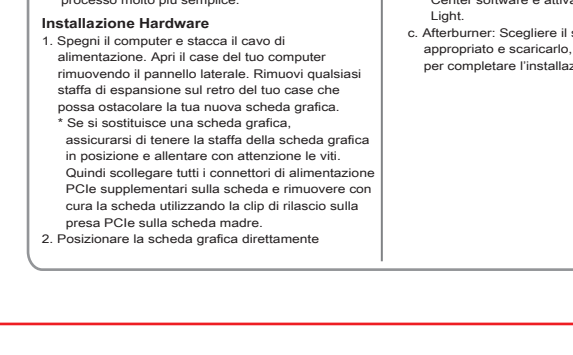

Auxiliary Tools



Package Contents

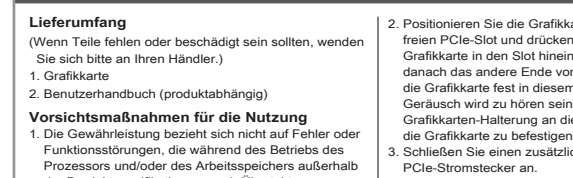

System Requirements

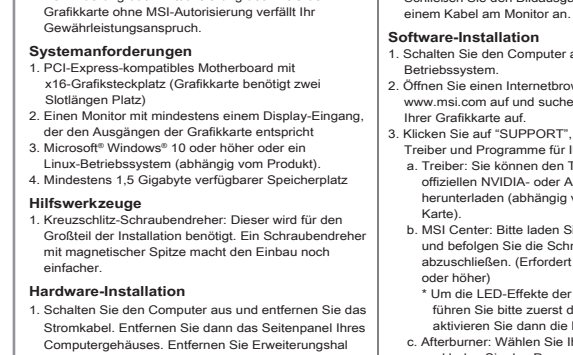

Auxiliary Tools

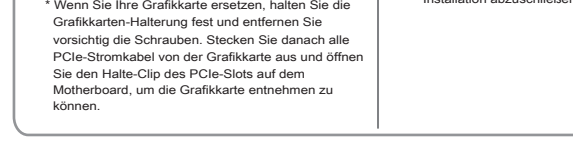

Hardware Installation

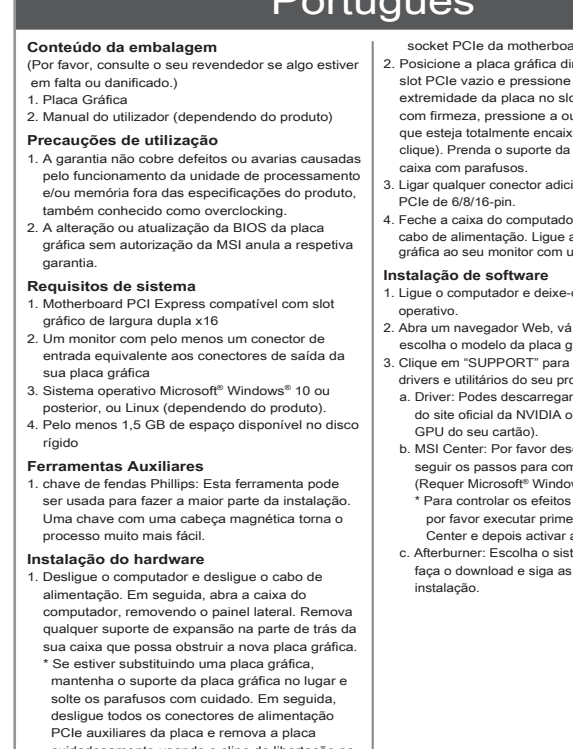

System Requirements

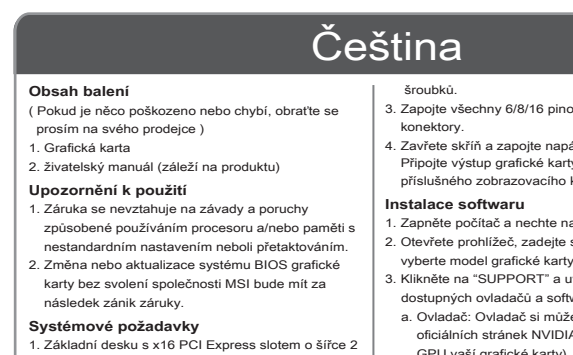

Auxiliary Tools

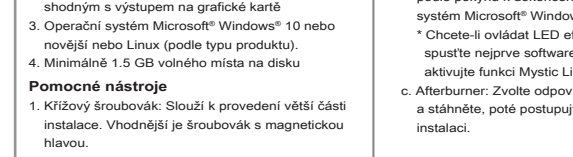

Hardware Installation

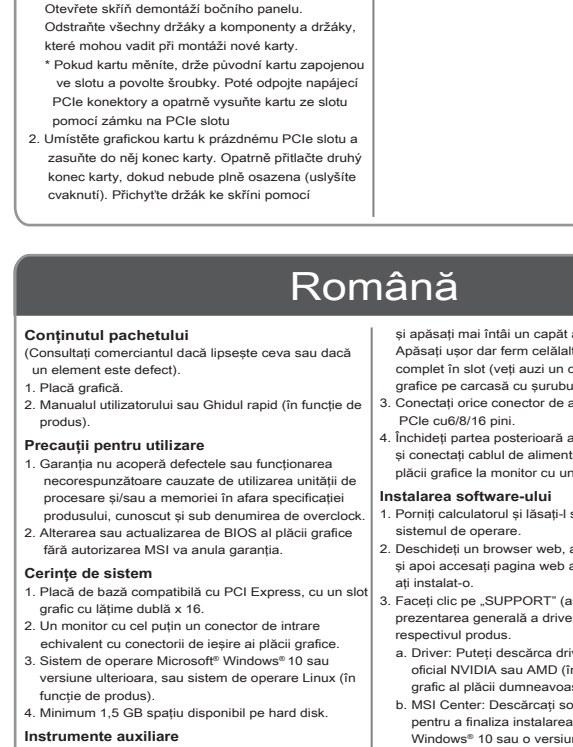

System Requirements

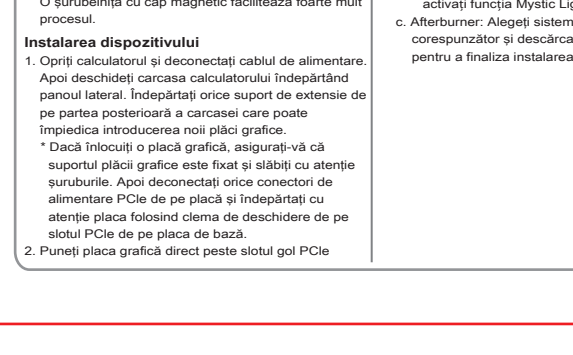

Auxiliary Tools



Package Contents

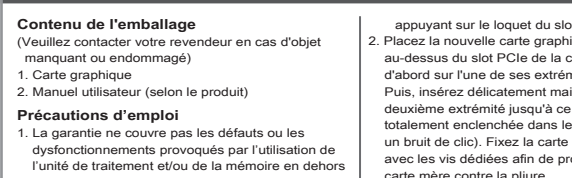

System Requirements

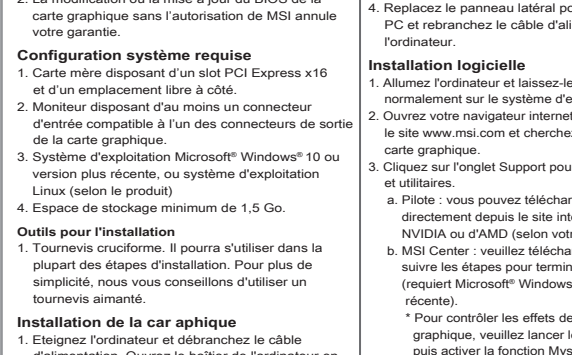

Auxiliary Tools

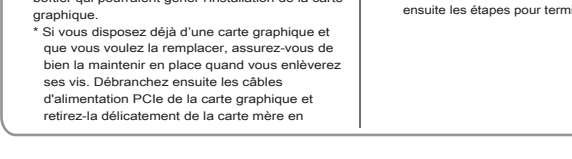

Hardware Installation

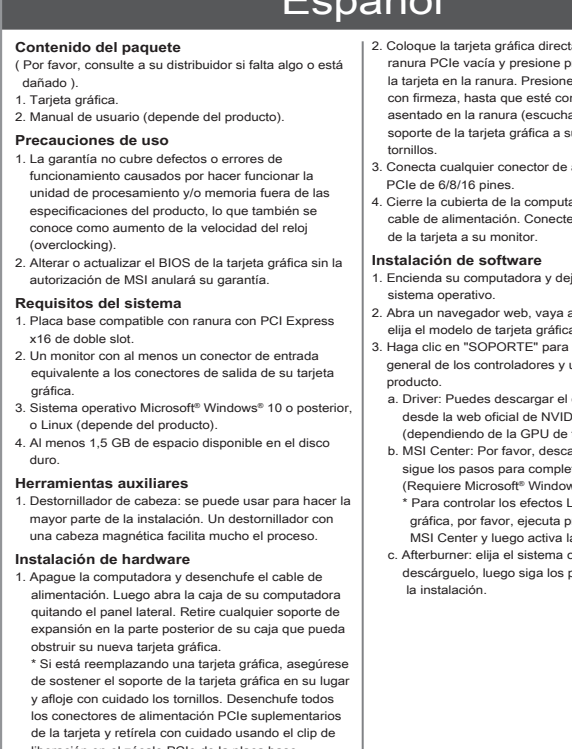

System Requirements



Auxiliary Tools

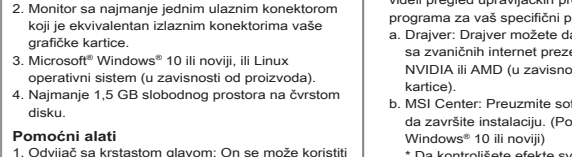

Hardware Installation

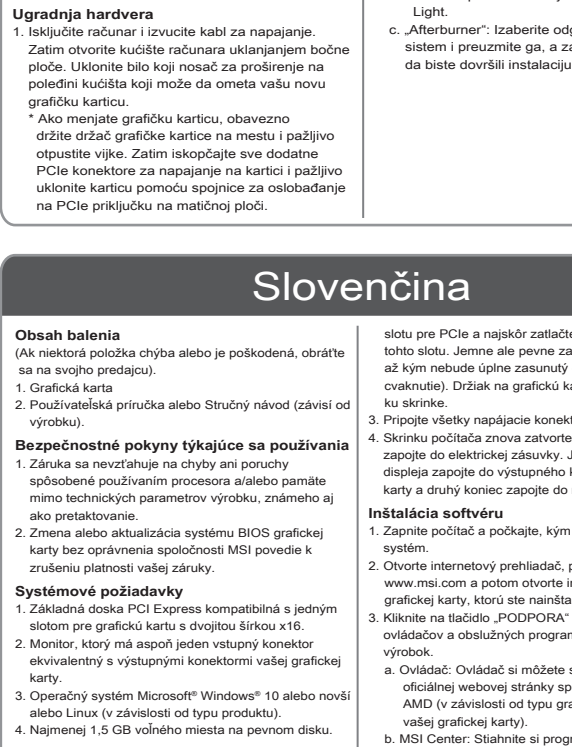

System Requirements

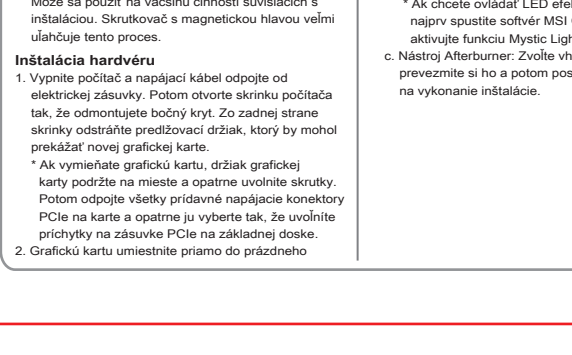

Auxiliary Tools



Package Contents

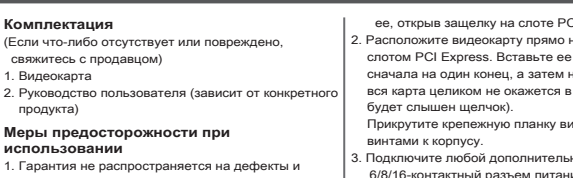

System Requirements

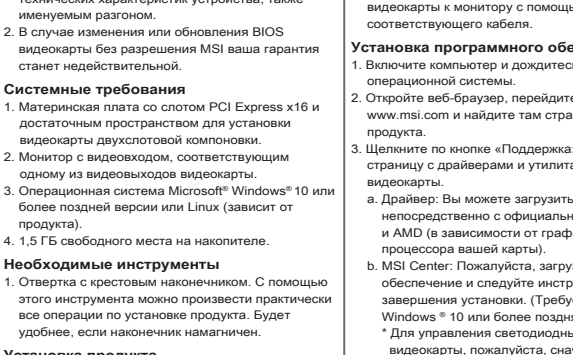

Auxiliary Tools

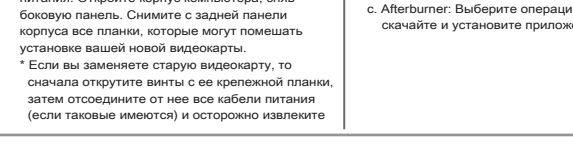

Hardware Installation

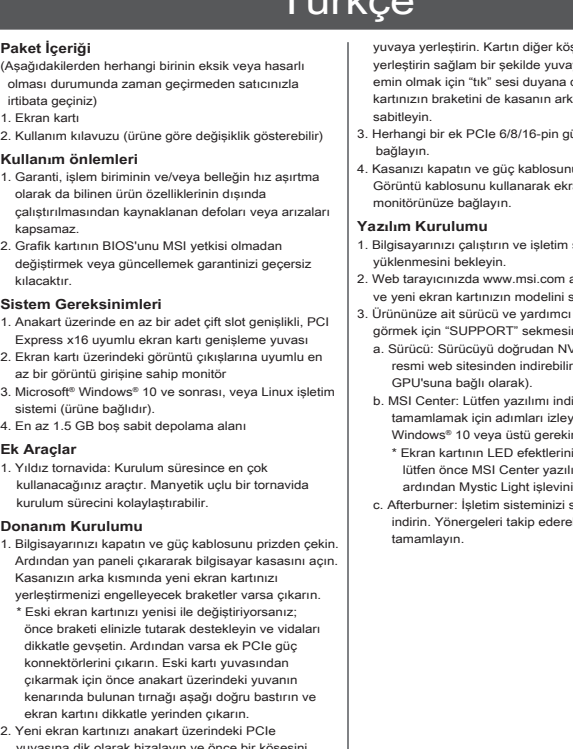

System Requirements

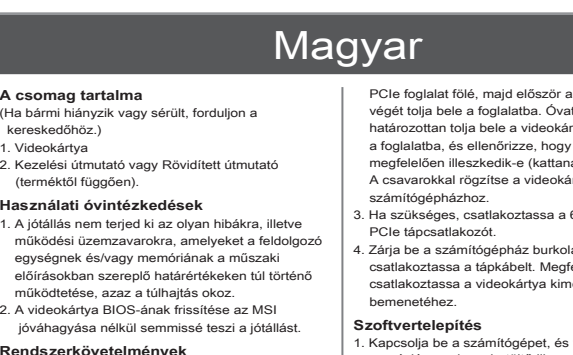

Auxiliary Tools

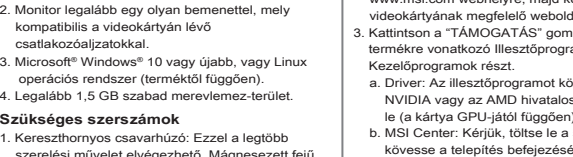

Hardware Installation

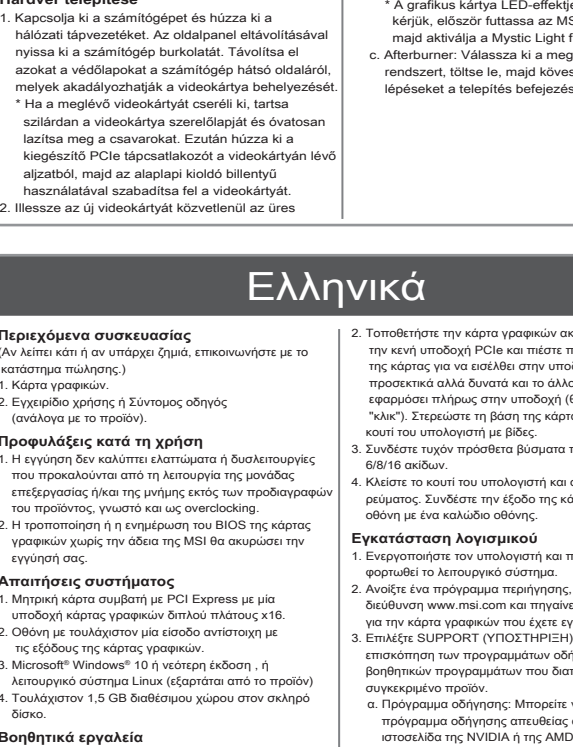

System Requirements

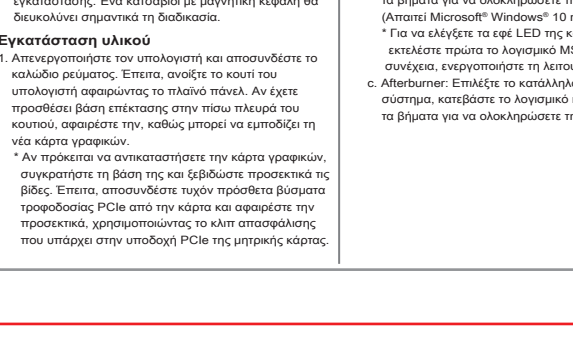

Auxiliary Tools



Package Contents

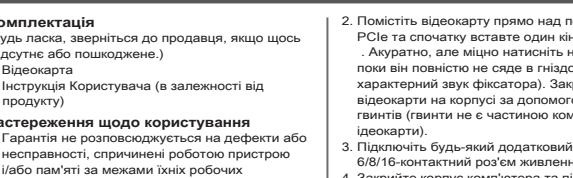

System Requirements

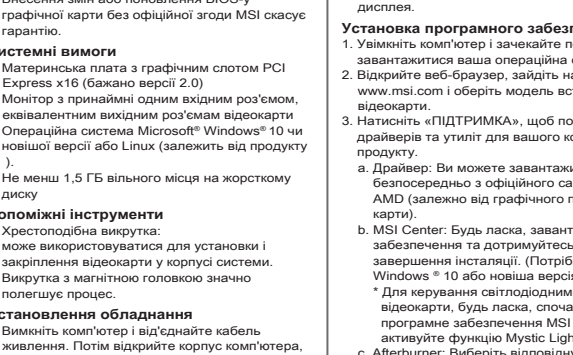

Auxiliary Tools

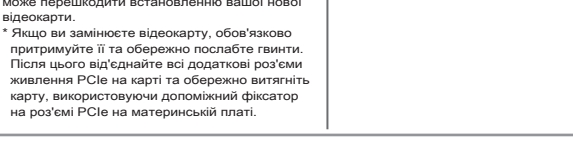

Hardware Installation

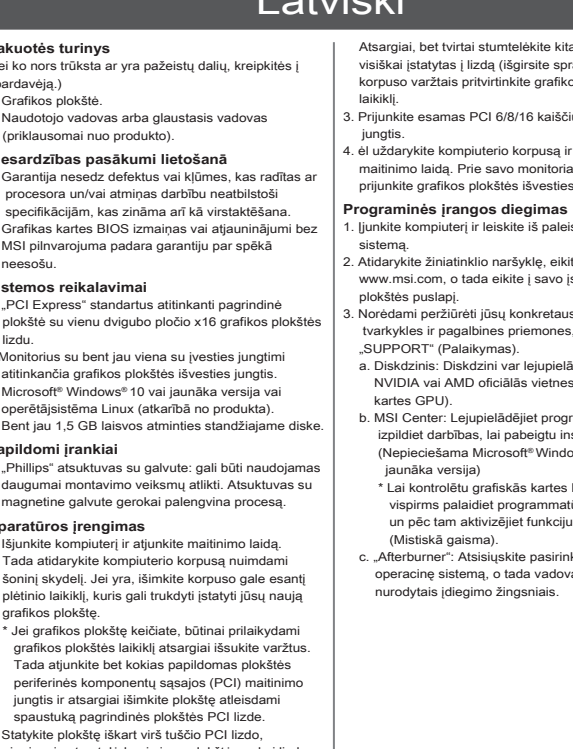

System Requirements

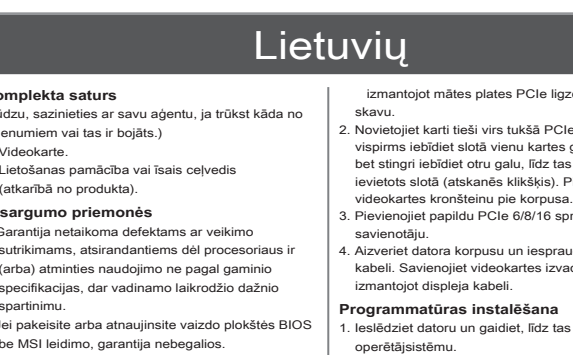

Auxiliary Tools

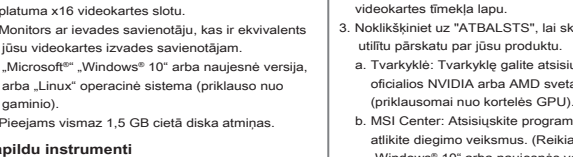

Hardware Installation

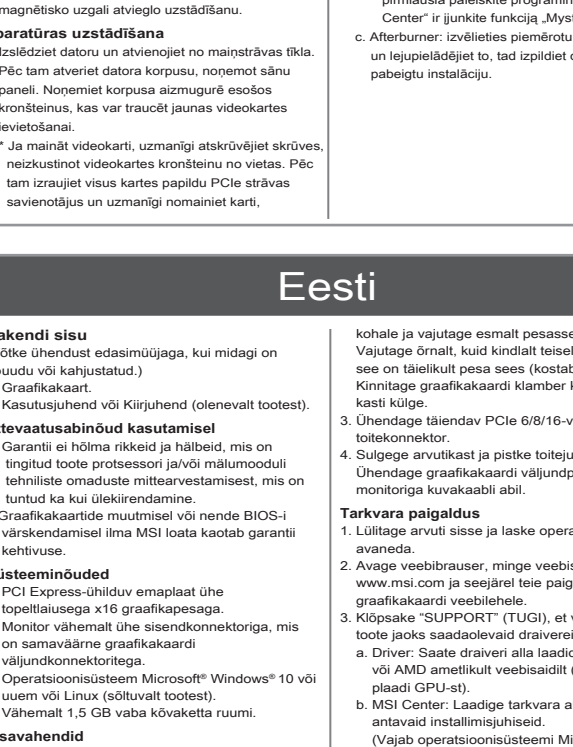

System Requirements

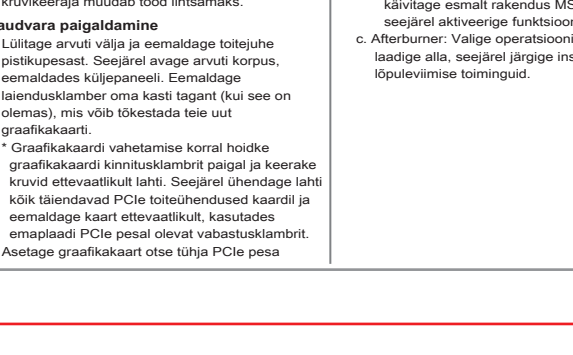

Auxiliary Tools



MSI Afterburner is the world's most recognized and widely used graphics card overclocking utility. For more information please visit: <http://www.msi.com/page/afterburner>

Optional HDMI

Note that the installation photos shown here are for reference only and may vary from the actual ones.

For more information about MSI Graphics Cards, please visit MSI websites at www.msi.com/Graphics-Cards

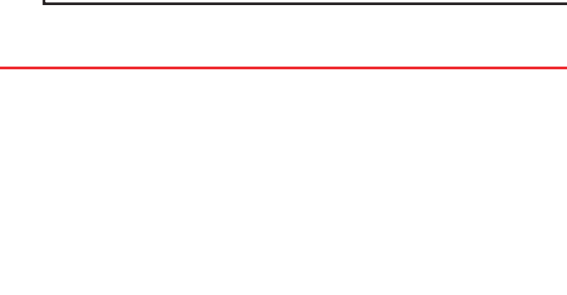

Package Contents

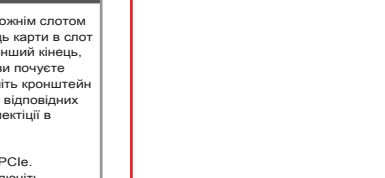

System Requirements

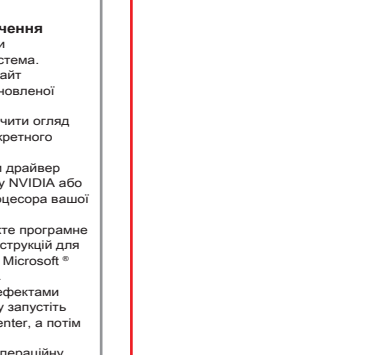

Auxiliary Tools



Hardware Installation

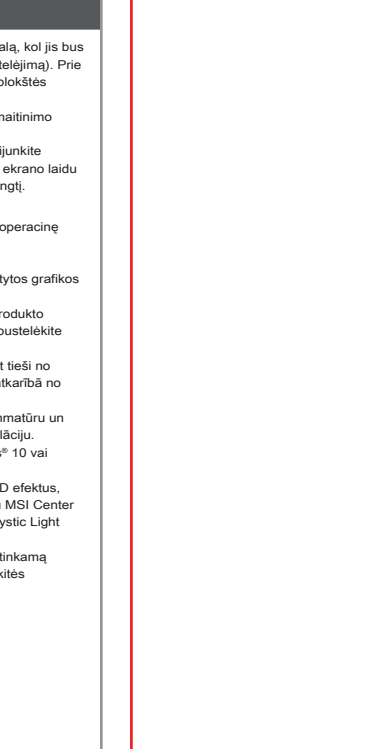

System Requirements

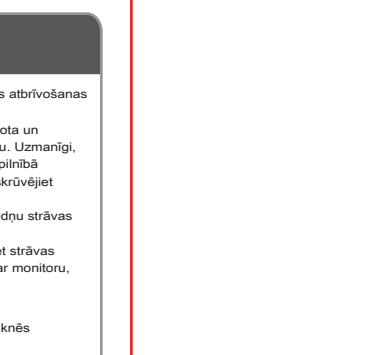

Auxiliary Tools



Hardware Installation

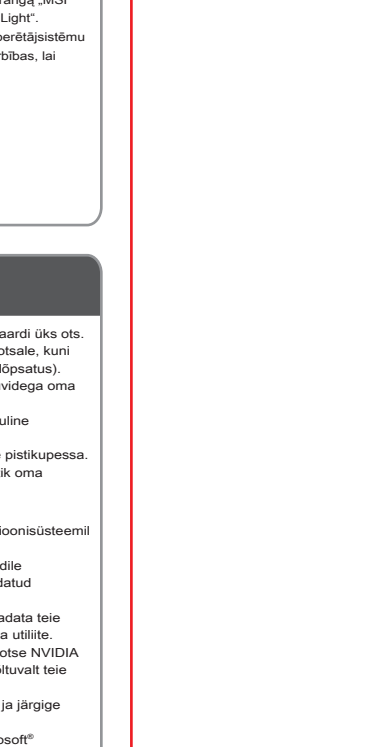

System Requirements

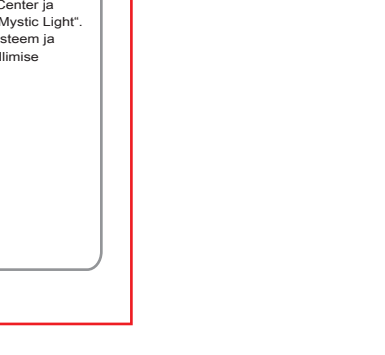

Auxiliary Tools

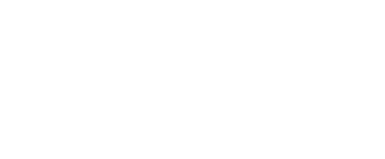

Package Contents

1. Main board
2. Back panel I/O shield
3. SATA-to-USB adapter
4. SATA-to-USB adapter
5. SATA-to-USB adapter

System Requirements

1. Windows 11
2. Windows 11
3. Windows 11

Auxiliary Tools

1. Phillips screwdriver

Hardware Installation

1. Remove the top cover of the PC case.
2. Insert the motherboard into the case, ensuring the front panel connectors are correctly aligned.
3. Connect the SATA-to-USB adapter to the SATA port on the motherboard and the USB port on the case.
4. Secure the motherboard to the case using the provided screws.

Software Installation

1. Insert the Windows 11 installation media into the optical drive.
2. Boot the system and follow the on-screen instructions to install the operating system.
3. After installation, download and install the BIOS update utility from the MSI website.
4. Install the necessary drivers for the motherboard components.

MSI Warranty Procedures and Conditions

This warranty is valid for Australia only. It covers the original purchaser of the product. The warranty is void if the product is used for commercial purposes, modified, or if the purchaser is not the original owner.

Warranty Period: 3 years for labor, 5 years for components.

Exclusions: Damage caused by fire, flood, power surges, or unauthorized modifications.

Procedure: Contact your local MSI distributor for a Return Merchandise Authorization (RMA) form.

Қазақ

Қақпаның мазмұны

1. Негізгі плата
2. Арт жағының қорғаныш қабырғасы
3. SATA-USB адаптері
4. SATA-USB адаптері
5. SATA-USB адаптері

Жүйеге қойылатын талаптар

Windows 11

Hardware Installation

1. Remove the top cover of the PC case.
2. Insert the motherboard into the case, ensuring the front panel connectors are correctly aligned.
3. Connect the SATA-to-USB adapter to the SATA port on the motherboard and the USB port on the case.
4. Secure the motherboard to the case using the provided screws.

Software Installation

1. Insert the Windows 11 installation media into the optical drive.
2. Boot the system and follow the on-screen instructions to install the operating system.
3. After installation, download and install the BIOS update utility from the MSI website.
4. Install the necessary drivers for the motherboard components.

MSI Warranty Procedures and Conditions

This warranty is valid for Australia only. It covers the original purchaser of the product. The warranty is void if the product is used for commercial purposes, modified, or if the purchaser is not the original owner.

Warranty Period: 3 years for labor, 5 years for components.

Exclusions: Damage caused by fire, flood, power surges, or unauthorized modifications.

Procedure: Contact your local MSI distributor for a Return Merchandise Authorization (RMA) form.

Svenska

Förpackningens innehåll

1. Grundplatta
2. Bakplattans I/O-sköld
3. SATA-USB-adapterer
4. SATA-USB-adapterer
5. SATA-USB-adapterer

Systemkrav

Windows 11

Hardware Installation

1. Remove the top cover of the PC case.
2. Insert the motherboard into the case, ensuring the front panel connectors are correctly aligned.
3. Connect the SATA-to-USB adapter to the SATA port on the motherboard and the USB port on the case.
4. Secure the motherboard to the case using the provided screws.

Software Installation

1. Insert the Windows 11 installation media into the optical drive.
2. Boot the system and follow the on-screen instructions to install the operating system.
3. After installation, download and install the BIOS update utility from the MSI website.
4. Install the necessary drivers for the motherboard components.

MSI Warranty Procedures and Conditions

This warranty is valid for Australia only. It covers the original purchaser of the product. The warranty is void if the product is used for commercial purposes, modified, or if the purchaser is not the original owner.

Warranty Period: 3 years for labor, 5 years for components.

Exclusions: Damage caused by fire, flood, power surges, or unauthorized modifications.

Procedure: Contact your local MSI distributor for a Return Merchandise Authorization (RMA) form.

Suomi

Pakkauksen sisältö

1. Peruslevy
2. Takapaneelin I/O-suojat
3. SATA-USB-adapterit
4. SATA-USB-adapterit
5. SATA-USB-adapterit

Systemvaatimukset

Windows 11

Hardware Installation

1. Remove the top cover of the PC case.
2. Insert the motherboard into the case, ensuring the front panel connectors are correctly aligned.
3. Connect the SATA-to-USB adapter to the SATA port on the motherboard and the USB port on the case.
4. Secure the motherboard to the case using the provided screws.

Software Installation

1. Insert the Windows 11 installation media into the optical drive.
2. Boot the system and follow the on-screen instructions to install the operating system.
3. After installation, download and install the BIOS update utility from the MSI website.
4. Install the necessary drivers for the motherboard components.

MSI Warranty Procedures and Conditions

This warranty is valid for Australia only. It covers the original purchaser of the product. The warranty is void if the product is used for commercial purposes, modified, or if the purchaser is not the original owner.

Warranty Period: 3 years for labor, 5 years for components.

Exclusions: Damage caused by fire, flood, power surges, or unauthorized modifications.

Procedure: Contact your local MSI distributor for a Return Merchandise Authorization (RMA) form.

Dansk

Pakkens indhold

1. Grundplade
2. Bagplades I/O-skjold
3. SATA-USB-adapterer
4. SATA-USB-adapterer
5. SATA-USB-adapterer

Systemkrav

Windows 11

Hardware Installation

1. Remove the top cover of the PC case.
2. Insert the motherboard into the case, ensuring the front panel connectors are correctly aligned.
3. Connect the SATA-to-USB adapter to the SATA port on the motherboard and the USB port on the case.
4. Secure the motherboard to the case using the provided screws.

Software Installation

1. Insert the Windows 11 installation media into the optical drive.
2. Boot the system and follow the on-screen instructions to install the operating system.
3. After installation, download and install the BIOS update utility from the MSI website.
4. Install the necessary drivers for the motherboard components.

MSI Warranty Procedures and Conditions

This warranty is valid for Australia only. It covers the original purchaser of the product. The warranty is void if the product is used for commercial purposes, modified, or if the purchaser is not the original owner.

Warranty Period: 3 years for labor, 5 years for components.

Exclusions: Damage caused by fire, flood, power surges, or unauthorized modifications.

Procedure: Contact your local MSI distributor for a Return Merchandise Authorization (RMA) form.

Bosanski

Sadržaj pakovanja

1. Osnovna ploča
2. Zadnja ploča I/O štita
3. SATA-USB adapteri
4. SATA-USB adapteri
5. SATA-USB adapteri

Systemski zahtjevi

Windows 11

Hardware Installation

1. Remove the top cover of the PC case.
2. Insert the motherboard into the case, ensuring the front panel connectors are correctly aligned.
3. Connect the SATA-to-USB adapter to the SATA port on the motherboard and the USB port on the case.
4. Secure the motherboard to the case using the provided screws.

Software Installation

1. Insert the Windows 11 installation media into the optical drive.
2. Boot the system and follow the on-screen instructions to install the operating system.
3. After installation, download and install the BIOS update utility from the MSI website.
4. Install the necessary drivers for the motherboard components.

MSI Warranty Procedures and Conditions

This warranty is valid for Australia only. It covers the original purchaser of the product. The warranty is void if the product is used for commercial purposes, modified, or if the purchaser is not the original owner.

Warranty Period: 3 years for labor, 5 years for components.

Exclusions: Damage caused by fire, flood, power surges, or unauthorized modifications.

Procedure: Contact your local MSI distributor for a Return Merchandise Authorization (RMA) form.